



**IX. RECESS:**

Council will have a brief recess to set the dais.

**V. MINUTES:**

**MINUTES OF THE DECEMBER 11, 2008 REGULAR MEETING [1]**

Council is requested to approve the Minutes of the December 11, 2008 regular meeting of County Council.

**VI. PUBLIC HEARINGS: [11]**

Council will hold public hearing on the following Ordinance:

**ORDINANCE NO. 16-2008/09**

An Ordinance Authorizing The Postponement Of Reassessment For Tax Year 2009 Until Tax Year 2010 And All Other Matters Relating Thereto.

**VII. APPEARANCES:**

**A. BUILDING BRIDGES COMMITTEE [12]**

Gerry Madison, Director Small & Minority Business, Greater Florence Chamber of Commerce, requests that the Building Bridges Committee be allowed to address Council regarding participation in the upcoming six-week Building Bridges session which starts Monday, January 26, 2009 at 4 p.m. at POYNER Adult Center.

**B. J. MIKE KING [15]**

Mr. King requests to appear before Council to discuss the closing of Cain's Landing on the Great Pee Dee River.

**C. SHARON TAYLOR [17]**

Mrs. Taylor requests to appear before Council to thank Council for its hard work on a rezoning issue. (Ordinance No. 07-2008/09)

## **VIII. COMMITTEE REPORTS:**

(Items assigned to the Committees in italics. Revisions by Committee Chair requested.)

### Administration & Finance

(Council members K. G. "Rusty" Smith, Jr./Chair, Russell W. Culberson, Waymon Mumford and James T. Schofield)

### Public Services & County Planning

(Council members James T. Schofield/Chair, Mitchell Kirby, and Ken Ard)

*January 17, 2008*                      *County facilities*  
*Ordinance No. 18-2007/08 (amend the Zoning Ordinance)*

### Justice & Public Safety

(Council members Waymon Mumford/Chair, Johnnie D. Rodgers, Jr. and Al Bradley)

*June 7, 2007*                      *Litter Enforcement*

### Education, Recreation, Health & Welfare

(Council members H. Morris Anderson/Chair, Johnnie D. Rodgers, Jr., and Al Bradley)

*October 16, 2008*                      *Air Quality*

### Agriculture, Forestry, Military Affairs & Intergovernmental Relations

(Council members Russell W. Culberson/Chair, Morris Anderson and Ken Ard)

### Ad Hoc Water Study Committee

(Council members Ken Ard/Chair, Mitchell Kirby, Russell W. Culberson, and Johnnie D. Rodgers, Jr.)

**IX. RESOLUTIONS:**

**A. RESOLUTION NO. 09-2008/09 [19]**

A Resolution Authorizing The Submission Of An Application By Florence County To The South Carolina Department Of Public Safety Justice Assistance Grant (JAG) Program For Video Conferencing Systems To Provide Tools For The Courts At The Complex And Law Enforcement Facilities To Operate More Efficiently And Effectively In Prosecution And To Aid Law Enforcement In Freeing Officers For Prevention And Control Of Violent Crime.

**B. RESOLUTION NO. 10-2008/09 [21]**

A Resolution To Amend The Florence County Personnel Policy Manual To Conform With Recent Mandatory Changes In State And Federal Legislation Pertaining To The Family Medical Leave Act Effective January 16, 2009; To Incorporate A Vehicle Idling Policy Section; And To Address Other Matters Related Thereto.

**X. ORDINANCES IN POSITION:**

**A. THIRD READING**

**1. ORDINANCE NO. 07-2008/09 [27]**

An Ordinance To Rezone Properties Owned By Cynthia T. Matthews And Jerry D. Taylor, Sr., And Sharon M. Taylor Located At 3434, 3435, 3465, 3501 James Turner Road, Effingham And 3 Parcels Located Off State Hwy. 35, Effingham From R-1, Single-Family Residential District To RU-1, Rural Community District, Shown On Florence County Tax Map No. 127, Block 1, Parcels 10, 11, 46, 72, 162, 273 And 274 Consisting Of 131 Acres.

*(Planning Commission approved 8 – 2)(Council District 5)*

**2. ORDINANCE NO. 13-2008/09 [38]**

An Ordinance To Rezone Property Owned By Dorothy Ann Arzu Located At 2951 Whippoorwill Road, Florence From R-1, Single-Family Residential District To R-3, Single-Family Residential District Shown On Florence County Tax Map No. 00127, Block 1, Parcel 275 Consisting Of 1.00 Acre.

*(Planning Commission approved 9 – 0)(Council District 5)*

3. **ORDINANCE NO. 14-2008/09** [49]  
An Ordinance To Rezone Property Owned By Real Estate Asset Management Located At 1133 East Howe Springs Road, Florence From R-1, Single-Family Residential District To B-3, General Commercial District Shown On Florence County Tax Map No. 00180, Block 1, Parcel 202, Consisting Of 2.9 Acres.  
*(Planning Commission approved 9 – 0.)(Council District 7)*

**B. SECOND READING**

1. **ORDINANCE NO. 15-2008/09** [60]  
An Ordinance To Rezone Property Owned By Ivan Hanna Located At 362 North Georgetown Highway, City Of Johnsonville From B-2, Convenience Business District To B-3, General Commercial District Shown On Florence County Tax Map No. 00440, Block 5, Parcel 36 Consisting Of .68 ± Acres.  
*(Planning Commission approved 6 – 0.)(Council District 2)*
2. **ORDINANCE NO. 16-2008/09** [71]  
An Ordinance Authorizing The Postponement Of Reassessment For Tax Year 2009 Until Tax Year 2010 And All Other Matters Relating Thereto.

**C. INTRODUCTION**

1. **ORDINANCE NO. 17-2008/09** [73]  
An Ordinance To Rezone Property Owned By Douglas H. Phillips Located At 3654, 3656, 3658, 3660, 3662 And 3664 South Irby Street, Florence From B-5, Office And Light Industrial District To B-3, General Commercial District Shown On Florence County Tax Map No. 00152, Block 1, Parcel 58 Consisting Of 3.79 Acres.  
*(Planning Commission approved 7 – 0.)(Council District 5)*
2. **ORDINANCE NO. 18-2008/09** [85]  
An Ordinance Amending The Florence County Code To Remove Outdated Sections And Other Matters Relating Thereto.

**XI. APPOINTMENTS TO BOARDS & COMMISSIONS:**

- BOARDS AND COMMISSIONS LIST** [87]  
A list of current and approaching vacancies for 2009 on Boards and Commissions was previously provided to Council.

**XII. REPORTS TO COUNCIL:**

**A. ADMINISTRATION**

1. **MONTHLY FINANCIAL REPORTS** [88]  
Monthly Financial Reports Are Provided To Council For Fiscal Year 2009 Through November 30, 2008 As An Item For The Record.
2. **SOLID WASTE MANAGEMENT PLAN** [93]  
Approve The January 15, 2009 Florence County Solid Waste Management Plan Update To The December 7, 2006 Plan.
3. **CONTRACT AWARD FOR PROFESSIONAL ENGINEERING SERVICES** [96]  
Accept The Proposal For Professional Engineering Services For The Infrastructure Improvements At The Britton-Bostic-Winona Site In Preparation For Industrial Park Certification From Alliance Consulting Engineers In The Amount Of \$75,000 To Be Funded From Progress Energy Carolinas, Inc. Rural Development Act (RDA) Funding; And Authorize The County Administrator To Execute All Associated Documents To Proceed.

**B. EMERGENCY MANAGEMENT**

- RE-BANDING FUNDS SPRINT NEXTEL** [98]  
Accept The Funds From Sprint Nextel In The Amount Of \$1,884.88 To Offset Costs Associated With Re-Banding For The 800 MHz Radio System For The Florence County Emergency Management Department.

**C. FINANCE**

- FISCAL YEAR 2008 AUDIT PRESENTATION** [100]  
Accept The Fiscal Year 2008 Audit As Presented By The Firm Of Baird & Company, CPA's, LLC.

**D. GEOGRAPHICAL INFORMATION SYSTEMS**

- 2009 SC LIGHT DETECTION & RANGING STATEWIDE CONSORTIUM** [101]  
Approve Florence County's Participation In The 2009 South Carolina Light Detection And Ranging (LiDAR) Statewide Consortium Organized To Gather Elevation And Terrain Data Using Remote Sensing During A Flyover Of The County To Be Used For Flood Plain Data, Storm Water Drainage Planning, And Economic Development In The Amount Of \$96,000; And Authorize The County Administrator To Execute All Associated Documents To Proceed.

**E. LIBRARY**

**GRANT AWARD – MARY AC INGRAM CHARITABLE LEAD UNITRUST** [102]  
Accept The Grant From The Mary AC Ingram Charitable Lead Unitrust In The Amount Of \$5,000 To Be Used To Purchase Books For Use In The Florence County Library.

**F. PROBATE COURT**

**GRANT APPLICATION – SC DEPARTMENT OF ARCHIVES & HISTORY** [103]  
Approve The Submission Of The Pre-Grant And Subsequent Grant Application To The South Carolina Department Of Archives & History In The Amount Of \$20,000 (\$10,000 Grant And \$10,000 Match) And Approve Inclusion In The FY2010 Budgetary Process For The Required Match.

**G. PROCUREMENT DEPARTMENT**

1. **AWARD BID #11-08/09** [105]  
Accept Bid #11-08/09 To Construct Olanta And Timmonsville Branch Libraries To FBI Construction Co., Inc. Of Florence, SC In The Amount Of \$2,100,884; Approve The Extension Of The Bid Amount By FBI Construction Co., Inc. In The Amount Of \$1,050,000 For The Construction Of The Johnsonville Branch Library From Grant And State Funds, And Remaining County Library Construction Funds; And Authorize The County Administrator To Execute All Associated Documents, With Contracts Subject To Review By The County Attorney. *(11 Compliant Bids Received)*
  
2. **AWARD BID #13-08/09** [110]  
Accept The Bid Of The Lowest Responsive Bidder, Boggs Paving, Inc. Of Myrtle Beach, South Carolina For The Bellevue Drive And Second Loop Road Turn Lane Widening And Signal Light Addition Project In The Amount Of \$32,991 To Be Funded From Previously Approved Council District 8 Infrastructure Funds; And Authorize The County Administrator To Execute All Associated Documents To Proceed. *(3 Compliant Bids Received)*

3. AWARD BID #14-08/09 [113]  
Accept The Bid Of The Lowest Responsive Bidder, Conder Construction Co., Lugoff, South Carolina For The Storm Drainage Improvements Within Wetlands B, J, And L At The Pee Dee Touchstone Energy Commerce Park In The Amount Of \$96,488.25 To Be Funded From Pee Dee Electric Cooperative RDA Funds; And Authorize The County Administrator To Execute All Associated Documents To Proceed. (16 *Compliant and 1 Non-Compliant Bids Received*)

#### H. TREASURER'S OFFICE

- OCTOBER 6, 2008 TAX SALE [119]  
Information From The October 6, 2008 Tax Sale Regarding Total Parcels Sold And Amount Received Was Provided To Council As An Item For The Record.

### XIII. OTHER BUSINESS:

#### A. INFRASTRUCTURE FUND

1. BROWNTOWN MUSEUM [121]  
Approve The Expenditure Of Funds From Council Districts 1 And 2 Infrastructure Funding Allocations In An Amount Up To \$10,000.00 (\$5,000 From Each District) To The Three Rivers Historical Society To Provide Financial Assistance For Renovations And Restoration Projects At The Browntown Museum.
2. CITY OF LAKE CITY [125]  
Approve The Expenditure Of Funds From Council District 1 Infrastructure Funding Allocation In An Amount Up To \$10,000.00 To Provide Financial Assistance To The City Of Lake City For The Purchase Of An HVAC System For The City Of Lake City's Recreational Facility Located On Calhoun Street.

#### B. ROAD SYSTEM MAINTENANCE FEE (RSMF) FUND

1. BRIARCLIFF DRIVE [128]  
Approve The Expenditure Of Funds From Council District 3 RSMF Funding Allocation In An Amount Up To \$25,000.00 For 1½" Hot Laid Asphalt To Resurface Briarcliff Drive.



2. **CUBIE ROAD** [130]  
Approve The Additional Expenditure Of Funds From Council District 4 RSMF Funding Allocation In An Amount Up To \$11,027.56 For MBC Stone And Crushed Asphalt For Cubie Road And Correct The Scope Of The Project To Be From Stage Coach Road To The Top Of The Hill (Total Project Costs \$28,313.99).

3. **DELOSH ROAD** [132]  
Approve The Expenditure Of Funds From Council District 5 RSMF Funding Allocation In An Amount Up To \$23,472.75 For MBC Stone And Crushed Asphalt For A Portion Of Delosh Road.

**C. UTILITY SYSTEM FUND**

- WILSON ROAD SIDEWALK PROJECT** [134]  
Approve The Expenditure Of Funds From Council District 7 Utility System Funding Allocation In An Amount Up To \$54,108.00 For Additional Pipe To Extend The Contract For Wilson Road Sidewalk Project (TV Road To Oakland Avenue).

**XIV. EXECUTIVE SESSION:**

Pursuant to Section 30-4-70 of the South Carolina Code of Laws 1976, as amended.

- Contractual matter related to a solid waste contract
- Contractual matters relating to real property transactions
- Contractual matters relating to the Museum.
- Legal briefing on litigation matters

**XV. INACTIVE AGENDA:**

**ORDINANCE NO. 34-2007/08 TABLED**

At its regular meeting of June 5, 2008, Council referred this Ordinance to the Committee on Public Service & County Planning, prior to second reading of the Ordinance. **At its regular meeting of December 11, 2008, County Council voted unanimously to table the Ordinance.** An Ordinance To Rezone Property Owned By Sharon M. & Jerry D. Taylor Sr. Located At 3465 James Turner Road, Florence From R-1, Single-Family Residential District To R-3, Single-Family Residential District, Limited Shown On Florence County Tax Map No. 127, Block 1, Parcel 273 Consisting Of 1.56 Acres.

*(Planning Commission denied 8 – 1.) (Council District 5)*

**XVI. ADJOURN:**

# FLORENCE COUNTY COUNCIL MEETING

January 15, 2009

**AGENDA ITEM:** Minutes

**DEPARTMENT:** County Council

**ISSUE UNDER CONSIDERATION:**

Council is requested to approve the minutes of the December 11, 2008 regular meeting of County Council.

**OPTIONS:**

1. Approve minutes as presented.
2. Provide additional directive, should revisions be necessary.

**ATTACHMENTS:**

Copy of proposed Minutes.

**REGULAR MEETING OF THE FLORENCE COUNTY COUNCIL,  
THURSDAY, DECEMBER 11, 2008, 9:00 A.M., LYNCHES RIVER  
COUNTY PARK, 1110 BEN GAUSE ROAD, COWARD, SOUTH  
CAROLINA**

**PRESENT:**

K. G. "Rusty" Smith, Jr., Chairman  
Waymon Mumford, Vice-Chairman  
H. Morris Anderson, Secretary-Chaplain  
Mitchell Kirby, Council Member  
Russell W. Culberson, Council Member  
J. Ken Ard, Council Member  
James T. Schofield, Council Member  
Richard A. Starks, County Administrator  
James C. Rushton, III, County Attorney  
Connie Y. Haselden, Clerk to Council

**ALSO PRESENT:**

Suzanne S. King, Administrative Services Director  
Kevin V. Yokim, Finance Director  
Joe Eason, Parks & Recreation Department Director  
Bonnie K. Andrews, Human Resources Director  
William H. Hoge, Planning & Building Department Director  
Ryon Watkins, EMS Director  
Ray McBride, Library Director  
Sheriff Kenney Boone  
Chuck Tomlinson, Morning News Staff Writer

**ABSENT:**

Johnnie D. Rodgers, Jr., Council Member  
Alphonso Bradley, Council Member

A notice of the regular meeting of the Florence County Council appeared in the December 10, 2008 edition of the MORNING NEWS. Copies of the agenda were faxed to members of the media and posted in the lobby of the City-County Complex, the Doctors Bruce and Lee Foundation Public Library and on the County's website ([www.florenceco.org](http://www.florenceco.org)).

Chairman Smith called the meeting to order. Secretary-Chaplain Anderson gave the invocation and Vice-Chairman Mumford led the Pledge of Allegiance to the American Flag. Chairman Smith welcomed everyone attending the meeting.

**APPROVAL OF MINUTES:**

Councilman Anderson made a motion Council approve the minutes of the November 20, 2008 regular meeting of County Council. Councilman Kirby seconded the motion, which was approved unanimously.

**PUBLIC HEARINGS:**

There were no public hearings required or held.

**APPEARANCES:**

**CHRIS GOSSETT, P.E., PROGRAM MANAGER - SCDOT**

Mr. Gossett, Program Manager, Pee Dee Regional Production Group, South Carolina Department of Transportation, presented information for the Hwy. 76 five-lane widening project Main Street connection. Councilman Kirby made a motion Council proceed with the scope of the project as presented. Councilman Mumford seconded the motion, which was approved unanimously.

**COMMITTEE REPORTS:**

**COMMITTEE ON PUBLIC SERVICES & COUNTY PLANNING**

**ORDINANCE NO. 07-2008/09 – SECOND READING**

Committee Chairman Schofield made a motion, based on the recommendation of the Committee, that Council approve second reading of Ordinance No. 07-2008/09: An Ordinance To Rezone Properties Owned By Cynthia T. Matthews And Jerry D. Taylor, Sr., And Sharon M. Taylor Located At 3434, 3435, 3465, 3501 James Turner Road, Effingham And 3 Parcels Located Off State Hwy. 35, Effingham From R-1, Single-Family Residential District To RU-1, Rural Community District, Shown On Florence County Tax Map No. 127, Block 1, Parcels 10, 11, 46, 72, 162, 273 And 274 Consisting Of 131 Acres.

**ORDINANCE NO. 34-2007/08**

Committee Chairman Schofield made a motion, based on the recommendation of the Committee, that Council table Ordinance No. 34-2007/08: An Ordinance To Rezone Properties Owned By Sharon M. And Jerry D. Taylor, Sr. Located At 3465 James Turner Road, Florence From R-1, Single-Family Residential District To R-3, Single-Family Residential District, Limited Shown On Florence County Tax Map No. 127, Block 1, Parcel 273 Consisting Of 1.56 Acres.

## **RESOLUTIONS:**

### **RESOLUTION NO. 07-2008/09**

The Chairman published the title of Resolution No. 07-2008/09: A Resolution To Establish A Policy Regarding The Surplus Of Vehicles And Motorized County Property And Defining Related Procedures For Disposal. Councilman Anderson made a motion Council approve the Resolution. Councilman Mumford seconded the motion, which was approved unanimously.

### **RESOLUTION NO. 08-2008/09**

The Chairman published the title of Resolution No. 08-2008/09: A Resolution Requesting That The South Carolina General Assembly Continue To Support Recyclers In Recognition Of The Energy And Environmental Benefits Of Recycling To Our County, The State And The Nation. Councilman Mumford made a motion Council approve the Resolution. Councilman Anderson seconded the motion, which was approved unanimously.

## **ORDINANCES IN POSITION:**

### **ORDINANCE NO. 11-2008/09 – THIRD READING**

The Clerk published the title of Ordinance No. 11-2008/09: An Ordinance To Provide For The Issuance And Sale Of A Not Exceeding One Million Five Hundred Thousand Dollar (\$1,500,000) General Obligation Bond Of Florence County, South Carolina (Howe Springs Fire District), Series 2009, To Prescribe The Purposes For Which The Proceeds Of Said Bond Shall Be Expended, To Provide For The Payment Of Said Bond; And Other Matters Relating Thereto. Councilman Culberson made a motion Council approve third reading of the Ordinance. Councilman Anderson seconded the motion, which was approved unanimously.

### **ORDINANCE NO. 12-2008/09 – THIRD READING**

The Clerk published the title of Ordinance No. 12-2008/09: An Ordinance Amending The Florence County Code To Remove Job Descriptions Maintained Officially In Human Resources, And Other Matters Relating Thereto. Councilman Anderson made a motion Council approve third reading of the Ordinance. Councilman Culberson seconded the motion, which was approved unanimously.

### **ORDINANCE NO. 13-2008/09 – SECOND READING**

The Clerk published the title of Ordinance No. 13-2008/09: An Ordinance To Rezone Property Owned By Dorothy Ann Arzu Located At 2951 Whippoorwill Road, Florence From R-1, Single-Family Residential District To R-3, Single-Family Residential District Shown On Florence County Tax Map No. 00127, Block 1, Parcel 275 Consisting Of 1.00 Acre. Councilman Mumford made a motion Council approve second reading of the Ordinance. Councilman Schofield seconded the motion, which was approved unanimously.

**ORDINANCE NO. 14-2008/09 – SECOND READING**

The Clerk published the title of Ordinance No. 14-2008/09: An Ordinance To Rezone Property Owned By Real Estate Asset Management Located At 1133 East Howe Springs Road, Florence From R-1, Single-Family Residential District To B-3, General Commercial District Shown On Florence County Tax Map No. 00180, Block 1, Parcel 202 Consisting Of 2.9 Acres. Councilman Culberson made a motion Council approve second reading of the Ordinance. Councilman Mumford seconded the motion, which was approved unanimously.

**ORDINANCE NO. 15-2008/09 – INTRODUCED**

The Clerk published the title of Ordinance No. 15-2008/09 and the Chairman declared the Ordinance introduced: An Ordinance To Rezone Property Owned By Ivan Hanna Located At 362 North Georgetown Highway, City Of Johnsonville From B-2, Convenience Business District To B-3, General Commercial District Shown On Florence County Tax Map No. 00440, Block 5, Parcel 36 Consisting Of .68 ± Acres.

**ORDINANCE NO. 16-2008/09 – INTRODUCED**

The Clerk published the title of Ordinance No. 16-2008/09 and the Chairman declared the Ordinance introduced: An Ordinance Authorizing The Postponement Of Reassessment For Tax Year 2009 Until Tax Year 2010 And All Other Matters Relating Thereto.

**COUNCILMAN MUMFORD - HOLIDAY**

Councilman Mumford made a motion Council approve a third day at Christmas as a holiday for County employees (Thursday through Friday, December 24 – 26, 2008). Council unanimously seconded and approved the motion.

**APPOINTMENTS TO BOARDS AND COMMISSIONS:**

There were no appointments.

**REPORTS TO COUNCIL:**

**ADMINISTRATION**

**MONTHLY FINANCIAL REPORTS**

Monthly Financial Reports Were Provided To Council For Fiscal Year 2009 Through October 31, 2008 As An Item For The Record.

**SCHEDULE OF MEETINGS**

Councilman Ard made a motion Council Approve The Schedule Of County Council Meeting Dates For 2009, As Well As The Official County Holidays For 2009. Councilman Anderson seconded the motion, which was approved unanimously.

## ECONOMIC DEVELOPMENT PARTNERSHIP

### CONTRACT AUTHORIZATION AND ACCEPTANCE OF RDA FUNDING

Councilman Ard made a motion Council Authorize An Agreement With Progress Energy Carolinas, Inc. To Provide South Carolina Rural Development Act (RDA) Funding In The Amount Of \$100,000 For Infrastructure Improvements For Industrial Park Site Certification At The Britton-Bostic-Winona Site Located On East Old Marion Highway, Florence, And Authorize The County Administrator To Execute All Associated Documents. Councilman Anderson seconded the motion, which was approved unanimously.

### GRANT AWARD SCANA SERVICES, INC.

Councilman Anderson made a motion Council Accept The Grant From SCANA Services, Inc. In The Amount Of \$30,000 To Cover Infrastructure Costs Associated With The Monster Project Under Direction Of Florence County Economic Development Partnership. Councilman Mumford seconded the motion, which was approved unanimously.

## EMERGENCY MANAGEMENT

### GRANT AWARD SC EMERGENCY MANAGEMENT DIVISION

Councilman Schofield made a motion Council Accept A \$7,698 Grant Award From The South Carolina Emergency Management Division (SCEMD) For The Florence County Emergency Management Department To Conduct A HAZMAT Transportation/Commodity Flow Study And Develop, Print, And Distribute The Resulting 2009 County Local Emergency Planning Committee (LEPC) Brochure/Pamphlet. Councilman Anderson seconded the motion, which was approved unanimously.

## LIBRARY

### GRANT AWARD – SOUTH CAROLINA DEPARTMENT OF COMMERCE

Councilman Kirby made a motion Council Accept A Community Enrichment Grant From The Community Development Block Grant Program In The Amount Of \$118,747 To Provide Computer Equipment For The Olanta And Timmonsville Branch Libraries. Councilman Anderson seconded the motion, which was approved unanimously.

## PARKS & RECREATION DEPARTMENT

### EBENEZER PARK

Councilman Anderson made a motion Council approve The Removal Of Overhead Utilities And The Installation Of Underground Lines By Progress Energy At The Intersection Of Pine Needles Road And Old Ebenezer Road (Ebenezer Park) And Approve The Expenditure Of Funds From Council District 9 Utility System Funding Allocations In An Amount Up To \$6,900; And Authorize The County Administrator To Execute All Necessary Agreements And Right-Of-Ways. Councilman Culberson seconded the motion, which was approved unanimously.

**LEASE AGREEMENT – TOWN OF PAMPLICO**

Councilman Ard made a motion Council Approve A Fifteen (15) Year Lease Agreement With The Town Of Pamplico For Property Located At 479 E. Sixth Avenue, TMP #376-01-099, Which Is Adjacent To Laverne Ard Park, For Future Football And Soccer Programs In The Amount Of \$15 (\$1 Per Year); And Authorize The County Administrator To Execute All Documents, Subject To Review By The County Attorney. Councilman Anderson seconded the motion, which was approved unanimously.

**PROCUREMENT DEPARTMENT**

**DECLARATION OF SURPLUS PROPERTY**

Councilman Mumford made a motion Council Declare 31 Vehicles And 1 Tractor As Surplus Property For Disposal Through Public Internet Auction Via GovDeals. Councilman Anderson seconded the motion, which was approved unanimously. (The list included in the December 11, 2008 agenda contained a few incorrect vehicle-model-years; therefore a corrected listing is attached hereto.)

**DONATION OF SURPLUS PROPERTY**

Councilman Kirby made a motion Council Declare Vehicle #1257 A 2001 Chevy Tahoe As Surplus Property And Authorize Donation Of Said Vehicle To The Timmons ville Rescue Squad. Councilman Mumford seconded the motion, which was approved unanimously.

**DONATION OF SURPLUS PROPERTY**

Councilman Anderson made a motion Council Declare Vehicle #941 a 2005 Crown Vic As Surplus Property And Authorize Donation Of Said Vehicle To The West Florence Fire Department. Councilman Culberson seconded the motion, which was approved unanimously.

**DONATION OF SURPLUS PROPERTY**

Councilman Culberson made a motion Council Declare Vehicle #874 a 2003 Crown Vic And Vehicle #942 a 2005 Crown Vic As Surplus Property And Authorize Donation Of Said Vehicle To The Windy Hill Fire Department. Councilman Anderson seconded the motion, which was approved unanimously.

**OTHER BUSINESS:**

**UTILITY SYSTEM FUND**

**PROSPECT FIELD WELL**

Councilman Ard made a motion Council Approve The Expenditure Of Funds From Council District 2 Utility System Funding Allocations In An Amount Up To \$8,800.00 To Provide Financial Assistance With The Drilling Of A 4" Well At Prospect Field. Councilman Schofield seconded the motion, which was approved unanimously.



Councilman Kirby requested the following items be added to the agenda for consideration.

**ROAD SYSTEM MAINTENANCE FEE (RSMF) FUND**

**HAM ROAD**

Councilman Kirby made a motion Council Approve The Expenditure Of Funds From Council District 4 RSMF Funding Allocation In An Amount Up To \$31,294.91 For MBC Stone And Crushed Asphalt For Ham Road. Councilman Culberson seconded the motion, which was approved unanimously.

**CUBIE ROAD**

Councilman Kirby made a motion Council Approve The Expenditure Of Funds From Council District 4 RSMF Funding Allocation In An Amount Up To \$17,286.43 For MBC Stone And Crushed Asphalt For A Portion Of Cubie Road From Top Of Hill To Clearbrook Road. Councilman Culberson seconded the motion, which was approved unanimously.

**UTILITY SYSTEM FUND:**

**BAPTIST DRIVE PROJECT**

Councilman Kirby made a motion Council Approve The Expenditure Of Funds From Council District 4 Utility System Funding Allocation For Approximately \$10,000.00 For The Baptist Drive Project. Councilman Mumford seconded the motion, which was approved unanimously.

**RECESS:**

Council Recessed at 9:31 a.m. Council reconvened at 10:33 a.m.

**EMPLOYEE RECOGNITION:**

Council recognized County Employees who completed from five to thirty years of service with the County as of December 31, 2008 and one employee that retired with thirty-two years of service as of June 30, 2008.

There being no further business to come before Council, Councilman Mumford made a motion to adjourn. Councilman Anderson seconded the motion, which was approved unanimously.

**COUNCIL MEETING ADJOURNED AT 11:00 A.M.**

---

H. MORRIS ANDERSON  
SECRETARY-CHAPLAIN

---

CONNIE Y. HASELDEN  
CLERK TO COUNTY COUNCIL

DRAFT

CORRECTED

<u>UNIT</u>	<u>MAKE</u>	<u>MODEL</u>	<u>YEAR</u>	<u>CORRECT YEAR</u>	<u>MILEAGE</u>	<u>COMMENTS</u>
1	V0501	Chevy	S-10	1999	24,205	1GCC51440TK187022
2	V0502	Chevy	S-10	1999	25,664	1GCC51440TK187047
3	V0750	John Deere	Model 5510	1999	1519 hours	LV5510S153020
4	V0757	Ford	Crown Vic	2004	142,266	2FAFP71W55X106329
5	V0758	Ford	Crown Vic	2004	141,157	2FAFP71W75X106333
6	V0760	Ford	Crown Vic	2004	119,060	2FAFP71W05X106335
7	V0762	Ford	Crown Vic	2004	119,258	2FAFP71W45X106340
8	V0763	Ford	Crown Vic	2004	137,312	2FAFP71W85X106342
9	V0770	Ford	Crown Vic	2004	141,741	2FAFP71W35X106331
10	V0772	Ford	Crown Vic	2004	145,632	2FAFP71W25X106336
11	V0774	Ford	Crown Vic	2004	140,812	2FAFP71W65X106341
12	V0779	Chevy	Tahoe	2004	75,697	1GNEC13Z25R142499
13	V0794	Nissan	Titan	2004	107,609	1N6BA07A85N520460
14	V0826	Ford	Crown Vic	2002	139,364	2FAFP71W73X142228
15	V0827	Ford	Crown Vic	2002	155,593	2FAFP71WX3X142241
16	V0828	Ford	Crown Vic	2002	144,780	2FAFP71W03X142250
17	V0837	Ford	Crown Vic	2002	154,464	2FAFP71W83X142237
18	V0843	Ford	Crown Vic	2002	151,238	2FAFP71W43X142235
19	V0852	Dodge	Ram 2500	2003	102,700	1D7KU28D33J628834
20	V0853	Dodge	Ram	2003	82,856	1D7KU28D53J628835
21	V0861	Ford	Crown Vic	2003	154,298	2FAHP71W73X186173
22	V0868	Ford	Crown Vic	2003	128,114	2FAHP71W33X186171
23	V0870	Ford	Crown Vic	2003	107,566	2FAF71W93X202185
24	V0895	Ford	F-150	2004	104,834	2FTRF17W94CA82802
25	V0936	Ford	Crown Vic	2005	108,107	2FAFP71W85X167447
26	V0939	Ford	Crown Vic	2005	121,777	2FAFP71W25X167444
27	V0944	Ford	Crown Vic	2005	132,749	2FAFP71W95X167439
28	V0948	Ford	Crown Vic	2005	123,072	2FAFP71W05X143742
29	V1233	Ford	Crown Vic	2001	112,753	2FAFP71W21X137578
30	V1282	Ford	Crown Vic	2001	122,720	2FAFP71W51X192235
31	V0866	Ford	Crown Vic	2003	138,247	2FAHP71W93X186174
32	V0829	Ford	Crown Vic	2002	135,712	2FAFP71W43X142347

Correct Year= Original surplus list contained model year from door. Correct model year indicated in next column.

# FLORENCE COUNTY COUNCIL MEETING

January 15, 2009

**AGENDA ITEM:** Public Hearings

**DEPARTMENT:** County Council

**ISSUE UNDER CONSIDERATION:**

Council will hold public hearing to receive public comment with regard to the following:

**ORDINANCE NO. 16-2008/09**

An Ordinance Authorizing The Postponement Of Reassessment For Tax Year 2009 Until Tax Year 2010 And All Other Matters Relating Thereto.

# FLORENCE COUNTY COUNCIL MEETING

January 15, 2009

**AGENDA ITEM:** Appearances Before Council  
Gerry Madison  
Building Bridges Committee

**DEPARTMENT:** Administration

**ISSUE UNDER CONSIDERATION:**

Gerry Madison, Director, Small & Minority Business, Greater Florence Chamber of Commerce, requests that the Building Bridges Committee be allowed to address Council regarding participation in the upcoming six-week Building Bridges session which starts Monday, January 26, 2009 at 4 p.m. at Poynor Adult Center.

**ATTACHMENT:**

1. Copy of the Request to Appear Received Via Email From Ms. Madison.
2. Registration Form for Building Bridges.

**Connie Haselden**

---

**From:** Gerry Madison [gmadison@flochamber.com]  
**Sent:** Monday, December 22, 2008 11:10 AM  
**To:** Connie Haselden  
**Subject:** County Meeting  
**Attachments:** Registration Form.doc

I am writing to request that the Building Bridges committee speak to Florence County about their participation in our upcoming six-week Building Bridges session which starts Monday, January 26 @ 4-6 p.m. at Poyner Adult Center (registration form attached).

Thanking you in advance for your consideration of this request.

Gerry S. Madison, Director  
Small & Minority Business  
Greater Florence Chamber of Commerce  
610 W. Palmetto Street  
POB 948  
Florence, SC 29503  
(843) 665-0515 (work)  
(843) 662-2010 (fax)  
Email: gmadison@flochamber.com



**Greater Florence**  
**CHAMBER OF**  
**COMMERCE**

2009

**BUILDING BRIDGES REGISTRATION FORM**

Dates: Mondays, January 26 – March 9, 2009  
 Place: Poynor Adult Center – 319 S. Dargan Street  
 Cost: \$15 (six-week session); \$10 each for five or more

Registration is limited to 125 people. Pre-registration helps our efforts in opening the first session on time. Please return this form with your payment. For more information, call the Chamber at 843.665.0515.

(Please Print)

Name: \_\_\_\_\_  
 City: \_\_\_\_\_ State: \_\_\_\_\_ Zip Code: \_\_\_\_\_  
 Daytime Phone: \_\_\_\_\_ Fax: \_\_\_\_\_  
 Email: \_\_\_\_\_

To ensure diversity in the composition of small groups, please complete the following:

Gender:  Male  Female Race: \_\_\_\_\_  
 (Optional)  
 Age Group:  Under 34  35-49  50-64  65  
 Religious affiliation, if any: \_\_\_\_\_  
 (Optional)  
 Occupation: \_\_\_\_\_

**Fee Schedule**

Building Bridges Seminar - \$15 \$ \_\_\_\_\_  
 Group of 5 (\$10 each) \$ \_\_\_\_\_  
 Check enclosed  Bill my credit card  \$ \_\_\_\_\_

Visa  MasterCard  American Express  Discover

Credit Card #: \_\_\_\_\_

Expiration Date: \_\_\_\_\_ Verification Code (on back of card) \_\_\_\_\_

Print Name: \_\_\_\_\_

Authorized Signature: \_\_\_\_\_ Date: \_\_\_\_\_

**Mail this form along with payment to:**  
**Building Bridges**  
**Greater Florence Chamber of Commerce**  
**POB 948, Florence SC 29503-0948**  
**Phone: 843.665.0515 Fax: 843.662-2010**

**REGISTRATION EADLINE: Friday, January 16<sup>th</sup>**

# FLORENCE COUNTY COUNCIL MEETING

January 15, 2009

**AGENDA ITEM:** Appearances Before Council  
J. Mike King

**DEPARTMENT:** Administration

**ISSUE UNDER CONSIDERATION:**

Mr. King requests to appear before Council to discuss the closing of Cain's Landing on the Great Pee Dee River.

**ATTACHMENT:**

Copy of the Request to Appear Received From Mr. King.



Dear Ms. Haselden,

This is my request to please have an audience at the county council meeting on January 15. It is about, as I have bothered your office incessantly with, the closing of Cain's Landing on The Great Pee Dee River. I will make my address very short, not longer than ten minutes. Thank you and Mr. Stark for your consideration and courtesy in our conversations

*J. Mike King*  
J. Mike King  
1272 E. Seven Mile Rd.  
Pamplico, S.C. 29583  
493-0816  
12/30/08

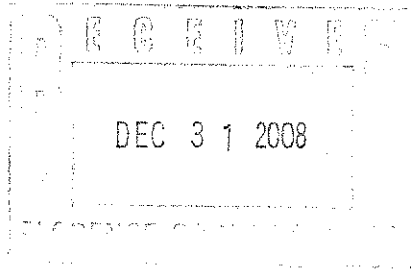

# FLORENCE COUNTY COUNCIL MEETING

January 15, 2009

**AGENDA ITEM:** Appearances Before Council  
Sharon Taylor

**DEPARTMENT:** Administration

**ISSUE UNDER CONSIDERATION:**

Mrs. Taylor requests to appear before Council to thank Council for its hard work on a rezoning issue. (Ordinance No. 07-2008/09).

**ATTACHMENT:**

Copy of the Request to Appear Received Via Email From Mrs. Taylor.

**Connie Haselden**

---

**From:** Sharon [jsfarm2@aol.com]  
**Sent:** Wednesday, December 17, 2008 3:29 PM  
**To:** Connie Haselden  
**Subject:** Appearance on the January 15, 2009 County Concil Agenda

**Connie,**  
**Our family received the letter from Mr. Hoge regarding the rezoning request.**  
**Please add my name for appearance on the 1/15/09 agenda on PC#2008-52.**  
**Our family would like to thank you and council for your hard work on our rezoning issue.**  
**Hope you and your family a happy, safe, and restful holiday.**  
**Thank you again.**  
**Sharon**

---

Listen to 350+ music, sports, & news radio stations – including songs for the holidays – FREE while you browse.  
[Start Listening Now!](#)

# FLORENCE COUNTY COUNCIL MEETING

Item For Meeting on: January 15, 2009

**AGENDA ITEM:** Resolution No. 09-2008/09

**DEPARTMENT:** Administration

## **ISSUE UNDER CONSIDERATION:**

A Resolution Authorizing the Submission of an Application by Florence County to the South Carolina Department of Public Safety Justice Assistance Grant (JAG) Program for Video Conferencing Systems to provide tools for the courts at the Complex and Law Enforcement facilities to operate more efficiently and effectively in prosecution and to aid law enforcement in freeing officers for prevention and control of violent crime.

## **POINTS TO CONSIDER:**

1. The JAG grant funds will be used to provide video conferencing systems for the courts at the Complex and Law Enforcement facilities.
2. The total project is estimated to cost \$203,405.
3. The grant requires a 25% cash match which will be funded in the FY09 IT department budget.
4. The improvements will allow information sharing, virtual elimination of case backlog due to scheduling delays, resolve several courtroom security issues and eliminate various hindrance to prosecution.
5. Annual maintenance costs of \$20,200 will be absorbed in the IT general fund budget.

## **OPTIONS:**

1. ***(Recommended)*** Approval of Resolution No. 09-2008/09.
2. Provide an Alternate Directive.

## **ATTACHMENTS:**

Proposed Resolution No. 09-2008/09

Sponsor(s)/Department : County Council  
Adopted: : January 15, 2009  
Committee Referral : N/A  
Committee Consideration Date : N/A  
Committee Recommendation : N/A

## COUNCIL-ADMINISTRATOR FORM OF GOVERNMENT FOR FLORENCE COUNTY

### RESOLUTION NO. 09-2008/09

**(Authorizing Submission Of An Application By Florence County To The State Of South Carolina Department of Public Safety Justice Assistance Grant (JAG) For 2009 For Video Conferencing Systems at the Complex and Law Enforcement Facilities.)**

#### WHEREAS:

1. The State of South Carolina is authorized to make JAG Grants to local governments with identified justice programs needs/priorities in their community; and
2. The courts and law enforcement of Florence County have identified such needs and priorities and will submit an application for JAG grant funds in 2009 for video conferencing systems at the Complex and Law Enforcement facilities; and
3. The need identified is for video conferencing to aid in achieving courtroom efficiency, to make available criminal justice information systems and to assist law enforcement; and
4. The total project cost is estimated to be \$203,405.

#### NOW THEREFORE BE IT RESOLVED BY THE FLORENCE COUNTY COUNCIL DULY ASSEMBLED THAT:

1. Florence County will submit an application for a Justice Assistance Grant in the amount of \$203,405 to provide for the purchase and installation of video conferencing equipment at the Complex and Law Enforcement facilities in an effort to further the County's initiatives to increase courtroom efficiency, to provide a tool to aid in prosecution of violent crime and aid in assisting law enforcement in the prevention and control of violent crime.
2. The County will provide a 25% match which is funded in the FY09 IT department budget.
3. The County Administrator is authorized to execute documents in conjunction with said application and to submit any and all necessary information in accordance with normal policy.
4. This Resolution shall be in full force and effect from and after its adoption.

ATTEST:

SIGNED:

\_\_\_\_\_  
Connie Y. Haselden, Council Clerk

\_\_\_\_\_  
K. G. Rusty Smith, Jr., Chairman

COUNCIL VOTE:

OPPOSED:

ABSENT:

# FLORENCE COUNTY COUNCIL MEETING

January 15, 2009

**AGENDA ITEM:** Resolution No. 10-2008/09

**DEPARTMENT:** Human Resources/Risk Management

## **ISSUE UNDER CONSIDERATION:**

(Amend The Florence County Personnel Policy Manual To Conform With Recent Mandatory Changes In State And Federal Legislation Pertaining To The Family Medical Leave Act Effective January 16, 2009; To Incorporate A Vehicle Idling Policy Section; And To Address Other Matters Related Thereto.)

## **OPTIONS:**

1. *(Recommended)* Approve Resolution No. 10-2008/09
2. Provide an alternate directive.

## **ATTACHMENTS:**

Resolution No. 10-2008/09

Sponsor(s)/Department : County Council  
Adopted: : January 15, 2009  
Committee Referral : N/A  
Committee Consideration Date : N/A  
Committee Recommendation : N/A

**RESOLUTION NO. 10-2008/09**

**COUNCIL-ADMINISTRATOR FORM OF GOVERNMENT FOR FLORENCE COUNTY**

**(Amend The Florence County Personnel Policy Manual To Conform With Recent Mandatory Changes In State And Federal Legislation Pertaining To The Family Medical Leave Act Effective January 16, 2009; To Incorporate A Vehicle Idling Policy Section; And To Address Other Matters Related Thereto.)**

**WHEREAS:**

1. The County has determined a need to establish a Vehicle Idle-Reduction Requirements Policy to reduce idling times of County vehicles to help reduce polluting emissions and to increase fuel efficiency; and
2. The County is required to amend its Family and Medical Leave Act (FMLA) Policy to comply with the federal regulations including the addition of FMLA leave for families of service members. The revised federal regulations take effect on January 16, 2009; and
3. The County is required to amend its Worker Compensation Program Policy for employees that sustain a work-related injury or illness including policies on fitness for duty certifications and light duty assignments.

**NOW THEREFORE BE IT RESOLVED BY THE FLORENCE COUNTY COUNCIL DULY ASSEMBLED THAT:**

- I. The Florence County Personnel Policy Manual, Section 4.10, Vehicle Policy, is hereby amended to add the following new section:
  - 4.10B(3) Vehicle Idle-Reduction Requirements:**
    - 4.10B(3)(a)** County employees, while waiting/stopped at any destination, are to turn off their vehicles as soon as possible to eliminate idling, reduce harmful emissions, and reduce potential carbon monoxide poisoning.
    - 4.10B(3)(b)** County vehicles are not to be started until ready to depart. Exceptions include conditions that would compromise passenger safety, such as extreme weather or when the engine is required to power needed auxiliary equipment.
    - 4.10B(3)(c)** Engines of all ambulance vehicles are to be turned off while waiting at hospitals and at any pick-up and drop-off sites.
    - 4.10B(3)(d)** County employees are to reduce idling in daily driving avoiding idling at drive-through services, parks and other places.

- II. Florence County Personnel Policy Manual, Section 11.12C, Reason for Leave of Absence, is amended to read as follows:

**11.12C Reasons for Leave**

**11.12C(1) Regular FMLA Leave:** An eligible employee will be granted a leave of absence under the FMLA when: (1) a serious health condition, including disability resulting from an on-the-job injury (a Worker's Compensation injury/illness), prevents the employee from being able to perform his job; (2) the employee's spouse, child, or parent has a serious health condition and the employee must be absent from work in order to care for that relative; or (3) an employee must be absent from work in order to care for a natural child, adopted child, or formally placed foster child, provided that entitlement to leave to care for a child who is newly born or newly received in the employee's household ends twelve (12) months after a natural child is born or twelve (12) months after an adopted or foster child is received in the employee's household. **Proof of need for leave of absence must be submitted to Human Resources within fifteen (15) days of application for any FMLA leave.**

**11.12C(2) Military Caregiver Leave:** An eligible employee who is the spouse, parent, child, or next of kin (designated in writing) of a current member of the armed forces, including the National Guard or Reserves, who has a serious injury or illness incurred in the line of duty will be granted up to 26 weeks of FMLA leave in a twelve (12) month period, if the service member is undergoing medical treatment, recuperation, or therapy, or is in outpatient status, or has an applicable designation on the federal temporary disability retired list. **Employees requesting FMLA Leave for a service member must provide proof of the qualifying family member's next of kin status and federal active military service to Human Resources before leave is granted. Proof of need for leave of absence must be submitted to Human Resources within fifteen (15) days of application for any FMLA Leave.**

**11.12C(3) Qualifying Military Exigency Leave:** An eligible employee who is the spouse, parent, child, or next of kin (designated in writing) of a current member of the armed forces, including the National Guard or Reserves, will be granted up to 12 weeks of FMLA leave in a twelve (12) month period for reasons related to or affected by the family member's federal call-up/service or activation by Presidential order. Qualifying exigencies are: (1) Short-notice deployment (notice of 7 calendar days or less); (2) Military events and related activities; (3) Childcare and school activities (regular or routine childcare by the employee does not count); (4) Financial and legal arrangements; (5) Counseling; (6) Rest and recuperation; (7) Post-deployment activities; and (8) Other urgent related events may be eligible if approved by the County Administrator. **Employees requesting FMLA Leave for a service member must provide proof of the qualifying family member's next of kin status and federal call-up/active military service to Human Resources before leave is granted. Proof of need for leave of absence must be submitted to Human Resources within fifteen (15) days of application for any FMLA Leave.**

- III. Florence County Personnel Policy Manual, Section 11.12D, Length of Leave, is hereby amended to read as follows:

**11.12D Length of Leave**

**11.12D(1) Regular FMLA Leave:** An eligible employee can take up to 12 work weeks under this policy during any twelve (12) consecutive months. Leave taken for Qualifying Military Exigency



Leave also counts against the 12 work weeks of Regular FMLA. Leave to care for a newly born or newly received child must be taken consecutively. Leave required because of the employee's own serious health condition or that of a spouse, child, or parent may be taken intermittently or by means of a modified work schedule when necessary. When necessary and available, modified work schedules may be arranged with the Department Head.

**11.12D(2) Military Caregiver Leave:** An eligible employee can take up to 26 work weeks under this policy during a twelve (12) month period. Leave taken for Regular FMLA and Qualifying Military Exigency Leave also count against the 26 weeks of leave permitted to care for an injured service member.

**11.12D(3) Qualifying Military Exigency Leave:** An eligible employee can take up to 12 work weeks under this policy during any twelve (12) month period. Leave taken for Regular FMLA also counts against the 12 work weeks. For short notice deployments up to 7 calendar days of leave may be taken, and leave taken to be with the service member during periods of rest and recuperation (example: military leave or other status determined to be the equivalent) is limited to 5 days per period. Leave taken to attend post-deployment activities must be taken within 90 days of the end of active duty service.

- IV. Florence County Personnel Policy Manual, Section 11.12F(1), Health Benefit Plan, is hereby amended to read as follows:

**11.12F(1) Health Benefit Plan:** Employees taking up to 12 work weeks leave under this policy must continue to pay their portion of health benefit plan premiums on the same date that such portion of premiums would be deducted from the employee's wages. If FMLA leave exceeds twelve (12) work weeks, employees are responsible for full and timely payment of the entire cost of health and dental insurance and responsible for making direct payment of any non-County sponsored, payroll deducted plans, such as optional insurance with independent carriers.

- V. Florence County Personnel Policy Manual, Section 11.12H, Light Duty, is hereby amended in its entirety and replaced with the following language:

**11.12H Fitness for Duty Certification:** Employees returning from FMLA leave for their own disability must provide a Fitness for Duty (FFD) certification signed by his treating physician. Employees who fail to provide FFD certification will be prohibited from returning to work until it is provided. FFD certifications may be required when an employee returns from intermittent FMLA leave if serious concerns exist regarding the employee's ability to resume his duties safely.

- VI. Florence County Personnel Policy Manual, Section 11.12J, Reinstatement, is hereby amended to read as follows:

**11.12J Reinstatement:** At or before the conclusion of the FMLA leave of absence (excluding Pre-COBRA Leave), the employee is entitled to reinstatement to his former position or to a position equivalent to his former position. The employee must demonstrate that he is fit for duty, providing FFD certification, and give reasonable notice of intent to return to work.

- VII. Florence County Personnel Policy Manual, Section 11.12K(1), Pre-COBRA 14-Week Benefit Period, is hereby amended to read as follows:

**11.12K(1)** An employee who is unable to perform the duties of his position due to his own disability and who has exhausted his entitlement to leave under the Family and Medical Leave

Act by taking twelve (12) weeks of leave and who continues to require leave, which would qualify for FMLA if such leave had not been exhausted, may upon written application, be granted up to an additional fourteen (14) weeks of unpaid leave of absence ~~with approval of the Human Resources Director.~~ This additional leave of absence does not entitle the employee to reinstatement to his former position or an equivalent one nor to payment of any portion of his health benefit plan premiums. The employee will be removed from the payroll and carried in a terminal leave status for the additional fourteen (14) weeks on the County's health and dental insurance policies. The employee will be responsible for full and timely payment of the entire cost of this insurance and responsible for making direct payment of any non-County sponsored, payroll deducted plans, such as optional insurance with independent carriers. Failure to make payments when due results in cancellation of insurance coverage. If the employee is able to return to work prior to ~~or after~~ the exhaustion of his extended leave ~~and provides FFD certification, he may apply and compete for any job posting for which he feels he is qualified.~~

VIII. Florence County Personnel Policy Manual, Section 11.12M(1), Spouses, is hereby amended to read as follows:

**11.12M(1) Spouses:** When both a husband and a wife are employed, their combined right to a leave of absence to care for a child or parent is twelve (12) weeks in a twelve (12) month period. ~~Their combined right to a leave of absence to care for a covered injured or ill service member is 26 weeks in a twelve (12) month period.~~

IX. Florence County Personnel Policy Manual, Section 12.1H, Worker Compensation Program, is hereby amended to read as follows:

#### 12.1H WORKER COMPENSATION PROGRAM

**12.1H(1)** Florence County provides a comprehensive worker compensation insurance program for appropriate employee medical expenses and for partial salary continuation in the event of a work-related injury or illness. The amount of benefits payable and the duration of payment depend on the nature of the injury or illness. Subject to applicable legal requirements, worker compensation insurance provides benefits to employees incapacitated and absent from work in excess of seven (7) days because of a work-related injury or illness.

**12.1H(2)** Employees who sustain a work-related injury or illness are to inform their Department Head immediately. The Department Head is to ensure that each employee involved in the accident reports to a designated physician or medical facility for medical treatment, as well as ensuring the employee drug and alcohol tests are completed immediately. If an employee is unable to report for work within twenty-four (24) hours, his supervisor must contact Risk Management and assist with completing the First Report of Injury (State Form 12-a). No matter how minor an on-the-job injury may appear, it is important that it be reported immediately. This will enable an eligible employee to receive appropriate medical treatment and provide for payment of medical expenses and for partial wage continuation. A Worker Compensation injury is a triggering event for the Family and Medical Leave Act, and any absence as a result of a Worker Compensation injury/illness will run concurrently with the 12-week FMLA entitlement. ~~Temporary transitional work (Light Duty) assignments may be offered for employees who have been restricted by a physician due to a work related injury/illness based on the needs of the County. Light duty assignments are essential duties for which a department would likely have to either hire an employee or pay an employee overtime to perform. Decisions regarding light duty~~

work placement of employees will be made jointly by the Department Head and the Risk Manager, with approval of the Human Resources Director. If granted, light duty is normally limited to 45 days unless otherwise approved by Risk Management and Human Resources.

12.1H(3) When an employee returns to work from an absence caused by a work-related injury or illness, his supervisor must report the return immediately to the Department Head and Risk Management. Employees must provide a Fitness for Duty (FFD) certification signed by the County's physician to the Department Head. Employees who fail to provide FFD certification will be prohibited from returning to work until it is provided; additional actions may apply if the certification is not provided promptly. The Department Head or Risk Manager may require additional FFD certification if serious concerns exist regarding the employee's ability to resume his duties safely.

12.1H(4) Questions regarding worker compensation should be directed to Risk Management.

ATTEST:

\_\_\_\_\_  
Connie Y. Haselden, Council Clerk

SIGNED:

\_\_\_\_\_  
K. G. Rusty Smith, Jr., Chairman

COUNCIL VOTE:

OPPOSED:

ABSENT:

DRAFT

## FLORENCE COUNTY COUNCIL MEETING

Item For Meeting On: Thursday, January 15, 2009

**AGENDA ITEM:** Ordinance No.7-2008/09  
Third Reading

**DEPARTMENT:** Planning and Building Inspections



### **ISSUE UNDER CONSIDERATION:**

[An Ordinance To Rezone Properties Owned By Cynthia T. Matthews And Jerry D. Taylor, Sr. And Sharon M. Taylor Located At 3434, 3435, 3465, 3501 James Turner Road, Effingham And 3 Parcels Located Off State Hwy. 35, Effingham From R-1, Single-Family Residential District To RU-1, Rural Community District, Shown On Florence County Tax Map No. 127, Block 1, Parcels 10,11,46,72,162,273 And 274 Consisting Of 131 Acres.]

### **POINTS TO CONSIDER:**

1. The properties are located in Council District 5.
2. The subject properties are currently being utilized as agriculture/farming/ equine/timber.
3. The properties are currently zoned, R-1, Single-Family Residential District.
4. The applicants wish to rezone the properties to RU-1, Rural Community District.
5. The properties are surrounded by some vacant property and some residentially-developed property.
6. The properties are designated as Rural Resource/Agricultural Areas according to the Comprehensive Plan.
7. This request does comply with the Comprehensive Plan.

### **OPTIONS:**

1. *(Recommended)* Approval Of Ordinance No.7-2008/09 To Rezone Properties Owned By Cynthia T. Matthews And Jerry D. Taylor, Sr. And Sharon M. Taylor Located At 3434, 3435, 3465, 3501 James Turner Road, Effingham And 3 Parcels Located Off State Hwy. 35, Effingham From R-1, Single-Family Residential District To RU-1, Rural Community District Shown On Florence County Tax Map No. 127, Block 1, Parcels 10,11,46,72,162,273 And 274 Consisting Of 131 Acres.  
*(Planning Commission approved 8-2)(Council District5)*
2. Provide An Alternative Directive

### **ATTACHMENTS:**

#### **Copies of the following are attached:**

1. Ordinance No.7-2008/09
2. Staff report for PC#2008-52
3. Vicinity map
4. Location map
5. Comprehensive Land Use Plan map
6. Zoning map
7. Aerial photograph
8. Comprehensive Plan information
9. Zoning Ordinance Information

Sponsor(s) : Planning Commission  
 Planning Commission Consideration : July 22, 2008  
 Planning Commission Public Hearing : July 22, 2008  
 Planning Commission Recommendation : July 22, 2008 [Approved 8-2]  
 First Reading/Introduction : August 21, 2008  
 Committee Referral : August 21, 2008  
 Second Reading : September 18, 2008  
 Third Reading : October 16, 2008  
 Effective Date : Immediately

I, \_\_\_\_\_,  
 Council Clerk, certify that this  
 Ordinance was advertised for  
 Public Hearing on \_\_\_\_\_.

**ORDINANCE NO. 07 -2008/09**

**COUNCIL-ADMINISTRATOR FORM OF GOVERNMENT FOR FLORENCE COUNTY**

[An Ordinance To Rezone Properties Owned By Cynthia T. Matthews And Jerry D. Taylor, Sr. And Sharon M. Taylor Located At 3434, 3435, 3465, 3501 James Turner Road, Effingham And 3 Parcels Located Off State Hwy. 35, Effingham From R-1, Single-Family Residential District To RU-1 Rural Community District Shown On Florence County Tax Map No. 127, Block 1, Parcels 10, 11, 46, 72, 162, 273 And 274 Consisting Of 131 Acres.]

**WHEREAS:**

1. Section 30-291 entitled "Intent" of Chapter 30- Zoning Ordinance of the Florence County Code of Ordinances establishes that Florence County Council must be satisfied that applications for amendments to the Zoning Atlas of Florence County are not injurious from a public health, safety, and general welfare outlook and the effect of the change will not negatively impact the immediate environs or the County generally; and
2. Section 30-297 entitled "Administrative Procedures, Action" of Chapter-30 Zoning Ordinance of the Florence County Code for Florence County republished January 2008, provides a procedure for amending the Official Zoning Map of the County of Florence; and
3. The procedure has been followed by the Florence County Planning Commission at a public hearing on July 22, 2008.

**NOW THEREFORE BE IT ORDAINED BY THE FLORENCE COUNTY COUNCIL DULY ASSEMBLED THAT:**

1. Properties located on James Turner Road and off State Hwy. 35 bearing Tax Map 127, Block 1, Parcels 10, 11, 46, 72, 162, 273 and 274 are hereby rezoned to RU-1, Rural Community District.
2. Provisions in other Florence County ordinances in conflict with this Ordinance are hereby repealed.
3. If any provision of this Ordinance or the application thereof to any person or circumstance is held invalid, the invalidity does not affect other provisions or applications of the Ordinance which can be given effect without the invalid provision or application and to this end, the provisions of this Ordinance are severable.

ATTEST:

SIGNED:

\_\_\_\_\_  
 Connie Y. Haselden, Council Clerk

\_\_\_\_\_  
 K. G. Rusty Smith, Jr., Chairman  
 COUNCIL VOTE:

\_\_\_\_\_  
 Approved as to Form and Content  
 James C. Rushton, III, County Attorney

OPPOSED:  
 ABSENT:

**STAFF REPORT  
TO THE  
FLORENCE COUNTY PLANNING COMMISSION  
JULY 22, 2008  
PC#2008-52  
ORDINANCE NO.7-2008/09**

**Subject:** Rezoning request from R-1, Single-Family Residential District to RU-1, Rural Community District

**Location:** Properties are located at 3434, 3435, 3465, 3501 James Turner Rd. and 3 Parcels located off State Hwy.35.

**Tax Map Number:** 00127, Block 1, Parcels 72,162, 273, 274, 10, 11 and 46

**Council District(s):** 5; County Council

**Owner of Record:** Cynthia T. Matthews and Jerry D. & Sharon M. Taylor Sr.

**Applicant:** Cynthia T. Matthews and Jerry D. & Sharon M. Taylor Sr.

**Land Area:** 131 acres

**Existing Land Use and Zoning:**

The subject properties are currently used as agriculture/farming/equine/timber and zoned R-1, Single Family Residential District in the County of Florence.

**Proposed Land Use and Zoning:**

The applicant wishes to continue the existing uses of the subject properties for agriculture/farming/equine/timber and for future placement of a manufactured home.

**Surrounding Land Use and Zoning:**

**North:** Single-family residential/R-1/ City of Florence

**South:** Vacant/ R-1 /Florence County

**West:** Single-family residential/ R-3 /Florence County  
Single-family residential/RU-1/Florence County

**East:** Single-family residential/ R-1/ Florence County

**Florence County Comprehensive Plan:**

The subject properties are currently designated as Rural Resource/Agricultural Areas as established by the Land Use Element of the Comprehensive Plan. The request does comply with the Comprehensive Plan.

**Staff Analysis:**

**Access and Circulation-** Present access to the properties is by way of James Turner Road and Whippoorwill Road.

**Water and Sewer Availability-** These services are provided by City of Florence Public Works.

Adjacent Waterways/Bodies of Water/Flood Zone- There does not appear to be a waterway/body of water adjacent to the properties. The properties are not in a flood zone.

Background- The subject properties are requesting rezoning to RU-1, Rural Community District.

**Florence County/Municipal Planning Commission Action July 22,2008**

The ten Planning Commission members present approved the rezoning request with the vote of eight in favor to two voting in opposition at the meeting held on July 22, 2008.

**Florence County/Municipal Planning Commission Recommendation:**

The Planning Commission recommends approval of this request by the Florence County Council due to the rezoning being in compliance with the Comprehensive Plan.

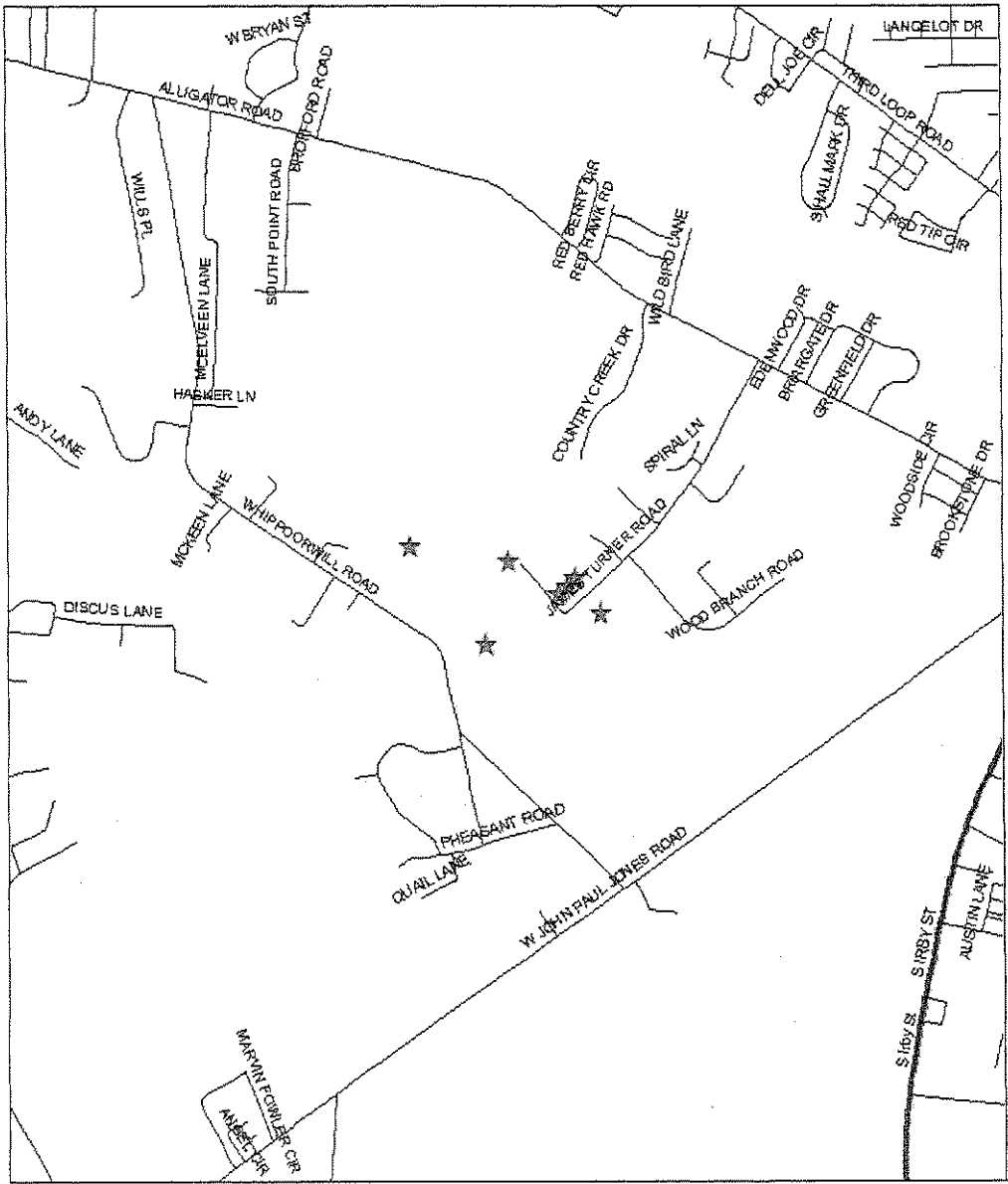

0337.676 1,350 Feet

Map Prepared by: RWE  
 Copyright 2007: Florence County/Municipal Planning  
 & Building Inspections Department  
 Geographic Information Systems  
 2007



**COUNTY COUNCIL DISTRICT(S): 5**  
**PC#2008-52**



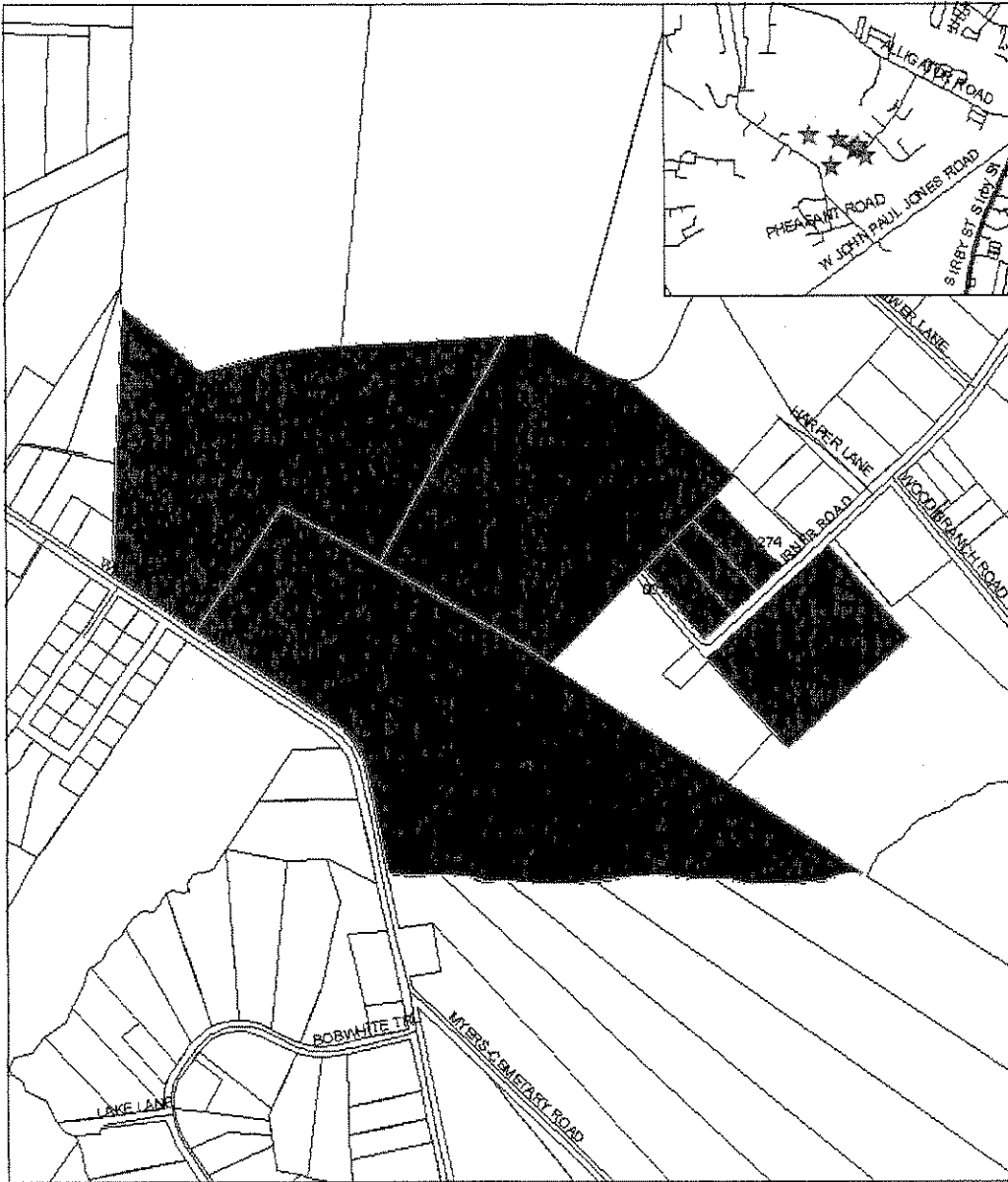

0 400 800 1,600 Feet

N



Map Prepared by: RWE  
 Copyright 2007: Florence County/Municipal Planning  
 & Building Inspections Department  
 Geographic Information Systems  
 2007

COUNTY COUNCIL DISTRICT(S): 5  
 PC#2008-52

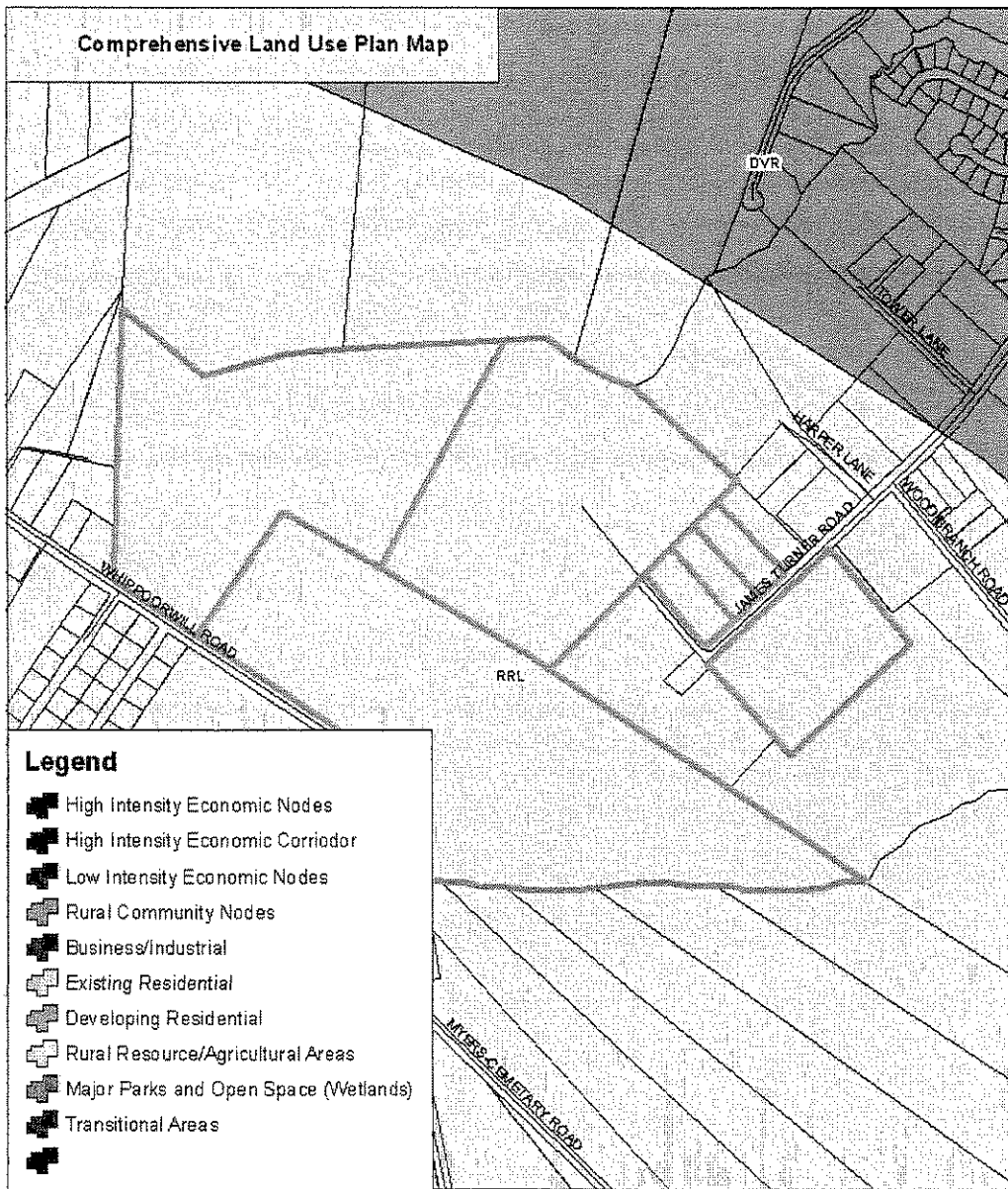

Map Prepared by: RWE  
 Copyright 2007: Florence County Municipal Planning  
 & Building Inspections Department  
 Geographic Information Systems  
 2007

**COUNTY COUNCIL DISTRICT(S): 5**  
**PC#2008-52**

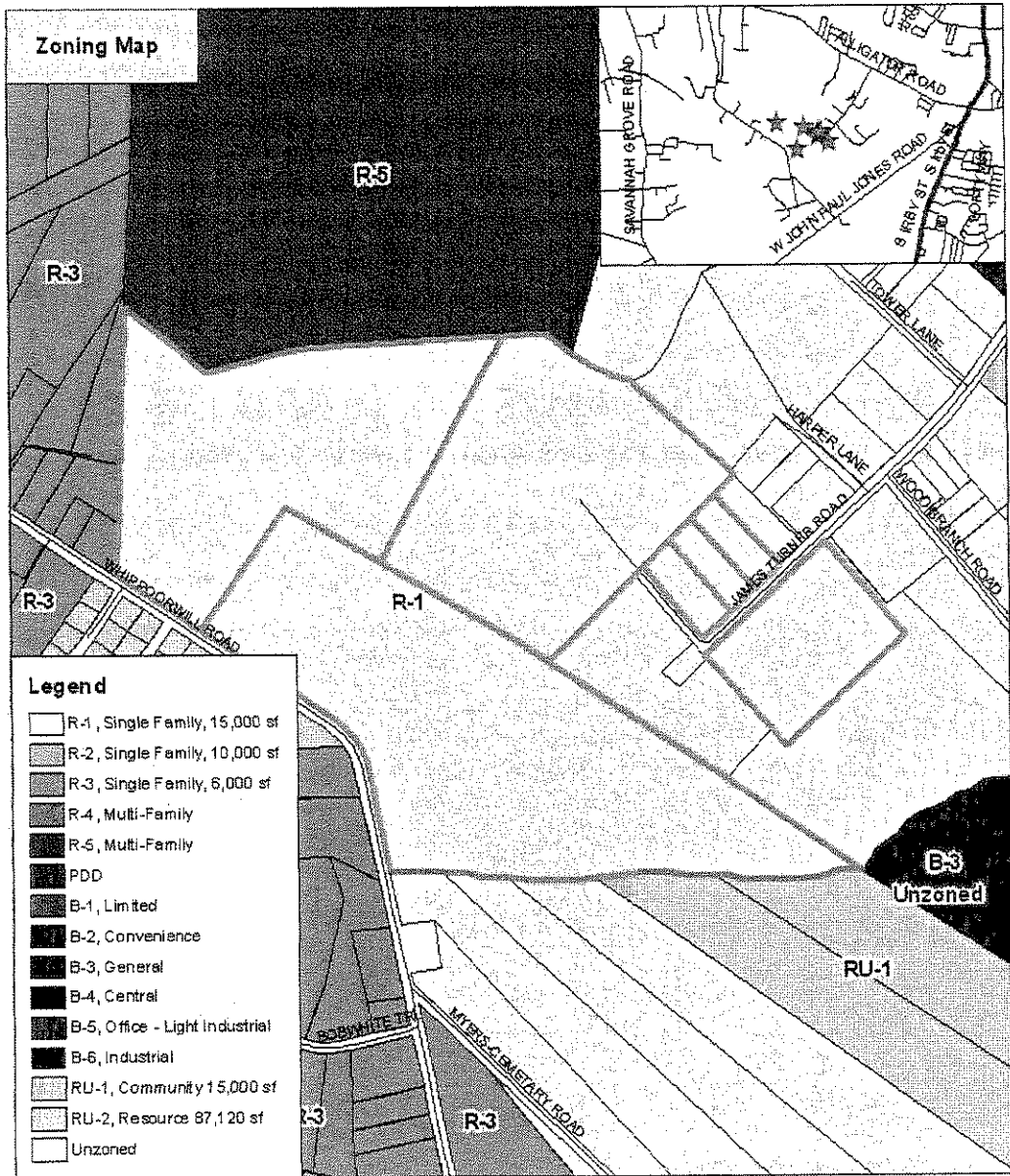

Florence County 2003 Orthophotography Map

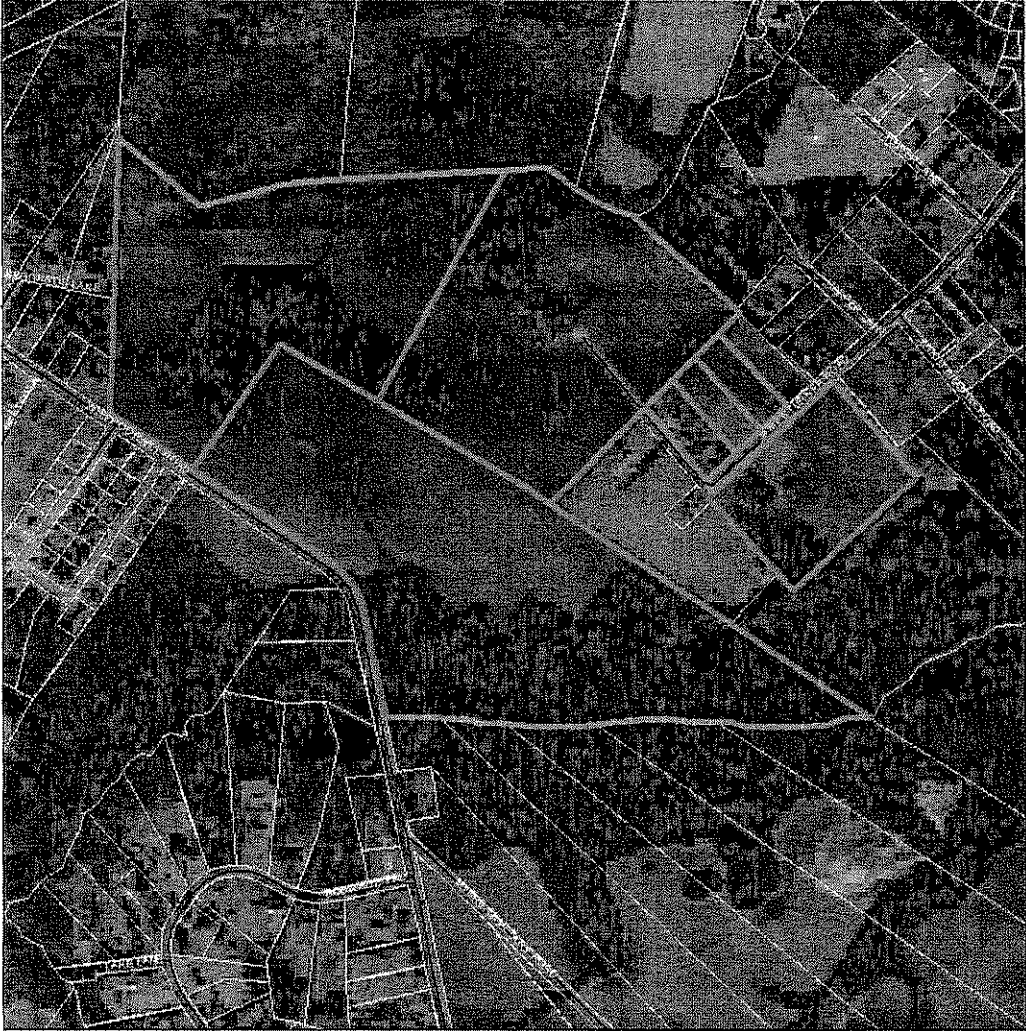

0 325 650 1,300 Feet



Map Prepared by: RWE  
Copyright 2007: Florence County/Municipal Planning  
& Building Inspections Department  
Geographic Information Systems  
2007

COUNTY COUNCIL DISTRICT(S): 5  
PC#2008-52

# Comprehensive Plan Attachment:

## Rural Resource / Agricultural Areas

Most areas shown on the Plan Map generally are outside the path of projected development, characteristically rural and predominately undeveloped or in agricultural use at this time. Moreover, few changes to these areas are anticipated during the life of this Plan, provided urban sprawl is kept in check. The retention of open lands, woodlands, and wetlands which make up a large part of this area, are essential for clean air, water, wildlife, many natural cycles, and a balanced environment among other things. Even more essential from an economic perspective are the agricultural lands and farming operations in this area. These areas also provide a **rural environment** preferred by many people over subdivisions and higher density urban or community settings.

### Objective

The objective of this classification is to conserve rural characteristics and resources, particularly agricultural, and maintain a balanced rural-urban environment.

### Strategy

Strategies designed to implement this objective include:

- ✓ Setting an urban growth boundary which would limit urban intrusions into such areas.
- ✓ Monitoring and mitigating proposed changes which would alter or compromise the rural character of such area.
- ✓ Amending subdivision regulations to encourage cluster development with open space-agricultural land set aside as an alternative to large lot development.
- ✓ Prohibit through zoning high intensity development from the area.

### Plan Compliance Matrix

PLAN MAP OBJECTIVES (Summary)	USE IN ACCORD WITH PLAN MAP OBJECTIVES	USES AT VARIANCE WITH PLAN MAP OBJECTIVES
Conserve rural characteristics and resources and maintain a balanced rural-urban environment	<ul style="list-style-type: none"> <li>❖ Single-family site built and manufactured dwellings</li> <li>❖ Agricultural uses</li> <li>❖ Small scale retail uses</li> <li>❖ Agricultural related industrial uses</li> <li>❖ Institutional uses</li> </ul>	<ul style="list-style-type: none"> <li>❖ High density residential uses</li> <li>❖ Big Box retail</li> <li>❖ Uses generally in conflict with rural values and characteristics</li> </ul>

## **ZONING ORDINANCE ATTACHMENT**

### **RU-1, Rural Community District**

The intent of this district is to sustain and support rural community centers as an integral part of the rural environment, serving the commercial, service, social, and agricultural needs of nearby rural residents.

**FLORENCE COUNTY COUNCIL MEETING**  
**Item For Meeting On: Thursday, January 15, 2009**

**AGENDA ITEM:** Ordinance No.13-2008/09  
Third Reading

**DEPARTMENT:** Planning and Building Inspections



**ISSUE UNDER CONSIDERATION:**

**[An Ordinance To Rezone Property Owned By Dorothy Ann Arzu Located At 2951 Whippoorwill Road, Florence From R-1, Single-Family Residential District To R-3, Single-Family Residential District Shown On Florence County Tax Map No. 00127, Block 1, Parcel 275 Consisting Of 1.00 Acre.]**

**POINTS TO CONSIDER:**

1. The property is located in Council District 5.
2. The subject property currently contains a doublewide manufactured home.
3. The property is currently zoned R-1, Single-Family Residential District.
4. The applicant wishes to rezone the property to R-3, Single-Family Residential District.
5. The property is surrounded by some wooded area, manufactured homes and some residentially-developed property.
6. This property is designated as Rural Resource area according to the Comprehensive Plan.
7. This request does comply with the Comprehensive Plan.

**OPTIONS:**

1. *(Recommended)* Approval Of Ordinance No.13-2008/09 To Rezone Property Owned By Dorothy Ann Arzu Located At 2951 Whippoorwill Road, Florence From R-1, Single-Family Residential District To R-3, Single-Family Residential District Shown On Florence County Tax Map No. 00127, Block 1, Parcel 275 Consisting Of 1.00 Acre.  
*(Planning Commission approved 9-0)(Council District5)*
2. Provide An Alternative Directive

**ATTACHMENTS:**

**Copies of the following are attached:**

1. Ordinance No.13-2008/09
2. Staff report for PC#2008-61
3. Vicinity map
4. Location map
5. Comprehensive Land Use Plan map
6. Zoning map
7. Aerial photograph
8. Comprehensive Plan information
9. Zoning Ordinance information

Sponsor(s) : Planning Commission  
 Planning Commission Consideration : October 28, 2008  
 Planning Commission Public Hearing : October 28, 2008  
 Planning Commission Recommendation : October 28, 2008 [Approved 9-0]  
 First Reading/Introduction : November 20, 2008  
 Committee Referral : N/A  
 Second Reading : December 11, 2008  
 Third Reading : TBA  
 Effective Date : Immediately

I, \_\_\_\_\_,  
 Council Clerk, certify that this  
 Ordinance was advertised for  
 Public Hearing on \_\_\_\_\_.

**ORDINANCE NO. 13-2008/09**

**COUNCIL-ADMINISTRATOR FORM OF GOVERNMENT FOR FLORENCE COUNTY**

[An Ordinance To Rezone Property Owned By Dorothy Ann Arzu Located At 2951 Whipoorwill Road, Florence From R-1, Single-Family Residential District To R-3, Single-Family Residential District Shown On Florence County Tax Map No. 00127, Block 1, Parcel 275 Consisting Of 1.00 Acre.]

**WHEREAS:**

1. Section 30-291 entitled "Intent" of Chapter 30- Zoning Ordinance of the Florence County Code of Ordinances establishes that Florence County Council must be satisfied that applications for amendments to the Zoning Atlas of Florence County are not injurious from a public health, safety, and general welfare outlook and the effect of the change will not negatively impact the immediate environs or the County generally; and
2. Section 30-297 entitled "Administrative Procedures, Action" of Chapter-30 Zoning Ordinance of the Florence County Code for Florence County republished January 2008, provides a procedure for amending the Official Zoning Map of the County of Florence; and
3. The procedure has been followed by the Florence County Planning Commission at a public hearing on October 28, 2008.

**NOW THEREFORE BE IT ORDAINED BY THE FLORENCE COUNTY COUNCIL DULY ASSEMBLED THAT:**

1. Property located on Whipoorwill Road bearing Tax Map 00127, Block 1, Parcel 275, is hereby rezoned to R-3, Single-Family Residential District.
2. Provisions in other Florence County ordinances in conflict with this Ordinance are hereby repealed.
3. If any provision of this Ordinance or the application thereof to any person or circumstance is held invalid, the invalidity does not affect other provisions or applications of the Ordinance which can be given effect without the invalid provision or application and to this end, the provisions of this Ordinance are severable.

ATTEST:

SIGNED:

\_\_\_\_\_  
 Connie Y. Haselden, Council Clerk

\_\_\_\_\_  
 K. G. Rusty Smith, Jr., Chairman

\_\_\_\_\_  
 Approved as to Form and Content  
 James C. Rushton, III, County Attorney

COUNCIL VOTE:  
 OPPOSED:  
 ABSENT:



**STAFF REPORT  
TO THE  
FLORENCE COUNTY PLANNING COMMISSION  
OCTOBER 28, 2008  
PC#2008-61  
ORDINANCE NO. 13-2008/09**

**Subject:** Rezoning request from R-1, Single-Family Residential District to R-3, Single-Family Residential District

**Location:** Property is located at 2951 Whippoorwill Road  
Florence County

**Tax Map Number:** 00127, Block 1, Parcel 275

**Council District(s):** 5; County Council

**Owner of Record:** Dorothy Ann Arzu

**Applicant:** Vernita Hart

**Land Area:** 1 acre

**Existing Land Use and Zoning:**

The property currently contains a doublewide manufactured home and zoned R-1, Single Family Residential District in the County of Florence.

**Proposed Land Use and Zoning:**

The applicant is proposing to rezone the subject property to R-3, Single-Family Residential District for future use of the property for the existing manufactured home.

**Surrounding Land Use and Zoning:**

**North:** Wooded area/R-3/Florence County  
**South:** Wooded area/ R-3/Florence County  
**West:** Single-family residential/R-1/Florence County  
**East:** Manufactured home/R-3/Florence County

**Florence County Comprehensive Plan:**

The subject property is located in a Rural Resource area according to the Comprehensive Plan Land Use Map. This request does comply with the Comprehensive Plan.

**Staff Analysis:**

**Access and Circulation-** Present access to the property is by way of Whippoorwill Road.

**Water and Sewer Availability-** Water services will be provided by City of Florence Public Works.  
No public sewer at this time.

Adjacent Waterways/Bodies of Water/Flood Zone- There does not appear to be a waterway/body of water adjacent to the property. The property is not in a flood zone.

Background- The subject property is requesting rezoning to R-3, Single-Family Residential District.

**Florence County Planning Commission Action: October 28, 2008**

The nine Planning Commission members present approved the zoning request unanimously at the meeting held on October 28, 2008.

**Florence County Planning Commission Recommendation:**

The Planning Commission recommends approval of this request by the Florence County Council due to the rezoning being in compliance with the Comprehensive Plan.



0 850, 300 2,600 Feet

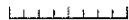

Map Prepared by: RWE  
 Copyright 2007: Florence County/Municipal Planning  
 & Building Inspections Department  
 Geographic Information Systems  
 2007



**COUNTY COUNCIL DISTRICT(S): 5**  
**PC#2008-61**



0 125 250 500 Feet

N



Map Prepared by: RWE  
Copyright 2007: Florence County/Municipal Planning  
& Building Inspections Department  
Geographic Information Systems  
2007

COUNTY COUNCIL DISTRICT(S): 5  
PC#2008-61

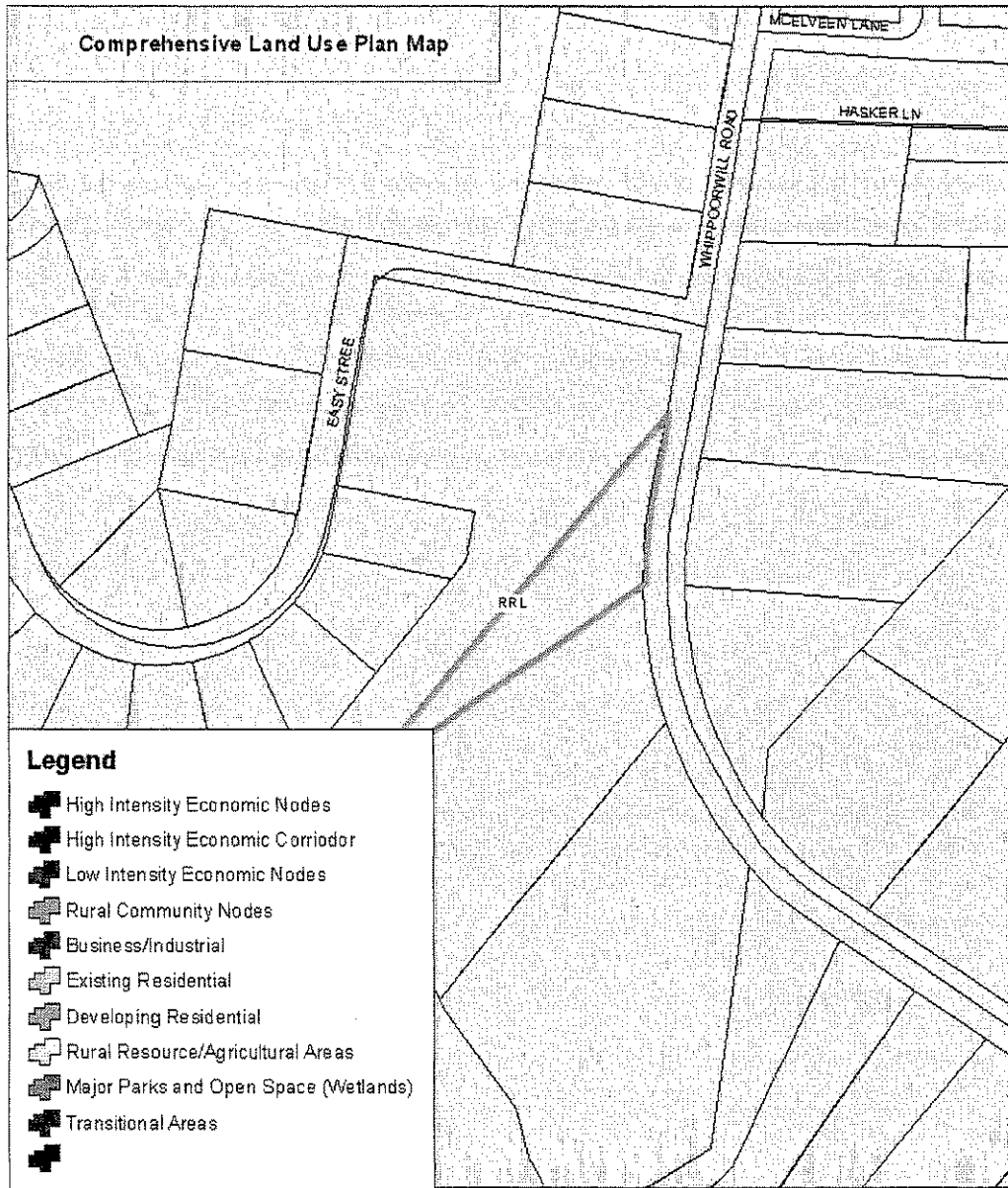

Map Prepared by: RWE  
 Copyright 2007: Florence County/Municipal Planning  
 & Building Inspections Department  
 Geographic Information Systems  
 2007



**COUNTY COUNCIL DISTRICT(S): 5**  
**PC#2008-61**

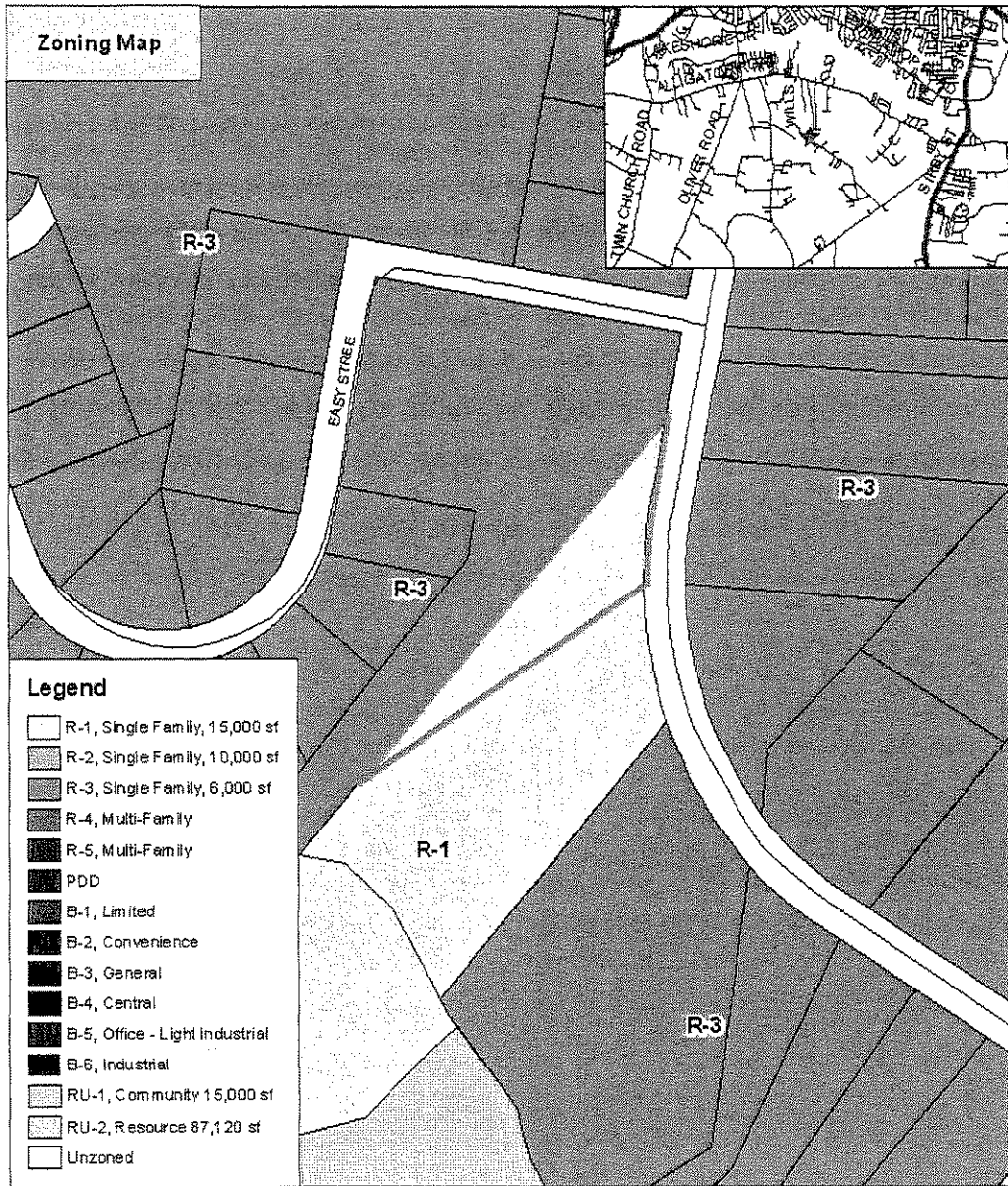

0 135 270 540 Feet



Map Prepared by: RWE  
 Copyright 2007: Florence County/Municipal Planning  
 & Building Inspections Department  
 Geographic Information Systems  
 2007

**COUNTY COUNCIL DISTRICT(S): 5**  
**PC#2008-61**

Florence County 2003 Orthophotography Map



0 105 210 420 Feet



Map Prepared by: RWE  
Copyright 2007: Florence County/Municipal Planning  
& Building Inspections Department  
Geographic Information Systems  
2007

COUNTY COUNCIL DISTRICT(S): 5  
PC#2008-81

# Comprehensive Plan Attachment:

## Rural Resource / Agricultural Areas

Most areas shown on the Plan Map generally are outside the path of projected development, characteristically rural and predominately undeveloped or in agricultural use at this time. Moreover, few changes to these areas are anticipated during the life of this Plan, provided urban sprawl is kept in check. The retention of open lands, woodlands, and wetlands which make up a large part of this area, are essential for clean air, water, wildlife, many natural cycles, and a balanced environment among other things. Even more essential from an economic perspective are the agricultural lands and farming operations in this area. These areas also provide a **rural environment** preferred by many people over subdivisions and higher density urban or community settings.

### Objective

The objective of this classification is to conserve rural characteristics and resources, particularly agricultural, and maintain a balanced rural-urban environment.

### Strategy

Strategies designed to implement this objective include:

- ✓ Setting an urban growth boundary which would limit urban intrusions into such areas.
- ✓ Monitoring and mitigating proposed changes which would alter or compromise the rural character of such area.
- ✓ Amending subdivision regulations to encourage cluster development with open space-agricultural land set aside as an alternative to large lot development.
- ✓ Prohibit through zoning high intensity development from the area.

### Plan Compliance Matrix

<b>PLAN MAP OBJECTIVES</b> <b>(Summary)</b>	<b>USE IN ACCORD WITH PLAN MAP OBJECTIVES</b>	<b>USES AT VARIANCE WITH PLAN MAP OBJECTIVES</b>
Conserve rural characteristics and resources and maintain a balanced rural-urban environment	<ul style="list-style-type: none"> <li>❖ Single-family site built and manufactured dwellings</li> <li>❖ Agricultural uses</li> <li>❖ Small scale retail uses</li> <li>❖ Agricultural related industrial uses</li> <li>❖ Institutional uses</li> </ul>	<ul style="list-style-type: none"> <li>❖ High density residential uses</li> <li>❖ Big Box retail</li> <li>❖ Uses generally in conflict with rural values and characteristics</li> </ul>



## ZONING ORDINANCE ATTACHMENT

### **R-1, R-2, and R-3 Single-Family Residential Districts**

Aside from differences in lot sizes and densities, these districts are intended to foster, sustain, and protect areas in which the principal use of land is for single-family dwellings and related support uses.

## FLORENCE COUNTY COUNCIL MEETING

Item For Meeting On: Thursday, January 15, 2009

**AGENDA ITEM:** Ordinance No.14-2008/09  
Third Reading

**DEPARTMENT:** Planning and Building Inspections

*William N. Hoag*

### **ISSUE UNDER CONSIDERATION:**

[An Ordinance To Rezone Property Owned By Real Estate Asset Management Located At 1133 East Howe Springs Road, Florence From R-1, Single-Family Residential District To B-3, General Commercial District Shown On Florence County Tax Map No. 00180, Block 1, Parcel 202 Consisting Of 2.9 Acres.]

### **POINTS TO CONSIDER:**

1. The property is located in Council District 7.
2. The subject property is currently being utilized as a real estate management company and a residential/ commercial painting business.
3. The property is currently zoned R-1, Single-Family Residential District.
4. The applicant wishes to rezone the property to B-3, General Commercial District.
5. The property is surrounded by some commercial property and some residentially-developed property.
6. The property is designated as Developing Residential areas according to the Comprehensive Plan. Upon approval of the updated map by the Florence County Council, the subject property will be located in a Commercial Growth and Preservation area, which will then comply with the Comprehensive Plan.

### **OPTIONS:**

1. *(Recommended)* Approval Of Ordinance No.14-2008/09 To Rezone Property Owned By Real Estate Asset Management Located At 1133 East Howe Springs Road, Florence From R-1, Single-Family Residential District To B-3, General Commercial District Shown On Florence County Tax Map No. 00180, Block 1, Parcel 202 Consisting Of 2.9 Acres.  
*(Planning Commission approved 9-0)(Council District7)*
2. Provide An Alternative Directive

### **ATTACHMENTS:**

**Copies of the following are attached:**

1. Ordinance No14-2008/09
2. Staff report for PC#2008-62
3. Vicinity map
4. Location map
5. Comprehensive Land Use Plan map
6. Zoning map
7. Aerial photograph
8. Comprehensive Plan information
9. Zoning Ordinance Information

Sponsor(s)	:Planning Commission
Planning Commission Consideration	:October 28, 2008
Planning Commission Public Hearing	:October 28, 2008
Planning Commission Recommendation	:October 28, 2008[Approved 9-0]
First Reading/Introduction	:November 20, 2008
Committee Referral	:N/A
Second Reading	:December 11, 2008
Third Reading	:January 15, 2009
Effective Date	:Immediately

I, \_\_\_\_\_,  
Council Clerk, certify that this  
Ordinance was advertised for  
Public Hearing on \_\_\_\_\_.

**ORDINANCE NO. 14-2008/09**

**COUNCIL-ADMINISTRATOR FORM OF GOVERNMENT FOR FLORENCE COUNTY**

**[An Ordinance To Rezone Property Owned By Real Estate Asset Management Located At 1133 East Howe Springs Road, Florence From R-1, Single-Family Residential District To B-3 General Commercial District Shown On Florence County Tax Map No. 00180, Block 1, Parcel 202 Consisting Of 2.9 Acres.**

**WHEREAS:**

1. Article 9, Section 9.1 entitled "Intent" of Chapter 30-Zoning Ordinance of the Florence County Code establishes that Florence County Council must be satisfied that applications for amendments to the Zoning Atlas of Florence County are not injurious from a public health, safety, and general welfare outlook and the effect of the change will not negatively impact the immediate environs or the County generally; and
2. Article 9, Section 9.5 entitled "Administrative Procedures, Action" of Chapter 30-Zoning Ordinance of the Florence County Code for Florence County republished January, 2008, provides a procedure for amending the Official Zoning Map of the County of Florence; and
3. The procedure has been followed by the Florence County Planning Commission at a public hearing on October 28, 2008.

**NOW THEREFORE BE IT ORDAINED BY THE FLORENCE COUNTY COUNCIL DULY ASSEMBLED THAT:**

1. Property located at 1133 East Howe Springs Road bearing Tax Map 00180, Block1, Parcel 202 is hereby rezoned to B-3, General Commercial District.
2. Provisions in other Florence County ordinances in conflict with this Ordinance are hereby repealed.
3. If any provision of this Ordinance or the application thereof to any person or circumstance is held invalid, the invalidity does not affect other provisions or applications of the Ordinance which can be given effect without the invalid provision or application and to this end, the provisions of this Ordinance are severable.

ATTEST:

SIGNED:

\_\_\_\_\_  
Connie Y. Haselden, Council Clerk

\_\_\_\_\_  
K. G. Rusty Smith, Jr., Chairman

\_\_\_\_\_  
Approved as to Form and Content  
James C. Rushton, III, County Attorney

COUNCIL VOTE:  
OPPOSED:  
ABSENT:

**STAFF REPORT  
TO THE  
FLORENCE COUNTY PLANNING COMMISSION  
October 28, 2008  
PC#2008-62  
ORDINANCE NO. 14-2008/09**

**Subject:** Rezoning request from R-1, Single-Family Residential District to B-3, General Commercial District

**Location:** 1133 East Howe Springs Road, Florence County

**Tax Map Number:** 00180, Block 1, Parcel 202

**Council District(s):** 7; County Council

**Owner of Record:** Real Estate Asset Management

**Applicant:** Ralph Medford

**Land Area:** 2.9 acres

**Existing Land Use and Zoning:**

The subject property is a real estate management company and a residential/ commercial painting business and zoned R-1, Single-Family Residential District.

**Proposed Land Use and Zoning:**

The applicant requests that the subject parcel be rezoned to B-3, General Commercial District, for future commercial and service needs as permitted within and by the standards of the B-3, General Commercial District.

**Surrounding Land Use and Zoning:**

**North:** Undeveloped/RU-1/ Florence County

**South:** Vacant commercial use/R-2/ Florence County

**East:** Existing commercial use/B-3/ Florence County

**West:** Single-family residential/R-1/ Florence County

**Florence County Comprehensive Plan:**

The subject property is located in a Developing Residential area according to the Comprehensive Plan Land Use Map. This request does not comply with the Comprehensive Plan. However, as required by State Law, the Planning Department is in the process of updating the Comprehensive Plan Land Use Map. The completion date will be early 2009. Upon approval of the updated map by the Florence County Council, the subject property will be located in a Commercial Growth and Preservation area, which will comply with the Comprehensive Plan.

**Staff Analysis:**

**Access and Circulation** - Present access to the property is by way of Howe Springs Road.

**Water and Sewer Availability** - Water services will be provided by the City of Florence. Currently the property has a septic tank.

Adjacent Waterways/Bodies of Water/Flood Zone - There does not appear to be any waterway/body of water adjacent to this property. It is not in a flood zone.

Traffic Review - The rezoning of this property will have a minimal effect on traffic flow for the area.

Background – The property is located on Howe Springs Road in the County of Florence and is currently zoned R-1, Single-Family Residential District

**Florence County Planning Commission Action: October 28, 2008**

The nine Planning Commission members present approved the zoning request unanimously at the meeting held on October 28, 2008.

**Florence County Planning Commission Recommendation:**

The Planning Commission recommends approval of the rezoning request by Florence County Council. Based on the fact that the subject property will be located in a Commercial Growth and Preservation area which will comply with the Comprehensive Plan which will be completed in early 2009.



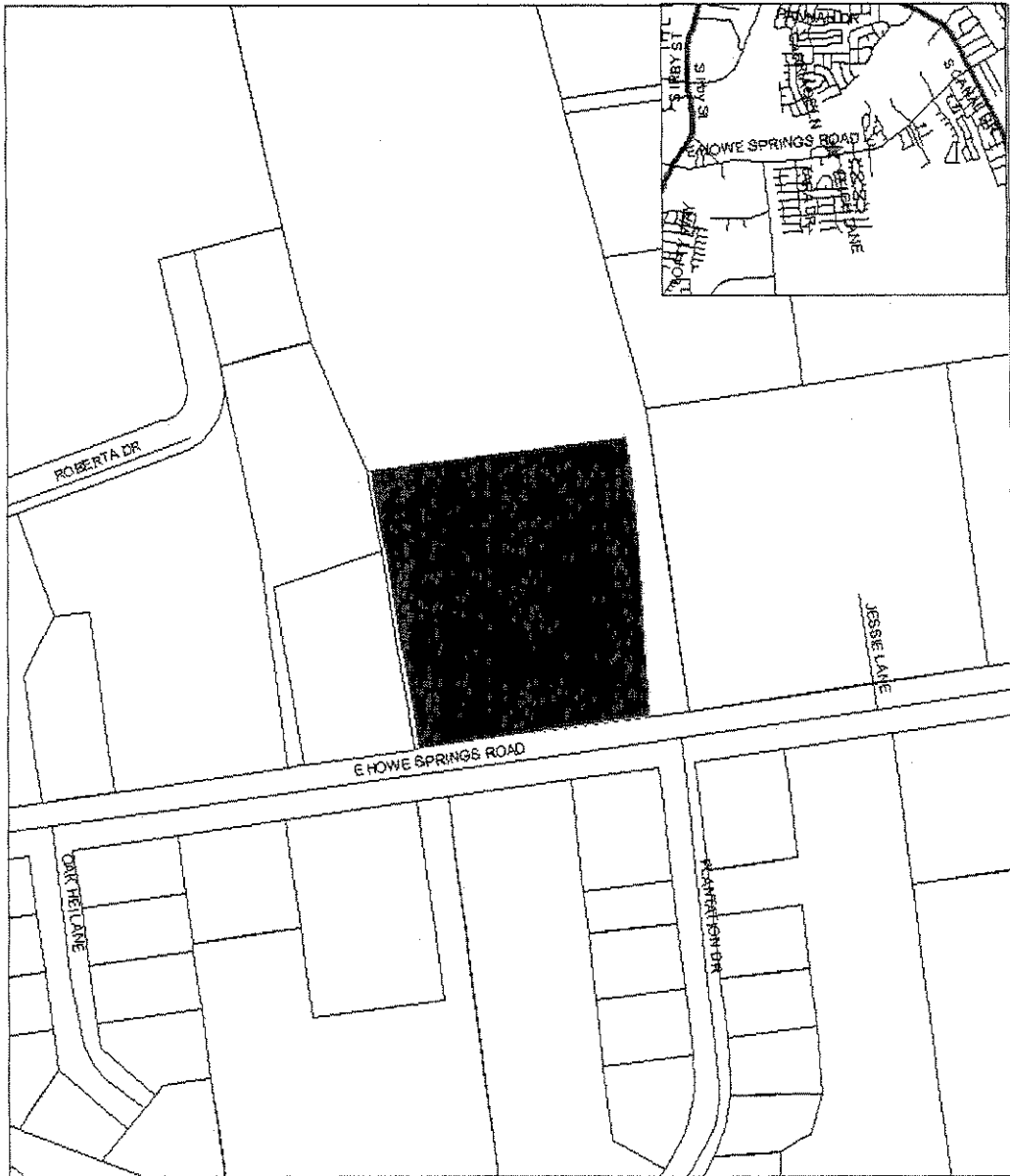

0 120 240 480 Feet

N









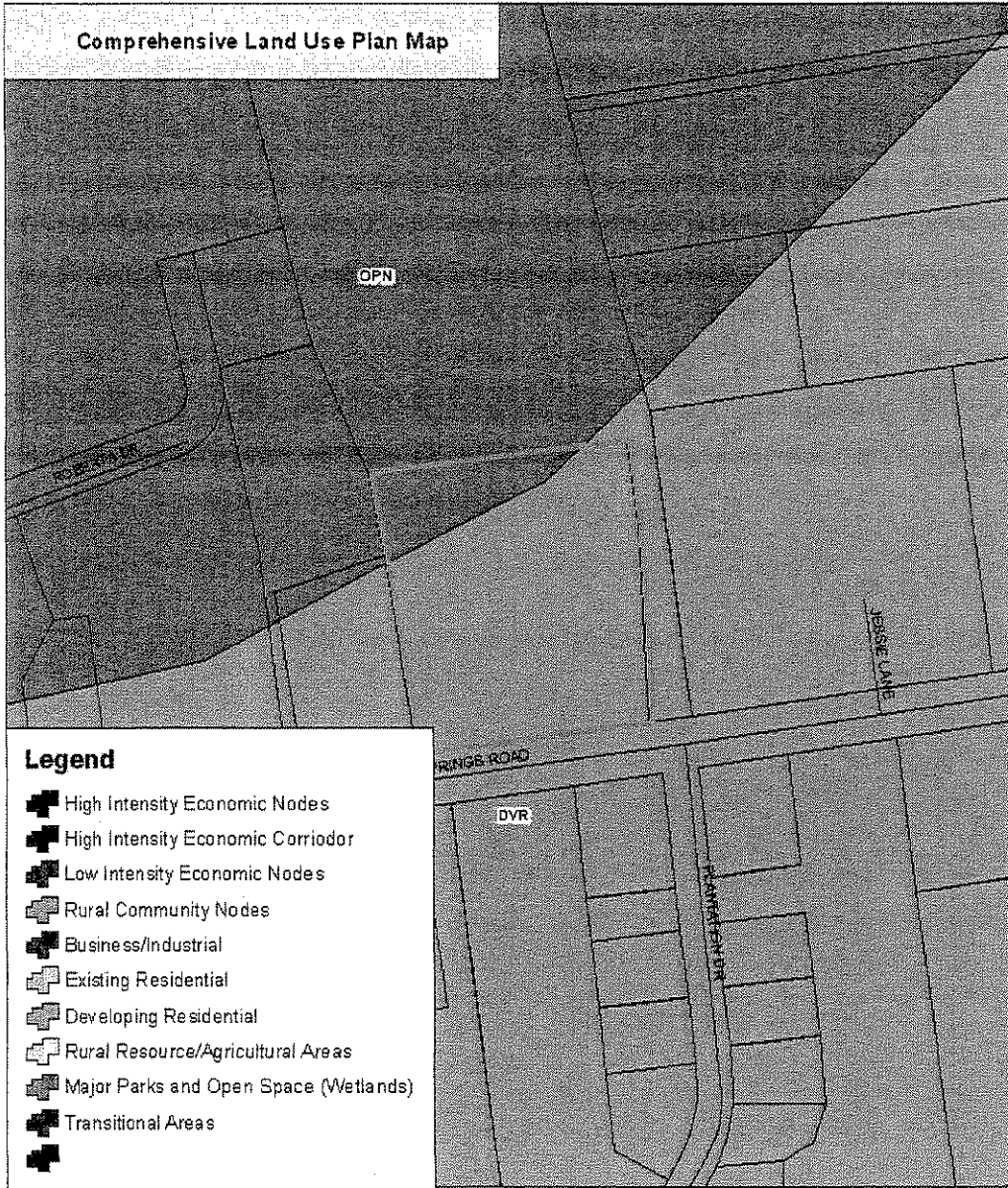



Map Prepared by: RWE  
 Copyright 2007: Florence County/Municipal Planning  
 & Building Inspections Department  
 Geographic Information Systems  
 2007

COUNTY COUNCIL DISTRICT(S): 7  
 PC#2008-62

**Comprehensive Land Use Plan Map**



**Legend**

-  High Intensity Economic Nodes
-  High Intensity Economic Corridor
-  Low Intensity Economic Nodes
-  Rural Community Nodes
-  Business/Industrial
-  Existing Residential
-  Developing Residential
-  Rural Resource/Agricultural Areas
-  Major Parks and Open Space (Wetlands)
-  Transitional Areas

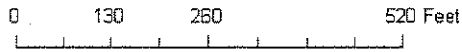

N



Map Prepared by: RWE  
Copyright 2007: Florence County/Municipal Planning  
& Building Inspections Department  
Geographic Information Systems  
2007

**COUNTY COUNCIL DISTRICT(S): 7**  
**PC#2008-62**





0 130 260 520 Feet

N



Map Prepared by: RWE  
 Copyright 2007: Florence County/Municipal Planning  
 & Building Inspections Department  
 Geographic Information Systems  
 2007

**COUNTY COUNCIL DISTRICT(S): 7**  
**PC#2008-62**

Florence County 2003 Orthophotography Map

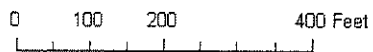

Map Prepared by: RWE  
Copyright 2007: Florence County/Municipal Planning  
& Building Inspections Department  
Geographic Information Systems  
2007



COUNTY COUNCIL DISTRICT(S): 7  
PC#2008-62

# Comprehensive Plan Attachment:

## Residential Areas Developing Residential

This is where most future residential development is expected to take place based on trends, availability of existing and/or planned infrastructure, and environmental conditions.

### Objective

The objective of this designation is to promote and accommodate in an orderly manner residential development in areas so designated.

### Strategy

The following strategies are recommended for implementing the above objective:

- ✓ Regulate development within such areas to ensure land use compatibility.
- ✓ Back residential subdivisions along arterial streets; discourage strip residential development and control curb cuts along such streets.
- ✓ Enact habitability, siting, and safety standards for manufactured homes, and promote compatibility with conventional dwellings.
- ✓ Amend subdivision regulations to address conservation of on-site resources and the integration of such resources into site design.
- ✓ Ensure that the level and type of proposed residential development will be compatible with the physical limitations of the land and established land uses in the surrounding area.
- ✓ Provide opportunities for an appropriate mix of dwelling types, sites, and prices in order to meet current and projected housing needs of county residents in keeping with their financial capabilities and preferences.
- ✓ Promote new and innovative approaches to residential development which will expand the variety of housing opportunities and/or minimize public and private costs.

### Plan Compliance Matrix

<b>PLAN MAP OBJECTIVES (Summary)</b>	<b>USE IN ACCORD WITH PLAN MAP OBJECTIVES</b>	<b>USES AT VARIANCE WITH PLAN MAP OBJECTIVES</b>
Promote and accommodate in an orderly manner new residential development, and permit the housing industry to respond to changing market demands for various types of housing at varying densities	<ul style="list-style-type: none"> <li>❖ Residential uses, including single-family, multi-family, townhouses, patio homes, manufactured homes.</li> <li>❖ Institutional uses in support of and compatible with residential development, e.g. school, churches, recreation facilities</li> </ul>	<ul style="list-style-type: none"> <li>❖ Non-residential uses, including commercial, industrial, and business uses</li> </ul>

## **ZONING ORDINANCE ATTACHMENT**

### **B-3, General Commercial District**

The intent of this district is to provide for the development and maintenance of commercial and business uses strategically located to serve the community and the larger region in which it holds a central position.

**FLORENCE COUNTY COUNCIL MEETING**  
**Item For Meeting On: Thursday, January 15, 2009**

**AGENDA ITEM:** Ordinance No.15-2008/09  
Second Reading

**DEPARTMENT:** Planning and Building Inspections *William H. Hoag*

**ISSUE UNDER CONSIDERATION:**

[An Ordinance To Rezone Property Owned By Ivan Hanna Located At 362 North Georgetown Highway, City of Johnsonville From B-2, Convenience Business District To B-3, General Commercial District Shown On Florence County Tax Map No. 00440, Block 5, Parcel 36 Consisting Of .68± Acres.]

**POINTS TO CONSIDER:**

1. The property is located in Council District 2.
2. The subject property is currently occupied by two used car lots and a liquor store.
3. The property is currently zoned B-2, Convenience Business District.
4. The applicant wishes to rezone the property to B-3, General Commercial District for future development of a manufactured home dealership.
5. The property is surrounded by a vacant area and commercial use.
6. This property is designated as Industrial Business area according to the Comprehensive Plan.
7. This request does comply with the Comprehensive Plan.

**OPTIONS:**

1. (*Recommended*) Approval Of Ordinance No.15-2008/09 To Rezone Property Owned By Ivan E. Hanna Located At 362 North Georgetown Highway, City Of Johnsonville From B-2, Convenience Business District To B-3, General Commercial District Shown On Florence County Tax Map No. 00440, Block 5, Parcel 36 Consisting Of .68 Acres.  
(*Planning Commission approved 6-0*)(*Council District 2*)
2. Provide An Alternative Directive

**ATTACHMENTS:**

**Copies of the following are attached:**

1. Ordinance No.15 -2008/09
2. Staff report for PC#2008-66
3. Vicinity map
4. Location map
5. Comprehensive Land Use Plan map
6. Zoning map
7. Aerial photograph
8. Comprehensive Plan information
9. Zoning Ordinance information

Sponsor(s)	: Planning Commission	I, _____,
Planning Commission Consideration	: November 25, 2008	Council Clerk, certify that this
Planning Commission Public Hearing	: November 25, 2008	Council Clerk, certify that this
Planning Commission Recommendation	: November 25, 2008 [Approved 6-0]	Ordinance was advertised for
First Reading/Introduction	: December 11, 2008	Public Hearing on _____.
Committee Referral	: N/A	
Second Reading	: TBA	
Third Reading	: TBA	
Effective Date	: Immediately	

**ORDINANCE NO. 15 - 2008/09**

**COUNCIL-ADMINISTRATOR FORM OF GOVERNMENT FOR FLORENCE COUNTY**

**[An Ordinance To Rezone Property Owner By Ivan E. Hanna Located At 362 North Georgetown Highway, City Of Johnsonville From B-2, Convenience Business District To B-3, General Commercial District Shown On Florence County Tax Map No. 00440, Block 5, Parcel 36 Consisting Of .68± Acres.]**

**WHEREAS:**

1. Section 30-291 entitled "Intent" of Chapter 30- Zoning Ordinance of the Florence County Code of Ordinances establishes that Florence County Council must be satisfied that applications for amendments to the Zoning Atlas of Florence County are not injurious from a public health, safety, and general welfare outlook and the effect of the change will not negatively impact the immediate environs or the County generally; and
2. Section 30-297 entitled "Administrative Procedures, Action" of Chapter-30 Zoning Ordinance of the Florence County Code for Florence County republished January 2008, provides a procedure for amending the Official Zoning Map of the County of Florence; and
3. The procedure has been followed by the Florence County Planning Commission at a public hearing on November 25, 2008.

**NOW THEREFORE BE IT ORDAINED BY THE FLORENCE COUNTY COUNCIL DULY ASSEMBLED THAT:**

1. Property located at 362 North Georgetown Highway, Johnsonville, SC bearing Tax Map 00440, Block 5, Parcel 36, is hereby rezoned to B-3, General Commercial District.
2. Provisions in other Florence County ordinances in conflict with this Ordinance are hereby repealed.
3. If any provision of this Ordinance or the application thereof to any person or circumstance is held invalid, the invalidity does not affect other provisions or applications of the Ordinance which can be given effect without the invalid provision or application and to this end, the provisions of this Ordinance are severable.

ATTEST:

SIGNED:

\_\_\_\_\_  
Connie Y. Haselden, Council Clerk

\_\_\_\_\_  
K. G. Rusty Smith, Jr., Chairman

\_\_\_\_\_  
Approved as to Form and Content  
James C. Rushton, III, County Attorney

COUNCIL VOTE:  
OPPOSED:  
ABSENT:

**STAFF REPORT  
TO THE  
FLORENCE COUNTY PLANNING COMMISSION  
November 25, 2008  
PC#2008-66  
ORDINANCE NO. 15-2008/09**

**Subject:** Rezoning request from B-2, Convenience Business District to B-3, General Commercial District

**Location:** Property located on 362 North Georgetown Highway, City of Johnsonville

**Tax Map Number:** 00440, Block 05, Parcel 036

**Council District(s):** 2; County Council

**Owner of Record:** Ivan E. Hanna

**Applicant:** David Cox

**Land Area:** Approximately .68± acres

**Existing Land Use and Zoning:**

The subject property is currently occupied by two used car lots and a liquor store. The property is currently zoned B-2, Convenience Business District.

**Proposed Land Use and Zoning:**

The proposal is to rezone the subject property to B-3, General Commercial District for future development of a manufactured home dealership.

**Surrounding Land Uses and Zoning**

North: Commercial/B-2/ City of Johnsonville  
South: Vacant/B-2/ City of Johnsonville  
East: Vacant /Unzoned/ Florence County  
West: Commercial/R-1/ City of Johnsonville

**Florence County Comprehensive Plan:**

The subject property is designated as being in the Industrial Business area according to the Land Use Plan Map of the Comprehensive Plan. The applicant's request to rezone property to B-3 does comply with the Comprehensive Plan.

**Staff Analysis:**

Access and Circulation- Present access to the property is by way of North Georgetown Highway that is maintained by South Carolina Department of Transportation.

Water and Sewer Availability- These services are provided by the City of Johnsonville Public Works.

Adjacent Waterways/Bodies of Water/Flood Zone- There does not appear to be any waterway/body of water adjacent to the property. The property is not located in a flood zone.

Background- The request is to rezone the subject property to B-3, General Commercial District.

**Florence County Planning Commission Action: November 25, 2008**

The six Planning Commission members present approved the rezoning request unanimously at the meeting held on November 25, 2008.

**Florence County Planning Commission Recommendation:**

The Planning Commission recommends approval of the rezoning request by Florence County Council based on the request being in compliance with the Comprehensive Plan.



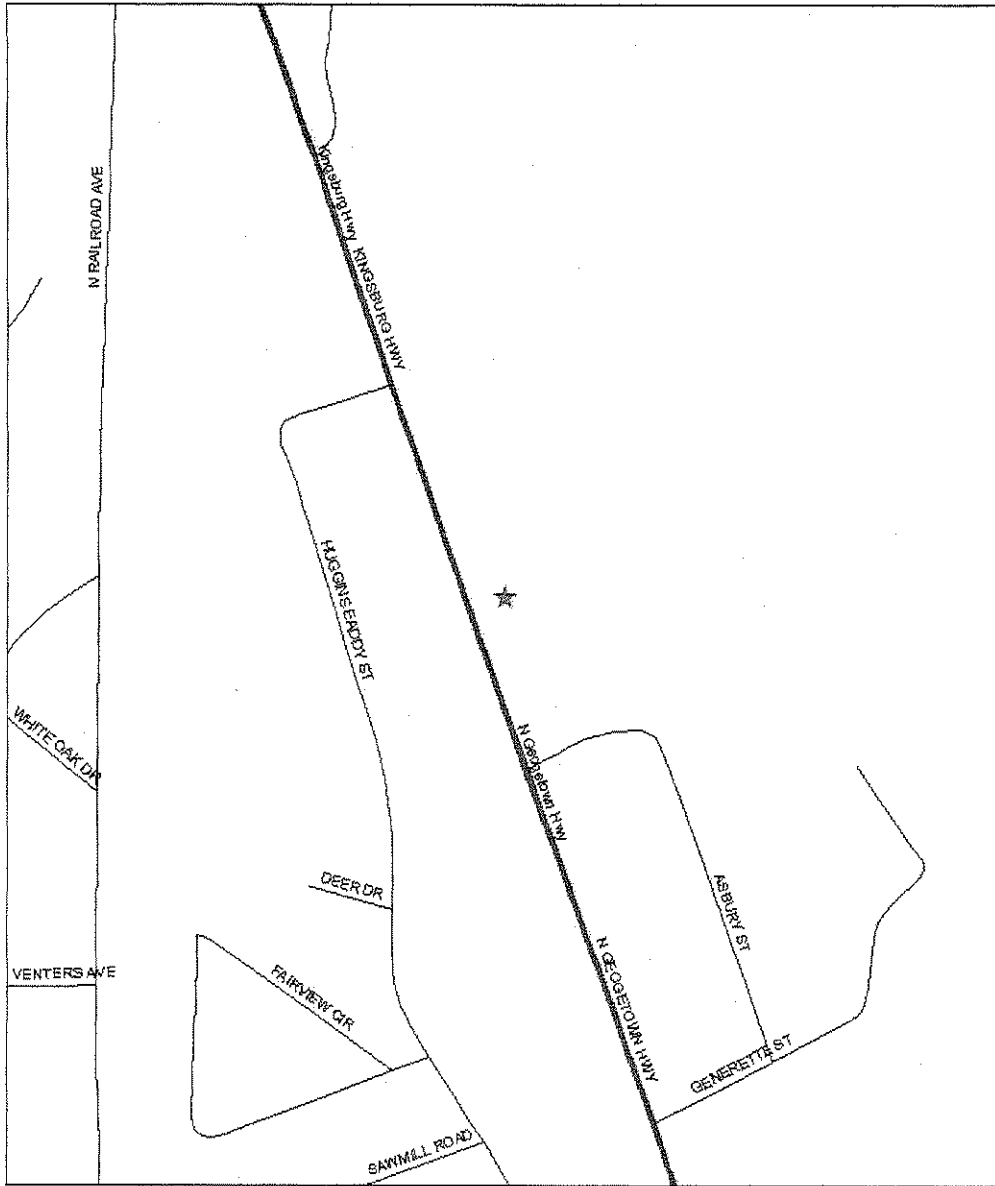

062.525 250 Feet



Map Prepared by: RWE  
 Copyright 2007: Florence County/Municipal Planning  
 & Building Inspections Department  
 Geographic Information Systems  
 2307



**COUNTY COUNCIL DISTRICT(S): 2**  
**PC#2008-66**

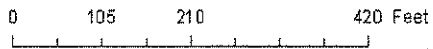
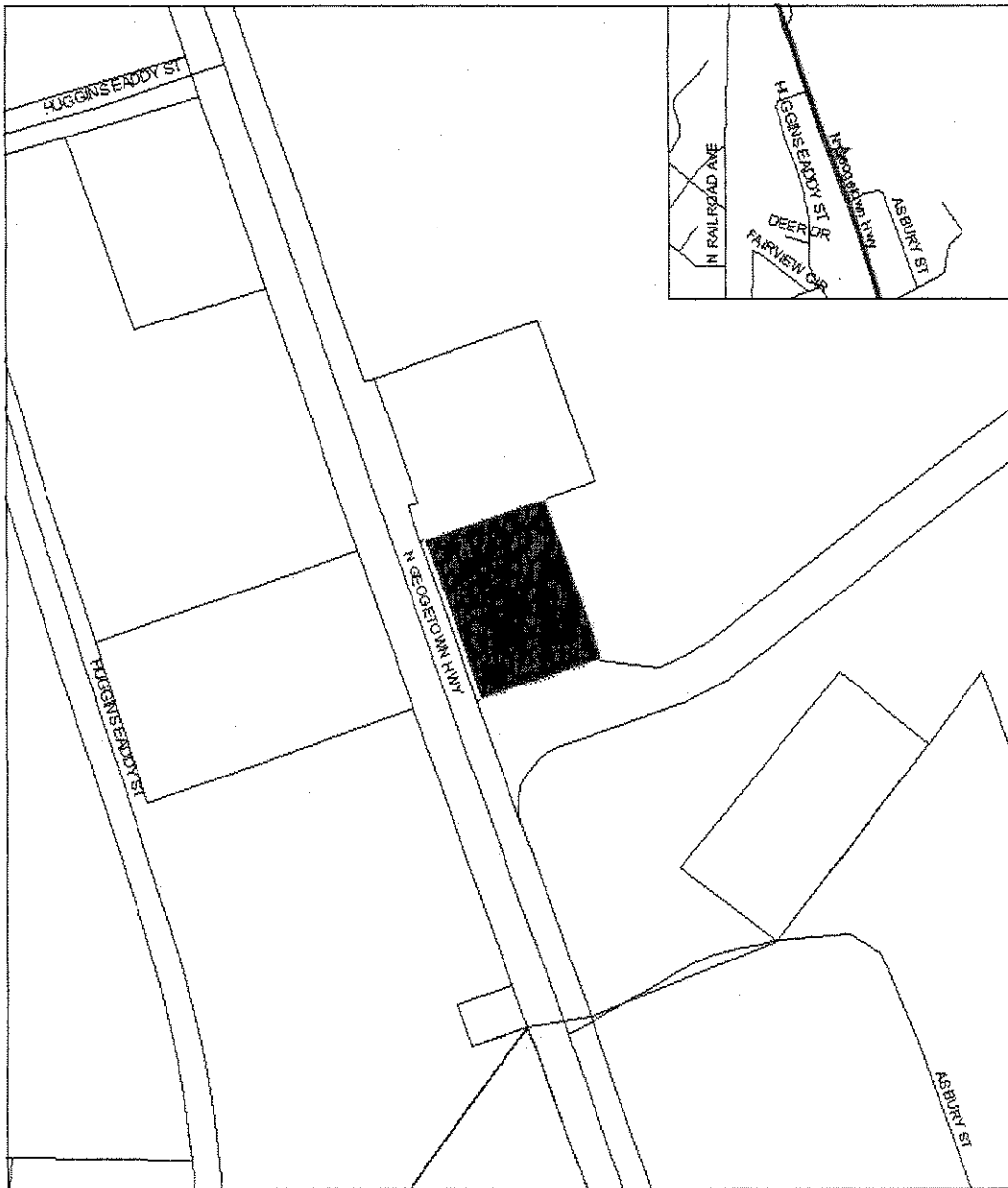

N



Map Prepared by: RWE  
 Copyright 2007: Florence County/Municipal Planning  
 & Building Inspections Department  
 Geographic Information Systems  
 2007

**COUNTY COUNCIL DISTRICT(S): 2**  
**PC#2008-66**

Comprehensive Land Use Plan Map

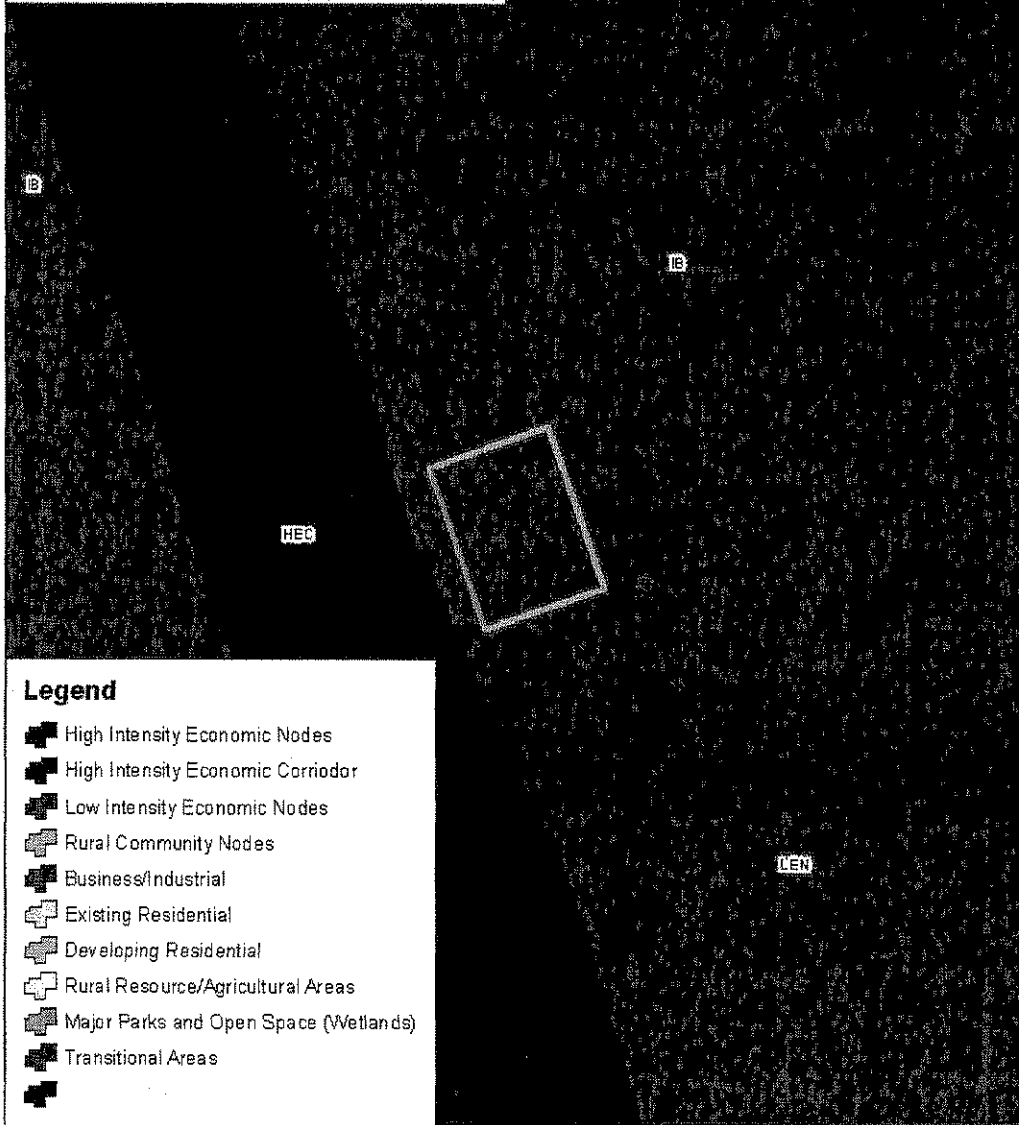

0 112.5 225 450 Feet

N



Map Prepared by: RWE  
Copyright 2007: Florence County/Municipal Planning  
& Building Inspections Department  
Geographic Information Systems  
2007

COUNTY COUNCIL DISTRICT(S): 2  
PC#2008-66



Florence County 2003 Orthophotography Map

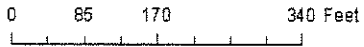

Map Prepared by: RWE  
Copyright 2007: Florence County/Municipal Planning  
& Building Inspections Department  
Geographic Information Systems  
2007



COUNTY COUNCIL DISTRICT(S): 2  
PC#2008-66

# Comprehensive Plan Attachment:

## Economic Activity Areas Industrial-Business Areas

### Objective

The objective of the Industrial–Business designation is twofold, (1) to create industrial and business development opportunities and (2) to protect existing industrial and business interests from incompatible development.

Areas so designated have been determined to be suitable to such development based on soil conditions, access, and infrastructure (existing or planned).

### Strategy

- ✓ Identify and map areas with industrial and business potential, and take appropriate action to reserve such areas for future development.
- ✓ Promote the development of industrial and office parks within such areas.
- ✓ Facilitate such areas for industrial and business development.
- ✓ Reduce through zoning, site design, and/or buffer requirements potential conflicts between business/ industrial uses (existing and future) and residential uses.

### Plan Compliance Matrix

PLAN MAP OBJECTIVES (Summary)	USE IN ACCORD WITH PLAN MAP OBJECTIVES	USES AT VARIANCE WITH PLAN MAP OBJECTIVES
Create industrial and business development opportunities, and protect industrial and business interests from incompatible development	<ul style="list-style-type: none"> <li>❖ Industrial and business uses</li> <li>❖ Institutional uses</li> <li>❖ Wholesale and warehousing uses</li> <li>❖ Big box retail</li> <li>❖ Mixed-use planned development</li> <li>❖ Existing residential and infill of existing subdivisions</li> </ul>	<ul style="list-style-type: none"> <li>❖ New residential subdivisions</li> </ul>

## **ZONING ORDINANCE ATTACHMENT**

### **B-3, General Commercial District**

The intent of this district is to provide for the development and maintenance of commercial and business uses strategically located to serve the community and the larger region in which it holds a central position.

# FLORENCE COUNTY COUNCIL MEETING

January 15, 2009

**AGENDA ITEM:** Second Reading - Ordinance No. 16-2008/09

**DEPARTMENT:** Administration

**ISSUE UNDER CONSIDERATION:**

(An Ordinance Authorizing The Postponement Of Reassessment For Tax Year 2009 Until Tax Year 2010 And All Other Matters Relating Thereto.)

**OPTIONS:**

1. *(Recommended)* Approve Second Reading of Ordinance No. 16-2008/09.
2. Provide an Alternate Directive

**ATTACHMENTS:**

Ordinance No. 16-2008/09.



Sponsor(s) : County Council  
 First Reading/Introduction : December 11, 2008  
 Committee Referral : N/A  
 Committee Consideration Date : N/A  
 Committee Recommendation : N/A  
 Public Hearing : January 15, 2009  
 Second Reading : January 15, 2009  
 Third Reading :  
 Effective Date : Immediately

I, \_\_\_\_\_,  
 Council Clerk, certify that this  
 Ordinance was advertised for  
 Public Hearing on \_\_\_\_\_.

**ORDINANCE NO. 16-2008/09**

**COUNCIL-ADMINISTRATOR FORM OF GOVERNMENT FOR FLORENCE COUNTY**

**(An Ordinance Authorizing The Postponement Of Reassessment For Tax Year 2009 Until Tax Year 2010 And All Other Matters Relating Thereto.)**

**WHEREAS:**

1. Due to the volatility of real estate values, tight resources nationwide, and the need to support local economic stability, it is in the best interest of Florence County and its citizens to postpone the implementation of revised values resulting from reassessment for tax year 2009; and
2. Section 12-43-217(B), Code of Laws of South Carolina, 1976, as amended, authorizes the postponement for one property year.

**NOW THEREFORE BE IT ORDAINED BY THE FLORENCE COUNTY COUNCIL DULY ASSEMBLED THAT:**

1. The implementation of revised values resulting from reassessment in Florence County for tax year 2009 is hereby postponed until tax year 2010.
2. Provisions in other Florence County ordinances in conflict with this Ordinance are hereby repealed.
3. If any provision of this Ordinance or the application thereof to any person or circumstance is held invalid, the invalidity does not affect other provisions or applications of the Ordinance which can be given effect without the invalid provision or application and to this end, the provisions of this Ordinance are severable.

ATTEST:

SIGNED:

\_\_\_\_\_  
 Connie Y. Haselden, Council Clerk

\_\_\_\_\_  
 K. G. Rusty Smith, Jr., Chairman

\_\_\_\_\_  
 Approved as to Form and Content  
 James C. Rushton, III, County Attorney

COUNCIL VOTE:  
 OPPOSED:  
 ABSENT:

## FLORENCE COUNTY COUNCIL MEETING

Item For Meeting On: Thursday, January 15, 2009

**AGENDA ITEM:** Ordinance No.17-2008/09  
Introduction

**DEPARTMENT:** Planning and Building Inspections

### **ISSUE UNDER CONSIDERATION:**

[An Ordinance To Rezone Property Owned By Douglas H. Phillips Located At 3654, 3656, 3658, 3660, 3662 And 3664 South Irby Street, Florence From B-5, Office And Light Industrial District To B-3, General Commercial District Shown On Florence County Tax Map No. 00152, Block 1, Parcel 58 Consisting Of 3.79Acres.]

### **POINTS TO CONSIDER:**

1. The property is located in Council District 5.
2. The subject property is currently occupied by office space, a rental house and a storage area.
3. The property is currently zoned B-5, Office and Light Industrial District.
4. The applicant wishes to rezone the subject property to B-3, General Commercial District.
5. The property is surrounded by existing commercial uses zoned B-5, Office and Light Industrial District and vacant property zoned PDD, Planned Development District and all existing in Florence County.
6. The properties are designated as Rural Resource/Agricultural Areas along a High Intensity Economic Corridor according to the Comprehensive Plan.
7. This request does comply with the Comprehensive Plan.

### **OPTIONS:**

1. *(Recommended)* Approval Of Ordinance No.17-2008/09 To Rezone Property Owned By Douglas H. Phillips Located At 3654, 3656, 3658, 3660, 3662 And 3664 South Irby Street, Florence From B-5, Office And Light Industrial District To B-3, General Commercial District Shown On Florence County Tax Map No. 00152, Block 1, Parcel 58 Consisting Of 3.79Acres  
*(Planning Commission approved 7-0)(Council District5)*
2. Provide An Alternate Directive.

### **ATTACHMENTS:**

**Copies of the following are attached:**

1. Ordinance No.17-2008/09
2. Staff report for PC#2008-68
3. Vicinity map
4. Location map
5. Comprehensive Land Use Plan map
6. Zoning map
7. Aerial photograph
8. Comprehensive Plan information
9. Zoning Ordinance Information

Sponsor(s) : Planning Commission  
 Planning Commission Consideration : December 16, 2008  
 Planning Commission Public Hearing : December 16, 2008  
 Planning Commission Recommendation : December 16, 2008 [Approved 7-0]  
 First Reading/Introduction : January 15, 2009  
 Committee Referral : N/A  
 Second Reading : February 5, 2009  
 Third Reading : February 19, 2009  
 Effective Date : Immediately

I, \_\_\_\_\_,  
 Council Clerk, certify that this  
 Ordinance was advertised for  
 Public Hearing on \_\_\_\_\_

**ORDINANCE NO. 17 -2008/09**

**COUNCIL-ADMINISTRATOR FORM OF GOVERNMENT FOR FLORENCE COUNTY**

[An Ordinance To Rezone Property Owned By Douglas H. Phillips Located At 3654, 3656, 3658, 3660, 3662 And 3664 South Irby Street, Florence From B-5, Office And Light Industrial District To B-3, General Commercial District Shown On Florence County Tax Map No. 00152, Block 1, Parcel 58 Consisting Of 3.79Acres.]

**WHEREAS:**

1. Article 9, Section 9.1 entitled "Intent" of Chapter 30-Zoning Ordinance of the Florence County Code establishes that Florence County Council must be satisfied that applications for amendments to the Zoning Atlas of Florence County are not injurious from a public health, safety, and general welfare outlook and the effect of the change will not negatively impact the immediate environs or the County generally; and
2. Article 9, Section 9.5 entitled "Administrative Procedures, Action" of Chapter 30-Zoning Ordinance of the Florence County Code for Florence County republished January, 2008, provides a procedure for amending the Official Zoning Map of the County of Florence; and
3. The procedure has been followed by the Florence County Planning Commission at a public hearing on December 16, 2008; and

**NOW THEREFORE BE IT ORDAINED BY THE FLORENCE COUNTY COUNCIL DULY ASSEMBLED THAT:**

1. Property located at 3654, 3656, 3658, 3660, 3662 and 3664 South Irby Street bearing Tax Map 00152, Block 1, Parcel 58 is hereby rezoned to B-3, General Commercial District.
2. Provisions in other Florence County ordinances in conflict with this Ordinance are hereby repealed.
3. If any provision of this Ordinance or the application thereof to any person or circumstance is held invalid, the invalidity does not affect other provisions or applications of the Ordinance which can be given effect without the invalid provision or application and to this end, the provisions of this Ordinance are severable.

ATTEST:

SIGNED:

\_\_\_\_\_  
 Connie Y. Haselden, Council Clerk

\_\_\_\_\_  
 K. G. Rusty Smith, Jr., Chairman

\_\_\_\_\_  
 Approved as to Form and Content  
 James C. Rushton, III, County Attorney

COUNCIL VOTE:  
 OPPOSED:  
 ABSENT:

**STAFF REPORT  
TO THE  
FLORENCE COUNTY PLANNING COMMISSION  
December 16, 2008  
PC#2008-68  
ORDINANCE NO. 17-2008/09**

**Subject:** Rezoning request from B-5, Office and Light Industrial District to B-3, General Commercial District

**Location:** 3654, 3656, 3658, 3660, 3662 and 3664 South Irby Street  
Florence County

**Tax Map Number:** 00152, Block 1, Parcel 058

**Council District(s):** 5; County Council

**Owner of Record:** Douglas H. Phillips

**Applicant:** Douglas H. Phillips

**Land Area:** 3.79 acres

**Existing Land Use and Zoning:**

The subject property is office space, a rental house, storage area and zoned B-5, Office and Light Industrial Business District.

**Proposed Land Use and Zoning:**

The applicant requests that the subject parcel be rezoned to B-3, General Commercial District, for future commercial office space.

**Surrounding Land Use and Zoning:**

**North:** Existing Commercial/B-5/ Florence County  
**South:** Existing Commercial/B-5/ Florence County  
**East:** Existing Commercial/B-5/ Florence County  
**West:** Vacant/PD/ Florence County

**Florence County Comprehensive Plan:**

The subject property is located in a Rural Resource area located along a High Intensity Economic Corridor according to the Comprehensive Plan Land Use Map.

**Staff Analysis:**

Access and Circulation - Present access to the property is by way of South Irby and Industrial Boulevard

Water and Sewer Availability - Water services will be provided by the City of Florence. Currently the property is serviced by septic tanks.

Adjacent Waterways/Bodies of Water/Flood Zone - There does not appear to be any waterway/body of water adjacent to this property. It is not in a flood zone.

Background – The property is located on South Irby and Industrial Boulevard in the County of Florence and is currently zoned B-5, Office and Light Industrial District.

**Florence County Planning Commission Action: December 16, 2008**

The seven Planning Commission members present approved the rezoning request unanimously at the meeting held on Tuesday, December 16, 2008

**Florence County Planning Commission Recommendation:**

The Planning Commission recommends approval of the rezoning request by Florence County Council based on its compliance with the Land Use Element of the Comprehensive Plan.

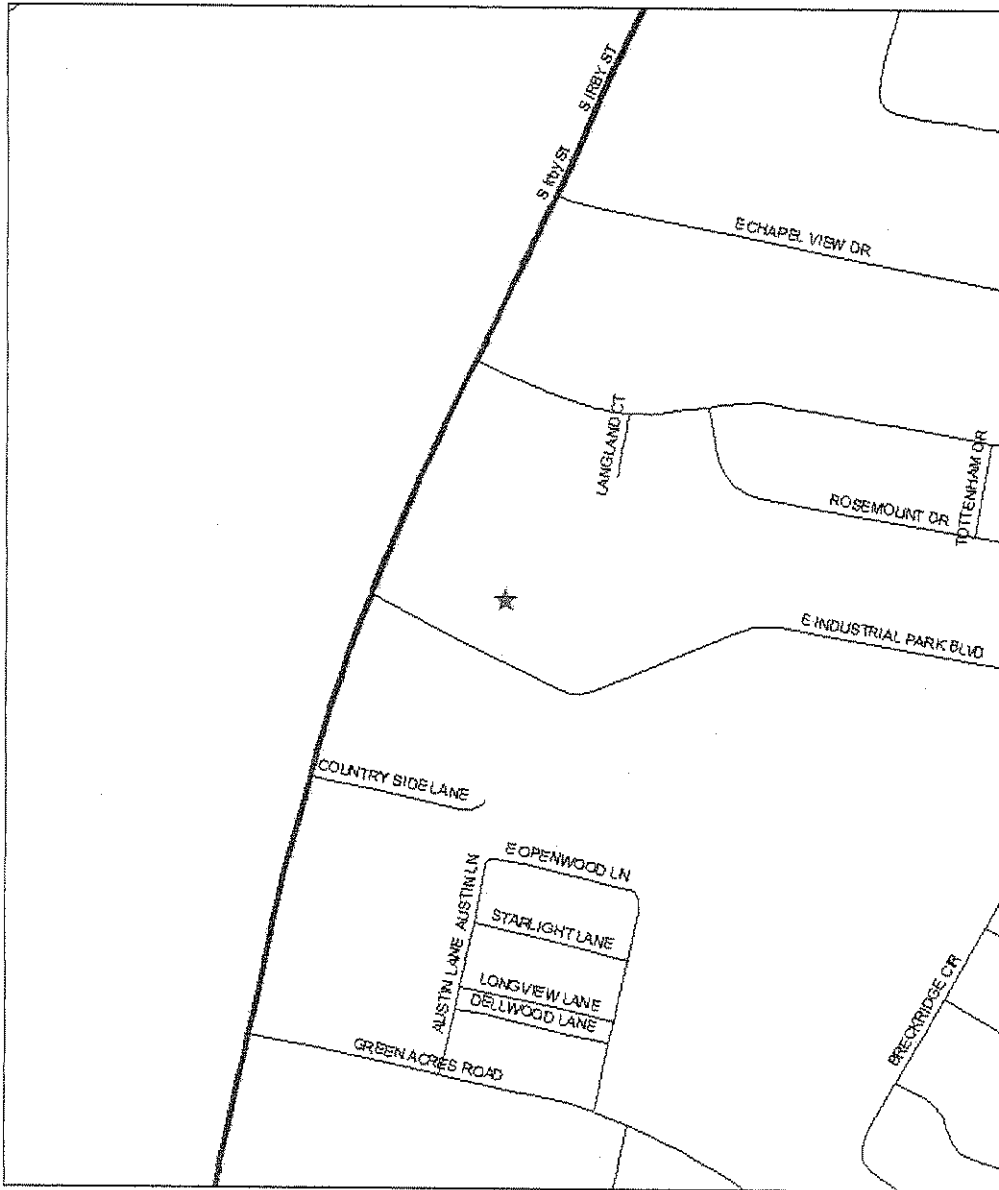

062.525 250 Feet



Map Prepared by: RWE  
 Copyright 2007: Florence County/Municipal Planning  
 & Building Inspections Department  
 Geographic Information Systems  
 2007



**COUNTY COUNCIL DISTRICT(S): 5**  
**PC#2008-68**

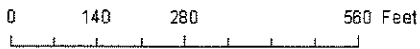

Map Prepared by: RWE  
 Copyright 2007: Florence County/Municipal Planning  
 & Building Inspections Department  
 Geographic Information Systems  
 2007

**COUNTY COUNCIL DISTRICT(S): 5**  
**PC#2008-68**

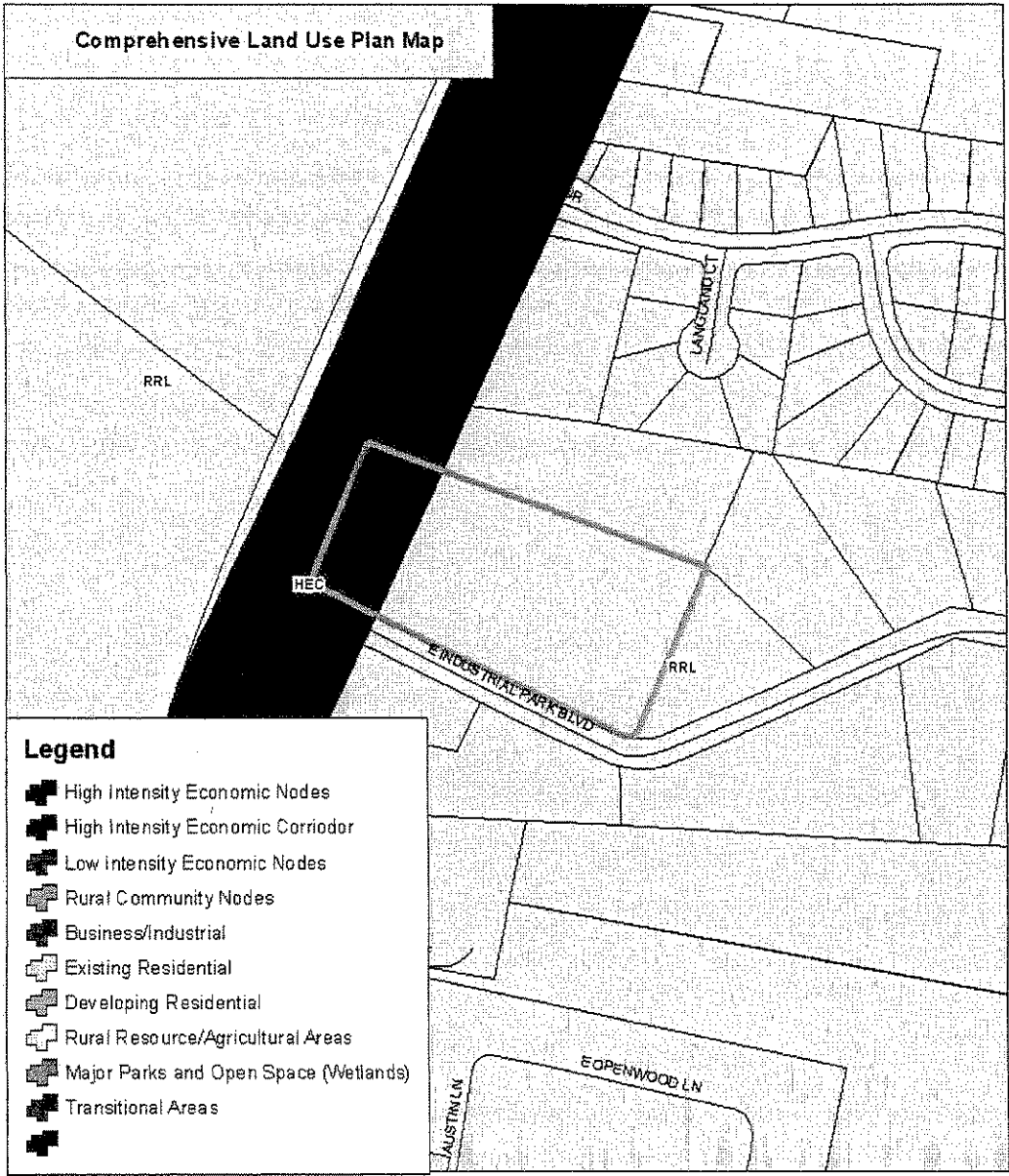

**Legend**

- High Intensity Economic Nodes
- High Intensity Economic Corridor
- Low Intensity Economic Nodes
- Rural Community Nodes
- Business/Industrial
- Existing Residential
- Developing Residential
- Rural Resource/Agricultural Areas
- Major Parks and Open Space (Wetlands)
- Transitional Areas
- 

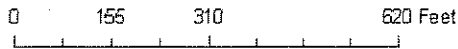

Map Prepared by: RWE  
 Copyright 2007, Florence County/Municipal Planning  
 & Building Inspections Department  
 Geographic Information Systems  
 2007

**COUNTY COUNCIL DISTRICT(S): 5**  
**PC#2008-68**



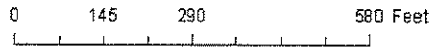
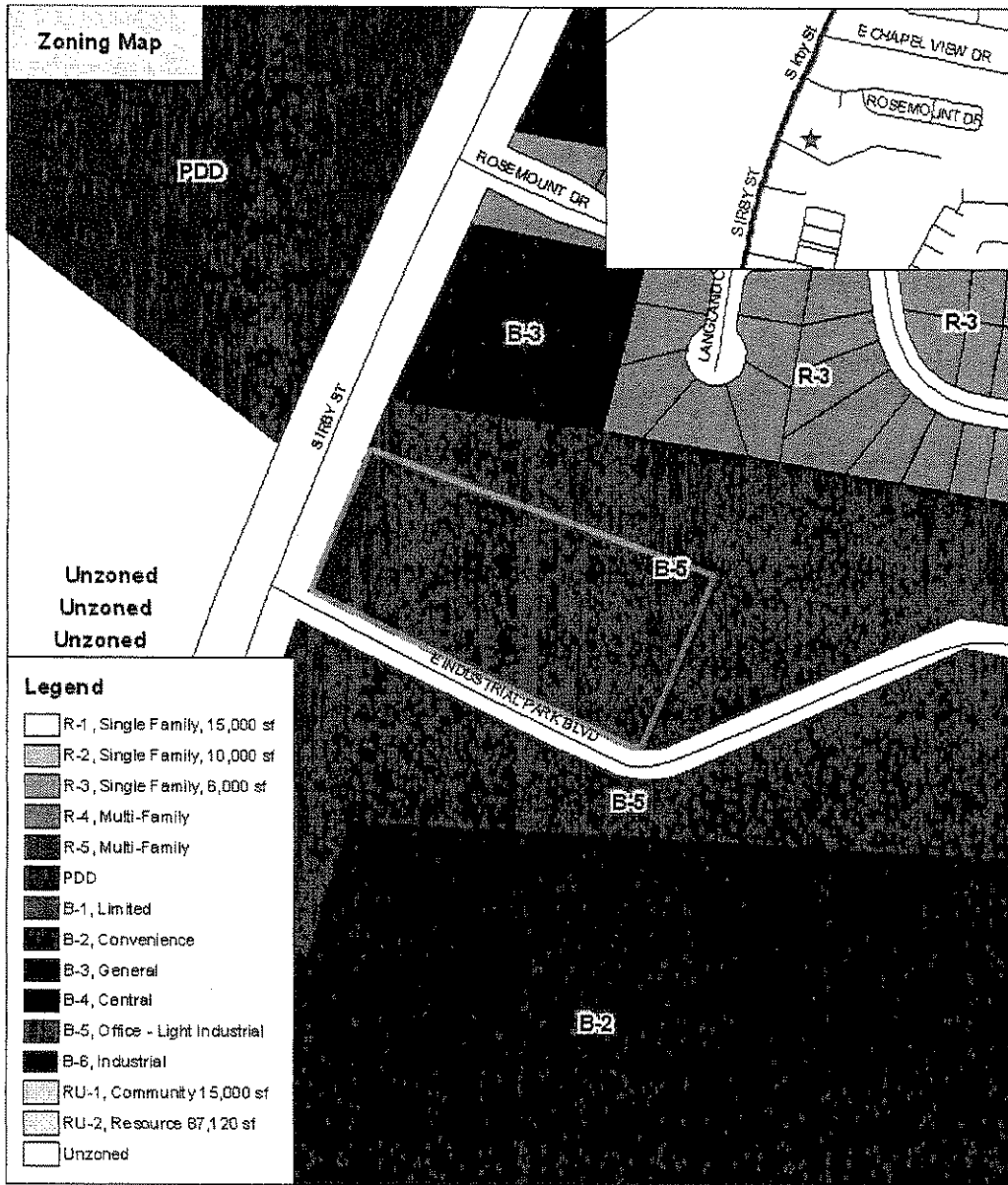

Map Prepared by: RWE  
 Copyright 2007: Florence County/Municipal Planning  
 & Building Inspections Department  
 Geographic Information Systems  
 2007

**COUNTY COUNCIL DISTRICT(S): 5**  
**PC#2008-66**

Florence County 2003 Orthophotography Map



0 115 230 460 Feet



N



Map Prepared by: RWE  
Copyright 2007: Florence County/Municipal Planning  
& Building Inspections Department  
Geographic Information Systems  
2007

COUNTY COUNCIL DISTRICT(S): 5  
PC#2008-68

# Comprehensive Plan Attachment:

## Rural Resource / Agricultural Areas

Most areas shown on the Plan Map generally are outside the path of projected development, characteristically rural and predominately undeveloped or in agricultural use at this time. Moreover, few changes to these areas are anticipated during the life of this Plan, provided urban sprawl is kept in check. The retention of open lands, woodlands, and wetlands which make up a large part of this area, are essential for clean air, water, wildlife, many natural cycles, and a balanced environment among other things. Even more essential from an economic perspective are the agricultural lands and farming operations in this area. These areas also provide a **rural environment** preferred by many people over subdivisions and higher density urban or community settings.

### Objective

The objective of this classification is to conserve rural characteristics and resources, particularly agricultural, and maintain a balanced rural-urban environment.

### Strategy

Strategies designed to implement this objective include:

- ✓ Setting an urban growth boundary which would limit urban intrusions into such areas.
- ✓ Monitoring and mitigating proposed changes which would alter or compromise the rural character of such area.
- ✓ Amending subdivision regulations to encourage cluster development with open space-agricultural land set aside as an alternative to large lot development.
- ✓ Prohibit through zoning high intensity development from the area.

### Plan Compliance Matrix

PLAN MAP OBJECTIVES (Summary)	USE IN ACCORD WITH PLAN MAP OBJECTIVES	USES AT VARIANCE WITH PLAN MAP OBJECTIVES
Conserve rural characteristics and resources and maintain a balanced rural-urban environment	<ul style="list-style-type: none"> <li>❖ Single-family site built and manufactured dwellings</li> <li>❖ Agricultural uses</li> <li>❖ Small scale retail uses</li> <li>❖ Agricultural related industrial uses</li> <li>❖ Institutional uses</li> </ul>	<ul style="list-style-type: none"> <li>❖ High density residential uses</li> <li>❖ Big Box retail</li> <li>❖ Uses generally in conflict with rural values and characteristics</li> </ul>

# Comprehensive Plan Attachment:

## Economic Activity Areas High Intensity Economic Corridors

### Objective

The objective of the high intensity development corridor concept is to support continued development and economic strengthening of designated High Intensity Corridors, and to enhance the appearance, improve the safety, and retain the carrying capacity of such corridors.

### Strategy

- ✓ Enact regulations to govern the development of these corridors in a manner that:
  1. Minimizes the impact on traffic movement and the carrying capacity of such corridors,
  2. Promotes safety,
  3. Addresses appearance and alignment of buildings,
  4. Makes landscaping an integral part of all future development,
  5. Promotes street tree plantings and the greening of such corridors, and
  6. Addresses signage and the proliferation thereof.
  
- ✓ Limit high intensity corridor development to areas so designated, and prohibit such high intensity strip development on other streets and roads.

For the purpose of this study, high intensity use corridors are defined by two or more of the following conditions, and illustrated on the Plan Map.

1. High traffic volumes.
2. Continuous line of development, with relatively few unbroken stretches,
3. Frequent curb cuts often accessing small lots,
4. Public sewer availability, existing or planned.

### Plan Compliance Matrix

PLAN MAP OBJECTIVES (Summary)	USE IN ACCORD WITH PLAN MAP OBJECTIVES	USES AT VARIANCE WITH PLAN MAP OBJECTIVES
Strengthen the economic vitality, enhance the appearance, and maintain the carrying capacity of such corridors	<ul style="list-style-type: none"> <li>❖ General retail and business uses</li> <li>❖ Industrial uses</li> <li>❖ Institutional uses</li> </ul>	<ul style="list-style-type: none"> <li>❖ Residential uses</li> </ul>

## **ZONING ORDINANCE ATTACHMENT**

### **B-3. General Commercial District**

The intent of this district is to provide for the development and maintenance of commercial and business uses strategically located to serve the community and the larger region in which it holds a central position.

# FLORENCE COUNTY COUNCIL MEETING

January 15, 2009

**AGENDA ITEM:** Introduction - Ordinance No. 18-2008/09

**DEPARTMENT:** Administration

## **ISSUE UNDER CONSIDERATION:**

(An Ordinance Amending The Florence County Code To Remove Outdated Sections And Other Matters Relating Thereto.)

## **OPTIONS:**

1. *(Recommended)* Approve Introduction of Ordinance No. 18-2008/09.
2. Provide an Alternate Directive

## **ATTACHMENTS:**

Ordinance No. 18-2008/09.

Sponsor(s) : Administration  
 First Reading/Introduction : January 15, 2009  
 Committee Referral : N/A  
 Committee Consideration Date : N/A  
 Committee Recommendation : N/A  
 Public Hearing :  
 Second Reading :  
 Third Reading :  
 Effective Date : Immediately

I, \_\_\_\_\_,  
 Council Clerk, certify that this  
 Ordinance was advertised for  
 Public Hearing on \_\_\_\_\_.

**ORDINANCE NO. 18-2008/09**

**COUNCIL-ADMINISTRATOR FORM OF GOVERNMENT FOR FLORENCE COUNTY**

**(An Ordinance Amending The Florence County Code To Remove Outdated Sections And Other Matters Relating Thereto.)**

**WHEREAS:**

The Florence County Code contains sections which are no longer applicable, and/or have been superseded by other official actions of Council that may be deleted from the Code.

**NOW THEREFORE BE IT ORDAINED BY THE FLORENCE COUNTY COUNCIL DULY ASSEMBLED THAT:**

1. The Florence County Code is hereby amended by deletion of the following sections:
  - Chapter 2, Administration, Article IV, Centralized Vehicle and Equipment Maintenance, Sections 2-59 through 2-75.
  - Chapter 13, Garbage and Trash, Article III, Landfill User Fees and Charges, Sections 13-29 through 13-13-33.
  - Chapter 28, Public Utilities, Article 1.5, Utilities and Engineering Services Department, Sections 28-15 through 28-20.
  - Chapter 28, Public Utilities, Article II, Water and Sewer Utility Service, Division 1, Generally, Sections 28-21 through 28-32.
  - Chapter 28, Public Utilities, Article II, Water and Sewer Utility Service, Division 2, Water, Sections 28-33 through 28-43.
2. Provisions in other Florence County ordinances in conflict with this Ordinance are hereby repealed.
3. If any provision of this Ordinance or the application thereof to any person or circumstance is held invalid, the invalidity does not affect other provisions or applications of the Ordinance which can be given effect without the invalid provision or application and to this end, the provisions of this Ordinance are severable.

ATTEST:

SIGNED:

\_\_\_\_\_  
 Connie Y. Haselden, Council Clerk

\_\_\_\_\_  
 K. G. Rusty Smith, Jr., Chairman

COUNCIL VOTE:

OPPOSED:

ABSENT:

\_\_\_\_\_  
 Approved as to Form and Content  
 James C. Rushton, III, County Attorney

# FLORENCE COUNTY COUNCIL MEETING

January 15, 2009

**AGENDA ITEM:** Boards & Commissions

**DEPARTMENT:** County Council

**ISSUE UNDER CONSIDERATION:**

Filling vacancies on Boards and Commissions.

**POINTS TO CONSIDER:**

1. Citizen involvement on boards, commissions and committees of Florence County is extremely important.
2. Many boards/commissions/committees currently have vacancies or have approaching vacancies.

**OPTIONS:**

1. Make appropriate appointments.
2. Take no action.

(A copy of the list of current and approaching vacancies for 2008 was previously provided to Council. Additional copies are available upon request.)



# FLORENCE COUNTY COUNCIL MEETING

January 15, 2009

**AGENDA ITEM:** Reports to Council  
Monthly Financial Reports

**DEPARTMENT:** Administration

**ISSUE UNDER CONSIDERATION:**

Monthly financial reports are provided to Council for fiscal year 2009 through November 30, 2008 as an item for the record.

**ATTACHMENTS:**

Copies of the monthly financial reports.

**FLORENCE COUNTY GOVERNMENT  
GENERAL FUND  
REVENUE & EXPENDITURE REPORT FY09  
7/1/08 TO 11/30/08**

	YEAR-TO-DATE			
	BUDGETED REVENUE	ACTUAL REVENUE	REMAINING BALANCE	PCT
<b>REVENUES</b>				
Taxes	30,618,270	26,555,797	4,062,473	13.27%
Licenses & Permits	1,550,800	407,626	1,143,174	73.72%
Fines & Fees	4,158,148	1,650,812	2,507,336	60.30%
Intergovernmental	9,040,854	2,335,170	6,705,684	74.17%
Sales and Other Functional	4,512,193	1,929,101	2,583,092	57.25%
Miscellaneous	973,000	304,216	668,784	68.73%
Operating Transfers	(3,885,630)	(192)	(3,885,438)	100.00%
Use of Fund Balance	2,145,811	-	2,145,811	100.00%
<b>TOTAL</b>	<b>49,113,446</b>	<b>33,182,530</b>	<b>15,930,916</b>	<b>32.44%</b>

	YEAR-TO-DATE				
	BUDGETED EXPENDITURE	ACTUAL EXPENDITURE	REMAINING BALANCE	PCT	
<b>EXPENDITURES</b>					
401	County Library	3,593,653	1,362,069	2,231,584	62.10%
402	County Council	324,150	100,836	223,314	68.89%
403	Legal Services	85,000	39,816	45,184	53.16%
404	Administrator	631,458	244,053	387,405	61.35%
405	Finance	722,835	270,624	452,211	62.56%
406	Treasurer	832,630	328,486	504,144	60.55%
407	Information Technology	1,256,463	444,070	812,393	64.66%
408	Auditor	482,371	178,312	304,059	63.03%
409	Tax Assessor	1,234,330	448,912	785,418	63.63%
410	County Associations	23,153	2,619	20,534	88.69%
412	Procurement & Facilities	221,182	46,626	174,556	78.92%
414	Clerk of Court	958,022	382,537	575,485	60.07%
415	General Sessions Court	172,398	52,688	119,710	69.44%
416	Solicitor	972,552	356,133	616,419	63.38%
418	Human Resources	239,612	89,536	150,076	62.63%
420	Family Court	658,893	266,563	392,330	59.54%
421	Judge of Probate	512,634	188,053	324,581	63.32%
422	Public Defender	656,940	254,948	401,992	61.19%
423	Master in Equity	52,560	19,387	33,173	63.12%
425	Magistrates	2,155,290	851,716	1,303,574	60.48%
432	County Radio System	294,503	165,019	129,484	43.97%
433	Central Dispatch	1,842,059	616,458	1,225,601	66.53%
434	Coroner	254,284	107,505	146,779	57.72%
435	Sheriff's Department	7,596,137	3,388,806	4,207,332	55.39%
436	Building Department	2,033,493	733,311	1,300,182	63.94%
437	GIS	385,827	153,888	231,939	60.11%
438	Central Maintenance	1,055,425	398,983	656,442	62.20%
441	Health Department	86,000	30,330	55,670	64.73%
442	Environmental Services	623,589	214,344	409,245	65.63%
443	Voter Registration	416,520	301,769	114,751	27.55%

**FLORENCE COUNTY GOVERNMENT  
GENERAL FUND  
REVENUE & EXPENDITURE REPORT FY09  
7/1/08 TO 11/30/08**

444	Elections	105,000	2,430	102,570	97.69%
445	EMS	4,232,465	1,670,219	2,562,246	60.54%
446	Rescue Squads	444,920	192,116	252,804	56.82%
447	Emergency Preparedness	317,603	141,942	175,661	55.31%
448	MIAP Administration	418,894	196,100	222,795	53.19%
450	Veteran's Affairs	154,721	55,189	99,532	64.33%
451	Recreation	1,024,291	444,659	579,632	56.59%
452	Florence Senior Center	179,858	64,883	114,975	63.93%
453	DSS	51,680	21,629	30,051	58.15%
454	Stadium Commission	3,500	1,750	1,750	50.00%
456	Pee Dee CAA	10,000	2,500	7,500	75.00%
457	Pee Dee COG	75,457	37,728	37,729	50.00%
459	Soil & Water Conservation	3,817	954	2,863	75.00%
462	Airport Commission	75,457	-	75,457	100.00%
464	Lynches River Park	366,751	156,921	209,830	57.21%
465	Non-Department Fringe	1,044,025	397,221	646,804	61.95%
467	Contingency Fund	110,000	(197,057)	307,057	279.14%
468	PDRTA	15,000	-	15,000	100.00%
469	Employee Tort Insurance	240,630	205,658	34,972	14.53%
470	Humane Society	5,000	-	5,000	100.00%
471	County Agent	5,000	1,250	3,750	75.00%
472	Buildings and Grounds	909,142	344,549	564,593	62.10%
473	Complex	1,207,143	494,647	712,496	59.02%
474	General Phone System	9,000	3,502	5,498	61.09%
475	County Audit	60,000	37,525	22,475	37.46%
478	Mental Health Association	3,000	750	2,250	75.00%
479	PD Coalition	10,000	2,500	7,500	75.00%
480	Pauper's Funerals	7,000	3,800	3,200	45.71%
481	Legislative Delegation Office	5,000	-	5,000	100.00%
482	Rural Fire Departments	15,000	3,052	11,948	79.65%
483	PD Speech and Hearing	3,000	-	3,000	100.00%
484	DSN Board	4,950	1,238	3,713	75.00%
485	Literacy Council	4,950	1,238	3,713	75.00%
486	Lake City Senior Center	160,000	-	160,000	100.00%
487	Senior Citizens' Association	10,000	-	10,000	100.00%
489	PD Mental Health Center	4,950	1,238	3,713	75.00%
490	Museum Commission	10,000	-	10,000	100.00%
491	Employee Blanket Bond	850	824	26	3.10%
711	County Jail	6,507,615	2,289,762	4,217,853	64.81%
714	Sheriff's Special Projects	43,001	43,001	-	0.00%
715	Special Enforcement Unit	467,635	216,116	251,519	53.79%
716	DEA	-	-	-	#DIV/0!
717	Delinquent Tax	413,178	167,121	246,057	59.55%

TOTAL 49,113,446 19,045,347 30,068,099 61.22%

Ideal Remaining % = 58.33%

FLORENCE COUNTY  
BUDGET REPORT - OTHER FUNDS  
CURRENT PERIOD: 7/1/2008 TO 11/30/2008

	BUDGETED EXPENDITURE	YEAR TO DATE CURRENT	REMAINING BALANCE	PCT	BUDGETED REVENUE	YEAR TO DATE CURRENT	REMAINING BALANCE	PCT
8 Law Library Fund	90,000	13,887	76,113	84.57%	90,000	16,979	74,021	82.25%
19 Landfill Fund	5,804,000	1,787,126	4,016,874	69.21%	2,238,860	351,824	1,887,036	84.29%
21 District Utility Allocation Fund	1,943,073	63,688	1,879,385	96.72%	1,943,073	-	1,943,073	100.00%
27 Economic Development Partnership Fund	460,000	202,729	257,271	55.93%	460,000	47,030	412,970	89.78%
30 Road System Maintenance Fee Fund	3,713,571	1,127,046	2,586,525	69.65%	3,713,571	1,307,545	2,406,026	64.79%
37 District Infrastructure Allocation Fund	1,427,568	123,466	1,304,102	91.35%	1,427,568	-	1,427,568	100.00%
48 E911 System Fund	983,999	107,056	856,943	88.89%	490,000	138,984	351,016	71.64%
52 Victim/Witness Assistance Fund	390,634	138,979	251,655	64.42%	390,634	108,045	282,589	72.34%
64 Local Accommodations Tax Fund	2,172,000	1,167,188	1,004,812	46.26%	2,172,000	422,946	1,749,054	80.53%
74 County Debt Service Fund	3,620,803	299,468	3,321,335	91.73%	3,620,803	3,514,877	105,926	2.93%
<b>TOTALS:</b>	<b>20,585,648</b>	<b>5,030,633</b>	<b>15,555,015</b>	<b>75.56%</b>	<b>16,546,509</b>	<b>5,907,230</b>	<b>10,639,279</b>	<b>64.30%</b>

IDEAL REMAINING PERCENT: 58.33%

**Florence County Council**  
**Allocation Balances by District**  
**November 30, 2008**

<b>Council District #</b>	<b>Type of Allocation</b>	<b>Beginning Budget FY08</b>	<b>Commitments &amp; Current Year Expenditures</b>	<b>Current Available Balances</b>
<b>1</b>	Infrastructure	231,321.00	14,353.00	216,968.00
	Paving	56,166.00	26,282.00	29,884.00
	Utility	286,473.00	42,178.00	244,295.00
	In-Kind	19,800.00	2,717.00	17,083.00
<b>2</b>	Infrastructure	92,039.00	42,748.00	49,291.00
	Paving	140,772.00	68,246.00	72,526.00
	Utility	88,611.00	40,816.00	47,795.00
	In-Kind	19,800.00	-	19,800.00
<b>3</b>	Infrastructure	87,108.00	33,336.00	53,772.00
	Paving	455,457.00	10,500.00	444,957.00
	Utility	247,646.00	62,000.00	185,646.00
	In-Kind	19,800.00	-	19,800.00
<b>4</b>	Infrastructure	312,250.00	78,805.00	233,445.00
	Paving	163,925.00	3,193.00	160,732.00
	Utility	147,573.00	75,191.00	72,382.00
	In-Kind	19,800.00	-	19,800.00
<b>5</b>	Infrastructure	139,050.00	30,110.00	108,940.00
	Paving	68,516.00	16,032.00	52,484.00
	Utility	141,740.00	12,250.00	129,490.00
	In-Kind	19,800.00	-	19,800.00
<b>6</b>	Infrastructure	241,890.00	13,700.00	228,190.00
	Paving	184,560.00	39,024.00	145,536.00
	Utility	206,952.00	8,936.00	198,016.00
	In-Kind	19,800.00	3,646.00	16,154.00
<b>7</b>	Infrastructure	129,869.00	19,057.00	110,812.00
	Paving	343,681.00	-	343,681.00
	Utility	315,795.00	37,442.00	278,353.00
	In-Kind	19,800.00	-	19,800.00
<b>8</b>	Infrastructure	261,370.00	176,679.00	84,691.00
	Paving	283,114.00	186,000.00	97,114.00
	Utility	300,970.00	234,046.00	66,924.00
	In-Kind	19,800.00	-	19,800.00
<b>9</b>	Infrastructure	140,844.00	126,253.00	14,591.00
	Paving	150,197.00	48,000.00	102,197.00
	Utility	315,795.00	43,119.00	272,676.00
	In-Kind	19,800.00	-	19,800.00

Infrastructure funds to be used for capital projects or equipment purchases. See guidelines adopted by Council.

Paving funds to be used for paving or rocking roads. See guidelines in County code.

Utility funds to be used for water, sewer, stormwater, and other infrastructure+A26 projects.

In-Kind funds to be used for projects completed by the Public Works Department.

# FLORENCE COUNTY COUNCIL MEETING

January 15, 2009

**AGENDA ITEM:** Reports to Council

**DEPARTMENT:** Administration

**ISSUE UNDER CONSIDERATION:** Approval of the updated Florence County Solid Waste Management Plan

**POINTS TO CONSIDER:**

1. The South Carolina Solid Waste Policy and Management Act of 1991, as amended in 2000, requires local government solid waste plans to be consistent with the revised State Plan.
2. As technologies, regulations, interpretations of existing laws and specific solid waste management needs of the County change, updates to the plan will be made.
3. This revised plan addresses major changes associated with the consolidated landfill regulation, R.61-107.19, and revisions to the population data and waste generation data.

**OPTIONS:**

1. *(Recommended)* Approve the January 15, 2009 Florence County Solid Waste Management Plan update to the December 7, 2006 plan.
2. Provide alternate directive.

**ATTACHMENTS:**

A copy of correspondence from Kent M. Coleman, DHEC-Division of Mining and Solid Waste dated June 3, 2008.

(Due to its volume, a copy of the Florence County Solid Waste Management Plan final draft dated January 15, 2009 is provided to Council separately.)



C. Earl Hunter, Commissioner

*Promoting and protecting the health of the public and the environment*

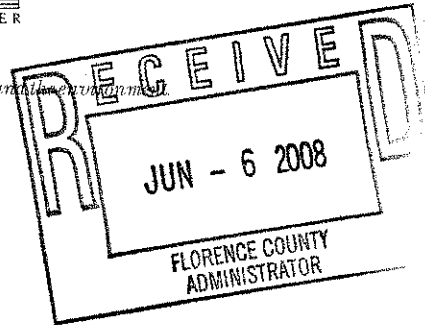

June 3, 2008

Mr. Richard A. Starks, Administrator  
Florence County  
180 N. Irby Street MSC-G  
Florence, SC 29501

Re: **Important Information, New Regulation 61-107.19  
Solid Waste Management: Solid Waste Landfills and Structural Fill –  
Effective on May 23, 2008 Relevance to County/Regional Solid Waste  
Planning.**

Dear Mr. Starks:

The Department would like to bring to your attention that **Regulation 61-107.19 Solid Waste Management: Solid Waste Landfills and Structural Fill** became effective on May 23, 2008. It is important for local governments to understand the effects of the new regulation on solid waste management and planning. Two key issues that we wish to share with you at this time are:

**1) The Department remains responsible for determining whether or not a proposed, expansion or replacement landfill is consistent with the county/regional solid waste management plan. Considering the revised terminology for landfill classification in the new regulation, it is essential that each county solid waste management plan be up-to-date. The Plan should be updated to utilize the new terminology and be written so that it clearly conveys the intent of the county over the twenty-year planning period. The Department encourages counties and regions to assess their need for solid waste disposal capacity, to develop a policy for meeting those needs, and to clearly express that strategy in their local plan.**

Consistency with the solid waste management plan is required for Class One, Two and Three landfills (with the exception of on-site industrial landfills), solid waste processing facilities, waste tire collection facilities, waste tire processing facilities, waste tire disposal facilities, solid waste incinerators, transfer stations, RD&D projects, and off-site treatment of contaminated soils.

Consistency with the plan is not required for structural fill sites, on-site industrial landfills, composting sites, wood shredding/chipping facilities, land applications and used oil processors, re-refiners and marketers.

As always, amendments should be developed and adopted properly, and communicated to the Department upon adoption. A checklist to assist in the drafting of a solid waste management plan is available from the Department and staff is available to review drafts or assist with plan development.

**New Landfill classifications:** As mentioned above, landfill classifications and the corresponding permitting requirements are changing. The new classification system places more emphasis on waste streams and less emphasis on the source of the material. For your convenience, below is a summary of the changes in terminology.

Former Classifications	New Classifications
Land-clearing debris landfills	Class One landfills
Construction & demolition debris landfills Industrial Class I landfills	Class Two landfills
Industrial Class II landfills Industrial Class III landfills Municipal Solid Waste landfills	Class Three landfills

**2) Timing of Consistency Determinations and Public Notices:** Applicants will still be required to obtain determinations from the Department for demonstration-of-need and consistency with solid waste management plans, buffers, land-use and zoning. **The new regulation, however, requires that determinations be requested at the beginning of the application or permit modification process. Once public notices are completed, the Department makes a final decision on these issues, and avenues of appeal are exhausted, the new regulation establishes that these determinations will remain applicable regardless of subsequent changes to the solid waste management plan, zoning ordinances or other relevant plans, ordinances, and local requirements. In other words, these important local issues will be separated from the permit application process and will be discussed, debated and resolved early in the process. There will be ample public involvement and opportunities to appeal as before. In fact these aspects are improved and clarified from the previous regulation. However, it is important to realize that once these decisions are final, they will no longer be a valid basis of comment or appeal during the technical permit application process.**

For more information about solid waste planning or to request assistance with revisions to local solid waste plans, please contact Jana White at [whitejm@dhec.sc.gov](mailto:whitejm@dhec.sc.gov) or (803) 896-4221.

A copy of the regulation may be obtained at [www.scstatehouse.net/regs/3113.doc](http://www.scstatehouse.net/regs/3113.doc). A copy of the regulation will be available on the Bureau of Land and Waste Management's website (<http://www.dhec.sc.gov/environment/lwm>) sometime during the summer.

Sincerely,



Kent M. Coleman, P.G., Director  
Division of Mining and Solid Waste  
Bureau of Land and Waste Management



# FLORENCE COUNTY COUNCIL MEETING

January 15, 2009

**AGENDA ITEM:** Reports to Council  
Contract Award for Professional Engineering Services

**DEPARTMENT:** Administration  
(Procurement Department)

**ISSUE UNDER CONSIDERATION:** Accept the proposal for professional engineering services for the infrastructure improvements at the Britton-Bostic-Winona site in preparation for industrial park certification from Alliance Consulting Engineers for approximately \$75,000 to be funded from Progress Energy Carolinas, Inc. Rural Development Act (RDA) funding.

### **POINTS TO CONSIDER:**

- 1) Progress Energy Carolinas, Inc. has agreed to provide \$100,000 in 2008 RDA funding for infrastructure improvements at the Britton-Bostic-Winona site in preparation for industrial park site certification.
- 2) Council authorized the agreement with Progress Energy Carolinas, Inc. to provide the 2008 RDA funding at the December 11, 2008 meeting for the infrastructure improvements.
- 3) The Florence County Economic Development Partnership Board has approved and recommends the use of Alliance Consulting Engineers to perform the engineering services.

### **FUNDING FACTORS:**

\$75,00 = Total estimated engineering cost to be funded from Progress Energy Carolinas, Inc. and Florence County's December 08 Agreement/RDA Funds.

### **OPTIONS:**

- 1) *(Recommended)* Accept the proposal for professional engineering services for the infrastructure improvements at the Britton-Bostic-Winona site in preparation for industrial park certification from Alliance Consulting Engineers in the amount of \$75,000 to be funded from Progress Energy Carolinas, Inc. Rural Development Act (RDA) funding; and authorize the County Administrator to execute all associated documents to proceed.
- 2) Provide Alternate Directive.

### **ATTACHMENTS:**

Letter from Florence County Economic Development Partnership dated January 8, 2009.



January 8, 2009

Mr. Richard Starks  
County Administrator  
Florence County  
180 N. Irby Street  
Florence, SC 29501

Richard:

The Florence County Economic Development Partnership (FCEDP) is pleased to partner with Progress Energy to pursue "site certification" for the Bostic-Winona Site in Florence County. The South Carolina Certified Sites Program greatly enhances the marketability of industrial property with expedited construction timelines, all necessary site due diligence completed, and all infrastructure in place. This 324-acre site, adjacent to the Roche facility on Old Marion Highway, is one of the few rail served parcels in Florence County in close proximity to interstate highways.

Progress Energy has committed \$100,000 in license fee credits to be utilized with costs associated with certification. FCEDP has evaluated proposals from engineering firms with experience in site certification work, and recommends accepting a proposal by Alliance Consulting Engineering at a cost of approximately \$75,000.

Should you have additional questions, please do not hesitate to contact me.

With kindest regard,

Joe W. King  
Executive Director

1951 PISGAH ROAD • FLORENCE, SOUTH CAROLINA 29501

TEL 843-676-8796

TOLL FREE 800-984-0682

FAX 843-676-8799

[www.fcdep.com](http://www.fcdep.com)

## FLORENCE COUNTY COUNCIL MEETING

Item For Meeting on: January 15, 2009

**AGENDA ITEM:** Reports to Council  
Re-banding Funds Sprint Nextel

**DEPARTMENT:** Florence County Emergency Management Department  
Grants Department

### **ISSUES UNDER CONSIDERATION:**

Council is requested to formally accept funding in the amount of \$1,884.88 received from Sprint Nextel to offset costs associated with re-banding for 800MHz radio system under First Responder Interoperability for the Florence County Emergency Management Department.

### **POINTS TO CONSIDER:**

1. Florence County will utilize the Sprint Nextel funds to offset costs associated with re-banding for 800MHz radio system under First Responder Interoperability for the Florence County Emergency Management Department.
2. Matching funds are not required.
3. Acceptance of this grant includes authorization of appropriate general ledger accounts within the grant fund.

### **FUNDING FACTORS:**

\$1,884.88 = One-time Disbursement amount to offset costs associated with re-banding for the 800MHz radio system under First Responder Interoperability for the Florence County Emergency Management Department as received from Sprint Nextel.

### **OPTIONS:**

1. *(Recommended)* Council is requested to accept the funds from Sprint Nextel in the amount of \$1,884.88 to offset costs associated with re-banding for the 800MHz radio system for the Florence County Emergency Management Department.
2. Provide an Alternative Directive.

### **ATTACHMENTS:**

Copy of the check from Sprint Nextel.



**FLORENCE COUNTY ADMINISTRATION**

Grants Division

**Memo**

**To:** Melissa Rowland, Treasurer's Office  
**From:** Kathy N. Nephew, Grants Coordinator  
**Date:** December 16, 2008  
**Re:** 1<sup>st</sup> Responder Inoperability

**Grant Department # 773**

ACCOUNTING

REVENUE 42-360-4273 \$1,884.88  
EXPENSE 141-421-773-000-9400

**SPRINT NEXTEL**

Sprint  
P.O. Box 63670  
Phoenix, AZ 85082-3670

**Bank of America**  
Bank Of America, N.A.  
Atlanta, DeKalb County, Georgia

64-1278  
611

No. 00001729

CHECK DATE  
12/09/2008

CHECK AMOUNT  
S\*\*\*\*\*1,884.88

PAY

\*\*\*\*\*1,884 DOLLARS AND 88 CENTS

VOID IF NOT CASHED WITHIN 180 DAYS

TO THE  
ORDER  
OF



FLORENCE COUNTY SC  
PO BOX 278  
EFFINGHAM, SC 29541-0278

Authorized Signature

*Robert H. Bisset*

⑈00001729⑈ ⑆061112788⑆ 3299119356⑈

# FLORENCE COUNTY COUNCIL MEETING

January 15, 2009

**AGENDA ITEM:** Report to Council

**DEPARTMENT:** Finance

**ISSUE UNDER CONSIDERATION:** Acceptance of audit for fiscal year ended June 30, 2008

**POINTS TO CONSIDER:**

1. The audit for the year ended June 30, 2008 has been presented by the firm of Baird & Company, CPA's, LLC.
2. Council needs to accept the audit or refer it to the administration and finance committee for their review.

**FUNDING FACTORS:** None

**OPTIONS:**

1. *(Recommended)* Vote to accept the audit as presented.
2. Provide an alternate directive

**ATTACHMENT:**

A copy of the audit will be distributed to each Council member.

# FLORENCE COUNTY COUNCIL MEETING

Item for Meeting on: January 15, 2009

**AGENDA ITEM:** Reports to Council

**DEPARTMENT:** Florence County Geographical Information Systems Department

## **ISSUE UNDER CONSIDERATION:**

Approve Florence County's participation in the 2009 South Carolina Light Detection and Ranging (LiDAR) statewide consortium organized to gather elevation and terrain data using remote sensing during a flyover of the county to be used for flood plain data, storm water drainage planning, and economic development in the amount of \$96,000.

## **POINTS TO CONSIDER:**

1. South Carolina Department of Natural Resources (SCDNR) and United States Geological Survey (USGS) started the initiative in South Carolina to organize counties to share in the cost of flights to gather highly accurate elevation points to be used to accurately map the terrain for use in flood plain data, storm water drainage planning, and facilities planning for economic and transportation development.
2. The South Carolina LiDAR Consortium is providing a 50% match of the total cost of project for the County.

## **FUNDING FACTORS:**

1. \$96,000 = Florence County's portion of the cost of the LiDAR flyover to gather elevation and terrain data to be paid from Fiscal Year 09 Landfill/Capital Improvements Fund.
2. \$96,000 = Match to be provided by the South Carolina LiDAR Consortium.

## **OPTIONS:**

1. ***(Recommended)*** Approve Florence County's participation in the 2009 South Carolina Light Detection and Ranging (LiDAR) statewide consortium organized to gather elevation and terrain data using remote sensing during a flyover of the county to be used for flood plain data, storm water drainage planning, and economic development in the amount of \$96,000; and authorize the County Administrator to execute all associated documents to proceed.
2. Provide an Alternate Directive.

## FLORENCE COUNTY COUNCIL MEETING

Item for Meeting on: January 15, 2009

**AGENDA ITEM:** Reports to Council  
Grant Award Mary AC Ingram Charitable Lead Unitrust

**DEPARTMENT:** Florence County Library  
Grants Department

### **ISSUE UNDER CONSIDERATION:**

Council is requested to accept a Mary AC Ingram Charitable Lead Unitrust grant award in the amount of \$5,000 to purchase books for use by the citizens who patron the Florence County Library.

### **POINTS TO CONSIDER:**

1. Florence County Library will utilize the Mary AC Ingram Charitable Lead Unitrust grant funds to purchase books for the Florence County Library.
2. The grant does not require matching funds.
3. Acceptance of the grant includes authorization of appropriate general ledger accounts within the Grant Fund.

### **FUNDING FACTORS:**

1. \$5,000 = Total one-time costs for the Mary AC Ingram Charitable Lead Unitrust grant.

### **OPTIONS:**

1. *(Recommended)* Council is requested to accept the grant from the Mary AC Ingram Charitable Lead Unitrust in the amount of \$5,000 to be used to purchase books for use in the Florence County Library.
2. Provide an Alternate Directive.

## FLORENCE COUNTY COUNCIL MEETING

Item For Meeting on: January 15, 2009

**AGENDA ITEM:** Other Business  
Grant Application South Carolina Department of Archives & History

**DEPARTMENT:** Florence County Probate Court  
Grants Department

### **ISSUE UNDER CONSIDERATION:**

Council is requested to formally approve submission of a pre-application and subsequent application in the amount of \$20,000 to the South Carolina State Historical Records Advisory Board (SC SHRAB), South Carolina Department of Archives & History under the Historical Records Re-grant Grant Program to provide funding for Phase II of microfilming of rolls/estates for the period 1925-1959 for the Florence County Probate Court and to provide public access to historical records.

### **POINTS TO CONSIDER:**

1. If awarded, the Florence County Probate Court will utilize the South Carolina Department of Archives & History SC SHRAB program funds in the amount of \$10,000 for Phase II to microfilm rolls/estates records for the period 1925-1959 to focus on preservation and to provide access for the public to view historical documents.
2. Matching funds in the amount of \$10,000 are required.
3. The \$20,000 total funds will be used to pay for one fiscal year's salary/fringe for a part-time Microfilm Processor and a part-time Microfilm Prep Technician, to provide funds to assist in procurement of a microsp2000 digital film scanner; and for microfilm and processing services.
4. Phase I of the project was funded with a South Carolina Department of Archives & History grant with a match from Florence County in FY2009 and completed the preservation of records for the years 1915-1924.

### **FUNDING FACTORS:**

1. \$20,000 = Total costs for Phase II Probate Court Microfilming and preservation of rolls/estates for the period 1925-1959 as outlined under the South Carolina Department of Archives & History SC SHRAB Re-grant Grant program grant funds for FY10, staff costs and purchase of a microfilm scanner.
2. \$10,000 = required 50% match to be funded in FY2010 for Probate Court.

### **OPTIONS:**

1. *(Recommended)* Council is requested to approve the submission of the pre-grant and subsequent grant application to the South Carolina Department of Archives & History in the amount of \$20,000 (\$10,000 grant and \$10,000 match) and to approve inclusion in the FY2010 budgetary process for the required match.
2. Provide an Alternative Directive.

### **ATTACHMENTS:**

Page 1 of the application to the South Carolina Department of Archives & History.





# SC SHRAB

## Historical Records Regrant Program 2009 Application

Please follow instructions in SC SHRAB Regrant Application Guidelines

Organization (Name and Address) FLORENCE COUNTY PROBATE COURT 180 NORTH IRBY STREET, MSC-L FLORENCE, SOUTH CAROLINA 29501	County FLORENCE FEIN 57-6000351 Fiscal Year 2009 Web Site WWW.FLORENCECO.ORG
Contact Person (Name and Address) JUDGE KENNETH EATON FLORENCE COUNTY PROBATE COURT 180 NORTH IRBY STREET, MSC-L FLORENCE, SOUTH CAROLINA 29501	Title PROBATE COURT JUDGE Telephone 843-665-3085 Fax 843-665-3068 Email KEATON@FLORENCECO.ORG
Authorizing Official (Name Address) RICHARD A. STARKS FLORENCE COUNTY ADMINISTRATION 180 NORTH IRBY STREET, MSC-G FLORENCE, SOUTH CAROLINA 29501	Title COUNTY ADMINISTRATOR Telephone 843-665-3035 Fax 843-292-1607 Email RSTARKS@FLORENCECO.ORG

### Project Information

Brief Description of Project: PHASE II-  
MICROFILMING OF PROBATE ROLLS/ESTATES  
FOR PERIOD: 1925-1959 FOR PRESERVATION  
PURPOSES AND SECURING THE ABILITY TO  
VIEW DOCUMENTS TO PROVIDE ACCESS TO THE  
PUBLIC.

#### Project Category

- Access
- Program Enhancements
- Preservation
- Education/Training

Grant amount Requested \$10,000.00	Organization Cash Match \$10,000.00	Organization In-Kind Match	Total Project Costs \$20,000.00
---------------------------------------	--	----------------------------	------------------------------------

As authorizing official of the applicant, I certify to the best of my knowledge that the information in this application is true and correct, the application has been duly authorized by the governing body of the applicant, and, if funded, the applicant will carry out the project in the manner described herein. I further certify that the applicant will maintain records in accordance with the generally accepted government accounting principles, and that the funds awarded will be included in those audits or financial statements covering all or part of the project duration period.

Signature of Authorizing Official

1/2/09

Date

SOUTH CAROLINA STATE HISTORICAL RECORDS ADVISORY BOARD  
SC Department of Archives & History

# FLORENCE COUNTY COUNCIL MEETING

January 15, 2009

**AGENDA ITEM:** Reports to Council  
Award of Bid

**DEPARTMENT:** Florence County Library  
Procurement Department

**ISSUE UNDER CONSIDERATION:** Award Bid #11-08/09 for construction of the Olanta and Timmonsville Branch Libraries to FBI Construction Co., Inc., Florence, South Carolina in the amount of \$2,100,884; and approve the extension of the bid amount by FBI Construction Co., Inc. in the amount of \$1,050,000 for the construction of the Johnsonville Branch Library.

## **POINTS TO CONSIDER:**

- 1) Bid #11-08/09 was publicly offered.
- 2) Eleven (11) compliant bids were received.
- 3) FBI Construction Co. Inc., Florence, South Carolina was the lowest compliant bidder at \$2,100,884.
- 4) FBI Construction Co. Inc. has agreed to extend the bid pricing and construct the Johnsonville Branch Library for \$1,050,000.
- 5) The architect recommends this award.
- 6) The bid expires February 16, 2009.

## **FUNDING FACTORS:**

- 1) \$5,240,774 = Total cost estimate for land, construction, furniture, fixtures and equipment for Olanta, Timmonsville, and Johnsonville branch libraries to be funded from previously allocated and approved funds: Bruce and Lee Foundation grant, state grants, Honda grant, and Florence County library construction funds.
- 2) \$483,000 = Estimated total recurring cost (\$161,000 per branch) in the next complete fiscal year, FY11, and subsequent fiscal years incurred directly as a result of this action, which approximates 1.21 mills.

## **OPTIONS:**

- 1) *(Recommended)* Award Bid #11-08/09 to construct Olanta and Timmonsville Branch Libraries to FBI Construction Co., Inc., of Florence, SC in the amount of \$2,100,884; approve the extension of the bid amount by FBI Construction Co., Inc. in the amount of \$1,050,000 for the construction of the Johnsonville Branch Library from grant and state funds, and remaining county library construction funds; and authorize the County Administrator to execute all associated documents, with contracts subject to review by the County Attorney. *(11 Compliant Bids Received)*
- 2) Provide Alternate Directive.

## **ATTACHMENTS:**

1. Bid Tabulation Sheet.
2. December 16, 2008 Recommendation Letter from Craig, Gaulden and Davis.
3. December 23, 2008 Letter from FBI Construction Co, Inc. extending bid amount to Johnsonville Branch Library.

Dept: Florence County Branch Libraries, Olanta & Timmonsville Invitation-to-Bid #11-08/09		Bid Opening Date: Time: Advised Date: Morn News 11/2/08 Invitations to Bids Distributed: 20 Bid Expiration Date: 2/16/2009		12/16/2008 3:00 PM SCBO 10/20/08		pg. 1 of 2	
Name of Bidder	Base Bid	Bid Security	Meets Specs	Total Bid	Total Non-Local (+2%)		
FBI Construction Florence, SC	\$2,100,884.00	Yes	Yes	\$2,100,884.00			
Chancel Builders Myrtle Beach, SC	\$2,196,260.00	Yes	Yes	\$2,196,260.00			
Hanco of SC Myrtle Beach, SC	\$2,552,791.00	Yes	Yes	\$2,552,791.00			
Tungsten Corporation Conway, SC	\$2,582,871.00	Yes	Yes	\$2,582,871.00			
Hay Construction Co., Inc. Myrtle, Beach, SC	\$2,631,000.00	Yes	Yes	\$2,631,000.00			
Gilbert Construction Florence, SC	\$2,813,000.00	Yes	Yes	\$2,813,000.00			

**Notes:**  
2% Local Preference Florence County Code, Section 11-62

Dept: Florence County  
 Branch Libraries, Olanta & Timmonsville  
 Invitation-to-Bid #11-08/09

Bid Opening Date: 12/16/2008  
 Time: 3:00 PM  
 Advertis Date: Morn News 11/2/08  
 Invitations to Bids Distributed: 20  
 Bid Expiration Date: 2/16/2009

pg. 2 of 2

Name of Bidder	Base Bid	Bid Security	Meets Specs	Total Bid	Total Non-Local (+2%)
Hawkins & Kolb Construction Co. Sumter, SC	\$2,958,648.00	Yes	Yes	\$2,958,648.00	
Santee Modular Homes Florence, SC	\$2,976,300.00	Yes	Yes	\$2,976,300.00	
Fields Construction Co., Inc. Florence, SC	\$3,074,030.00	Yes	Yes	\$3,074,030.00	
Connelly Builders, Inc. Columbia, SC	\$3,180,000.00	Yes	Yes	\$3,180,000.00	
Dempsey Construction Co. Hartsville, SC	\$3,772,976.00	Yes	Yes	\$3,772,976.00	

**Notes:**  
 2% Local Preference Florence County Code, Section 11-62

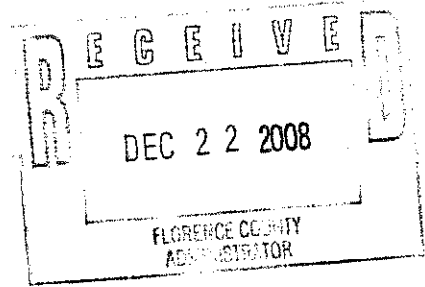

December 17, 2008

Ms. Suzanne King  
Administrative Services Director  
180 North Irby Street  
Florence, South Carolina 29501

Re: Florence County Branch Libraries – Olanta & Timmons ville Branches  
CGD Project No. 07026

Dear Suzanne:

I have reviewed the bids received on December 16, 2008 for the above referenced project. It is my recommendation that Florence County proceed to negotiate a construction contract with FBI Construction.

This bid is substantially lower than our original budget estimates, most probably due to current market conditions and the large number of bidders. Our estimate included \$1,330,875 and \$63,375 in field contingency for each branch. Due to the quantity of the bids received, the fairly wide range between high and low bids and the nature of the geotechnical reports which were received just prior to bids, I recommend that the County retain \$250,000 in contingency funds to address any field issues that may arise during construction.

If you have any questions, please give me a call.

Sincerely,

CRAIG GAULDEN & DAVIS, INC.

A handwritten signature in black ink, appearing to read "David L. Dixon".

David L. Dixon, AIA  
Principal

:dld

cc: Ms. Mazie Abraham  
Mr. Ray McBride  
Mr. Joey Goforth

19 Washington Park

864 242.0761

Post Office Box 2527

fax 864 233.2319

Greenville, South Carolina 29602

www.cgdaarch.com

12/23/08

Richard Starks  
180 North Irby St  
MSC-G  
Florence, S.C. 29501

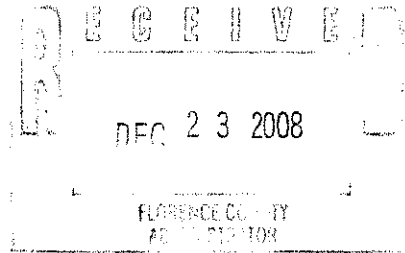

Dear Mr. Starks,

Per my conversation with Suzanne, FBI Construction proposes to construct the library in Johnsonville for \$1,050,000.00. Included in our price is an allowance of \$112,487.00 for site work, tap fees, water, sewer and fireline.

Because the site plans at Johnsonville are not complete, any increase or decrease in cost for the above mentioned items will be adjusted to the \$112,487.00 allowance.

Thank you for the opportunity to construct this additional library. If you have any questions, please contact me at 843-665-0408.

Sincerely,

A handwritten signature in cursive script that reads "Robert Adams, Pres".

Robert Adams  
President

# FLORENCE COUNTY COUNCIL MEETING

January 15, 2009

**AGENDA ITEM:** Reports to Council  
Award of Bid

**DEPARTMENT:** Administration  
Procurement Department

**ISSUE UNDER CONSIDERATION:** Council is requested to award Bid #13-08/09 for the Bellevue Drive and Second Loop Road Turn Lane Widening and Signal Light Addition Project to Boggs Paving, Inc. of Myrtle Beach, SC in the amount of \$32,991.

## **POINTS TO CONSIDER:**

- 1) Bid #13-08/09 was publicly offered.
- 2) Three (3) compliant bids were received.
- 3) Boggs Paving, Inc. of Myrtle Beach, SC was the lowest compliant bidder at \$32,991.
- 4) The engineer has reviewed the bids and recommends this award.
- 5) The bid expires February 16, 2009.

## **FUNDING FACTORS:**

- 1) \$32,991 = Total cost to be funded from Council District #8 Infrastructure Funds previously approved by Council at the November 20, 2008 Council meeting.
- 2) \$0 = Estimated total recurring cost in the next complete fiscal year and subsequent fiscal years incurred directly as a result of this action, which approximates .00 of a mil.

## **OPTIONS:**

- 1) *(Recommended)* Accept the bid of the lowest responsive bidder, Boggs Paving, Inc. of Myrtle Beach, SC for the Bellevue Drive and Second Loop Road Turn Lane Widening and Signal Light Addition Project in the amount of \$32,991 to be funded from previously approved Council District #8 Infrastructure Funds; and authorize the County Administrator to execute all associated documents to proceed. *(3 Compliant Bids Received)*
- 2) Provide Alternate Directive.

## **ATTACHMENTS:**

1. Bid Tabulation Sheet.
2. A copy of the letter of recommendation from Engineering Consultants, Inc. dated December 18, 2008.

Dept: Florence County  
 Traffic Signal, Second Loop Road & Bellevue Drive  
 Invitation-to-Bid #13-08/09

Bid Opening Date: December 18, 2008  
 Time: 2:00 PM

Advertised Date: Morn News 11/30/08 SCBO 12/18/08  
 Invitations to Bids Distributed: 9  
 Bid Expiration Date: 2/18/2009

Name of Bidder	Base Bid	Bid Security	Meets Specs	Total Bid	Total Non-Local (+2%)
Boggs Paving, Inc. Myrtle Beach, SC	\$32,991.00	Yes	Yes	\$32,991.00	
Cherokee, Inc. Columbia, SC	\$46,570.00	Yes	Yes	\$46,570.00	
H. Senn Construction, LLC Columbia, SC	\$57,320.00	Yes	Yes	\$57,320.00	

Notes:  
 2% Local Preference Florence County Code, Section 11-62



ENGINEERING CONSULTANTS, INC.



CIVIL ENGINEERS • LAND SURVEYORS

CLYDE S. BRYCE, JR., PE & RLS

DAVID R. FLOYD, PE & RLS

JAY K. JIUNNIES, PE

2702 S. IRBY STREET (29505)  
PO BOX 3994  
FLORENCE, SC 29502

(843) 669-8823  
(843) 665-7697 Fax

e-mail:  
clyde@tigerengineer.net  
randy@tigerengineer.net  
jay@tigerengineer.net

December 18, 2008

Ms. Mazie Abraham  
Florence County Purchasing  
City County Complex MSC-R  
180 N. Irby Street  
Florence, S. C. 29501

Re: Second Loop Road/Bellevue Traffic Signal  
Award Recommendation

Dear Mazie:

We received bids on the above referenced project on December 18, 2008. The bids were as follows:

Boggs Paving, Inc. – Myrtle Beach, SC	\$ 32,991.00
Cherokee, Inc. – Columbia, SC	\$ 46,570.00
H. Senn Construction LLC – Columbia, SC	\$ 57,320.00

After our review of these bids, as your engineer, I recommend award to the low bidder, Boggs Paving, Inc. of Myrtle Beach, SC, in the amount of \$32,991.00. After your review, please advise us so we can coordinate preparation of the contract documents with you.

Sincerely,

Clyde S. Bryce, Jr., PE/RLS  
ENGINEERING CONSULTANTS, INC.

CSB/dlg

# FLORENCE COUNTY COUNCIL MEETING

January 15, 2009

**AGENDA ITEM:** Reports to Council  
Bid Award

**DEPARTMENT:** Administration  
Procurement Department

**ISSUE UNDER CONSIDERATION:** Award Bid #14-08/09 for Storm Drainage Improvements within Wetlands B, J, and L at the Pee Dee Touchstone Energy Commerce Park to Conder Construction Company, Lugoff, South Carolina in the amount of \$96,488.25 to be funded from Pee Dee Electric Cooperative Rural Development Act (RDA) Funds.

## **POINTS TO CONSIDER:**

- 1) Bid #14-08/09 was publicly offered.
- 2) Seventeen (17) bids were received; sixteen (16) were compliant bids.
- 3) Conder Construction Co., Lugoff, SC, was the lowest compliant bidder at \$96,488.25.
- 4) The engineer recommends this award.
- 5) The bid expires February 2, 2009.

## **FUNDING FACTORS:**

- 1) \$96,488.25 = Total cost to be funded from Pee Dee Electric Cooperative RDA Funds.
- 2) \$0 = Estimated total recurring cost in the next complete fiscal year and subsequent fiscal years incurred directly as a result of this action, which approximates .00 of a mil.

## **OPTIONS:**

- 1) *(Recommended)* Accept the bid of the lowest responsive bidder, Conder Construction Co., Lugoff, South Carolina for the Storm Drainage Improvements within Wetlands B, J, and L at the Pee Dee Touchstone Energy Commerce Park in the amount of \$96,488.25; and authorize the County Administrator to execute all associated documents to proceed. *(16 Compliant Bids Received, 1 non-compliant)*
- 2) Decline

## **ATTACHMENTS:**

- 1) Bid Tabulation Sheet.
- 2) December 4, 2008 Recommendation Letter from Alliance Consulting Engineers.

Dept: Florence County  
 Wetlands Excavation, Storm Drainage Improvements  
 Invitation-to-Bid #14-08/09

Bid Opening Date:  
 Time: 12/2/2008 3:00 PM  
 Advertsed Date: Morn News 11/8&9/08 SCBO 11/6/08  
 Invitations to Bids Distributed: 20  
 Bid Expiration Date: 2/2/2009

pg. 1 of 3

Name of Bidder	Base Bid	Bid Security	Meets Specs	Total Bid	Total Non-Local (+2%)
<b>Conder Construction Co. Lugoff, SC</b>	<b>\$96,488.25</b>	<b>Yes</b>	<b>Yes</b>	<b>\$96,488.25</b>	
D & L Sitework, Inc. Conway, SC	\$98,837.75	Yes	Yes	\$98,837.75	
Goodson Construction Co. Aynor, SC	\$118,244.40	Yes	Yes	\$118,244.40	
Sellers Construction, LLC Conway, SC	\$131,450.00	Yes	Yes	\$131,450.00	
R.E. Goodson Construction Co. Darlington, SC	\$147,690.00	Yes	Yes	\$147,690.00	
J.C. Wilkie Construction, LLC Lexington, SC	\$170,694.50	Yes	Yes	\$170,694.50	

**Notes:**  
 2% Local Preference Florence County Code, Section 11-62

Dept: Florence County Wetlands Excavation, Storm Drainage Improvements Invitation-to-Bid #14-08/09		Bid Opening Date: 12/2/2008 3:00 PM		pg. 2 of 3	
		Advertised Date: Morn News 11/8&9/08 Invitations to Bids Distributed: 20		SCBO 11/6/08	
		Bid Expiration Date:		2/2/2009	
Name of Bidder	Base Bid	Bid Security	Meets Specs	Total Bid	Total Non-Local (+2%)
Shamrock Environmental Corp Browns Summit, NC	\$174,872.00	Yes	Yes	\$174,872.00	
Cherokee, Inc. Columbia, SC	\$178,722.50	Yes	Yes	\$178,722.50	
Henley's Construction Co. Cheraw, SC	\$180,690.00	Yes	Yes	\$180,690.00	
Kirven Construction, Inc. Darlington, SC	\$193,148.75	Yes	Yes	\$193,148.75	
Willis Construction, Inc. Darlington, SC	\$218,210.50	Yes	Yes	\$218,210.50	
L & B Developers, LLC Lake City, SC	\$223,877.50	No	Yes	\$223,877.50	

Notes:

2% Local Preference Florence County Code, Section 11-62

Dept: Florence County  
 Wetlands Excavation, Storm Drainage Improvements  
 Invitation-to-Bid #14-08/09

Bid Opening Date: 12/2/2008 3:00 PM  
 Time: 3:00 PM  
 Advised Date: Morn News 11/8&9/08 SCBO 11/6/08  
 Invitations to Bids Distributed: 20  
 Bid Expiration Date: 2/2/2009

pg. 3 of 3

Name of Bidder	Base Bid	Bid Security	Meets Specs	Total Bid	Total Non-Local (+2%)
Weaver Co., Inc. Conway, SC	\$245,994.15	Yes	Yes	\$245,994.15	
Rock Grading & Paving, Inc. Florence, SC	\$261,955.00	Yes	Yes	\$261,955.00	
Newman Construction, Inc. Sumter, SC	\$277,752.50	Yes	Yes	\$277,752.50	
Plowden Construction Co. Sumter, SC	\$283,025.00	Yes	Yes	\$283,025.00	
Palmetto Corporation of Conway Conway, SC	\$310,477.50	Yes	Yes	\$310,477.50	

**Notes:**  
 2% Local Preference Florence County Code, Section 11-62



December 4, 2008

Ms. Mazie P. Abraham  
Interim Procurement Director  
Florence County  
180 N. Irby Street, MSC-G  
Florence, SC 29501

RE: Storm Drainage Improvements within Wetlands  
B, J, and L at the Pee Dee Touchstone Energy ®  
Commerce City for Florence County, South  
Carolina  
Project No. 06162-21

Dear Ms. Abraham:

On December 2, 2008 at 2:00 P.M., Florence County received seventeen (17) bids from potential contractors for the Storm Drainage Improvements within Wetlands B, J, and L at the Pee Dee Touchstone Energy® Commerce City for Florence County, South Carolina. We have reviewed the bids and prepared the attached Bid Tabulation, Bid Comparison Sheet and Bid Opening Minutes for the referenced project for your consideration. Please note the following mathematical error was noted:

Shamrock Environmental Corporation of Browns Summit, North Carolina, erred in the amount of \$3,934.00 increasing their total bid amount from \$170,938.00 to \$174,872.00.

**This mathematical error, however, had no effect on the ranking of the bids.**

Also note that the bid received from L & B Developers, LLC of Lake City, South Carolina was deemed non-responsive due to the lack of required bid bond.

Based only on a review of the bids submitted and pending positive outcome of the review of the Contractor Qualifications, Alliance Consulting Engineers, Inc. recommends that the contract for the Storm Drainage Improvements within Wetlands B, J, and L at the Pee Dee Touchstone Energy® Commerce City for Florence County, South Carolina be awarded to the low bidder, Conder Construction Co., Inc. from Lugoff, South Carolina for the amount of \$96,488.25.

Ms. Mazie P. Abraham, Interim Procurement Director  
Florence County  
December 4, 2008 – Page 2 of 2

If Florence County is in agreement with the recommendation outlined above, please sign and date the Notice of Award also enclosed with this correspondence and return to our office at your earliest convenience.

We trust this information is to your satisfaction. If you have any questions or comments regarding the above information, please do not hesitate to contact either Mr. Mr. Christian C. Jones, E.I.T. or myself at (803) 779-2078.

Very truly yours,

ALLIANCE CONSULTING ENGINEERS, INC.



James W. Frost, II, P.E.  
Senior Project Manager

Enclosures

cc: Mr. Brian Kelley, Pee Dee Electric Cooperative, Inc.  
Mr. Deepal S. Eliatamby, P.E., Alliance Consulting Engineers, Inc.

# FLORENCE COUNTY COUNCIL MEETING

**DATE:** January 15, 2009

**AGENDA ITEM:** Reports To Council  
Paige Holsapple, Delinquent Tax Officer

**DEPARTMENT:** Treasurer's Office - Delinquent Tax Division

**ISSUE UNDER CONSIDERATION:** October 6, 2008 Tax Sale.

**CURRENT STATUS:** Information from the tax sale regarding total parcels sold and amount received.

**ATTACHMENTS:** Information from the October 6, 2008 Tax Sale.

  
Dean Fowler, Jr.  
Florence County Treasurer

Approved for inclusion in Agenda Package  
Richard Starks, County Administrator



Delinquent Tax Sale  
October 6, 2008

	<u>October 1, 2007</u>	<u>October 6, 2008</u>
Total Bids:	\$6,039,714	\$4,693,028
Properties Bid On:	634	703
◆ Delinquent taxes paid	\$ 367,851	\$ 391,495
◆ Current taxes paid	\$ 239,143	\$ 275,507
◆ Net overages	\$ 5,432,720	\$ 4,026,025
◆ Average bid	\$ 9,527	\$ 6,675
FLC Properties:		
◆ Delinquent taxes	\$ 45,089	\$ 61,174
◆ Current taxes	\$ 7,639	\$ 14,630
◆ Total land	13	4
◆ Total mobile homes	79	125

For Council's Information:

◆ Highest Bidder:	Ron Teague \$ 1,774,814	Ron Teague \$ 2,244,862
◆ Highest Bid:	Robert's Rentals LP MBP 90026-09-014 \$ 725,000	SFS LLC MBP 1015-01-002 \$ 165,000

# FLORENCE COUNTY COUNCIL MEETING

January 15, 2009

**AGENDA ITEM:** Other Business  
Infrastructure Fund  
Council Districts 1 and 2

**DEPARTMENT:** County Council

## **ISSUE UNDER CONSIDERATION:**

Approve The Expenditure Of Funds From Council Districts 1 And 2 Infrastructure Funding Allocations In An Amount Up To \$10,000.00 (\$5,000 From Each District) To The Three Rivers Historical Society To Provide Financial Assistance For Renovations And Restoration Projects At The Browntown Museum.

## **ATTACHMENTS:**

1. A copy of the Memorandum indicating the approval of Councilmen Smith and Ard.
2. A copy of the letter from the Three Rivers Historical Society requesting assistance.

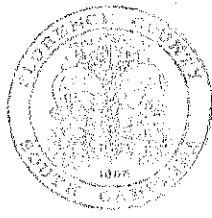

## FLORENCE COUNTY COUNCIL

### MEMO

To: Councilman K. G. Rusty Smith, Jr., District 1  
Councilman Ken Ard, District 2

From: Connie Y. Haselden, Clerk to Council

Cc: Richard A. Starks, County Administrator  
Suzanne S. King, Administrative Services Director  
Kevin V. Yokim, Finance Director  
Mazie Abraham, Interim Procurement Director  
Arthur C. Gregg, Public Works Director

Date: January 7, 2009

Re: Infrastructure funding

---

The Browntown Museum requests financial assistance to perform restoration work at the Museum. If you recommend this project and funding in an amount up to \$10,000.00 (\$5,000 from each district) to be paid from Council Districts 1 and 2 Infrastructure funding allocations, please indicate your approval by signing below.

(verbally approved – signature pending)  
Approved by K. G. Rusty, Smith, Jr.

(verbally approved – signature pending)  
Approved by Ken Ard

---

Date

---

Date

## *Three Rivers Historical Society*

*Nell G. Morris, Director  
Kathy Loyd, President  
414 N. Main Street  
Hemingway, SC 29554  
Phone (813) 558-2355*

---

*December 12, 2008*

*Dear Mr. Rusty Smith,*

*Greetings from Three Rivers Historical Society! We at the Society would like to thank you for your contribution to the area's community and thank you for your high quality standards and service.*

*We feel that history is the bridge that links the past with the present and that one can use that bridge to shape the future. We also feel that as a Historical Society we offer patrons of all ages, the materials and insight to the importance of preserving our individual heritages and family histories.*

*We would like you to know that much effort has been made in preserving The Browntown Museum. It is a unique part of the southern heritage of this area. Our goal is to continue to preserve this part of history for the future generations in hopes that they will learn about the past and appreciate the way of life we enjoy today.*

*As you know the cost for operating such projects is costly. At the present time we are in need of a new roof on our main building. The cost of such repair has been estimated at \$12,000. Recently we were able to acquire The Francis Marion Collection of Mr. James Vernon Epps. The Moore Memorial Museum which is owned by the First Presbyterian Church has been offered to us. In exchange we must absorb the moving expense, legal fees, and clearing of the lot that the building is currently on. Current bids on the expense of this project are \$30,000. We feel this would be a more affordable way to provide the building that we need and have contemplated building. If the Moore Memorial Museum building was moved to The Browntown Museum we would be able to move our library materials and family history research materials there and provide a research center. This would be a bonus for the Lake City Community as well as Florence County. I am sure that you know that our main office is now located in Hemingway, Williamsburg County.*

*We are in need of some funding to complete this project. We are asking for a "matching grant" from the county. We are able to provide at least half of the expense on these two projects. Of course any help would be accepted but our funds are limited.*

*On behalf of myself and the Society, I hope that you will help us become a continued successful part of the Florence Community. We look forward to your support.*

*Sincerely,*

*Nell G. Morris*

---

DIRECTOR OF THREE RIVERS HISTORICAL SOCIETY

*Kathy Loyd*

---

PRESIDENT OF THREE RIVERS HISTORICAL SOCIETY

# FLORENCE COUNTY COUNCIL MEETING

January 15, 2009

**AGENDA ITEM:** Other Business  
Infrastructure Fund  
Council District 1

**DEPARTMENT:** County Council

**ISSUE UNDER CONSIDERATION:**

Approve The Expenditure Of Funds From Council District 1 Infrastructure Funding Allocation In An Amount Up To \$10,000.00 To Provide Financial Assistance To The City Of Lake City For The Purchase Of An HVAC System For The City Of Lake City's Recreational Facility Located On Calhoun Street, Lake City.

**ATTACHMENTS:**

1. A copy of the Memorandum indicating the approval of Councilman Smith.
2. A copy of the request from the City of Lake City.



## FLORENCE COUNTY COUNCIL

### MEMO

To: Councilman K. G. Rusty Smith, Jr., District 1

From: Connie Y. Haselden, Clerk to Council

Cc: Richard A. Starks, County Administrator  
Suzanne S. King, Administrative Services Director  
Kevin V. Yokim, Finance Director  
Mazie Abraham, Interim Procurement Director  
Arthur C. Gregg, Public Works Director

Date: January 8, 2009

Re: Infrastructure funding

---

The City of Lake City requests financial assistance with the purchase of an HVAC system at the City of Lake City's Recreational Facility located on Calhoun Street. If you recommend this project and funding in an amount up to \$10,000.00 to be paid from Council District 1 Infrastructure funding allocations, please indicate your approval by signing below.

**(verbally approved – signature pending)**

Approved by K. G. Rusty, Smith, Jr.

---

Date

# CITY OF LAKE CITY

Lovith Anderson, Jr.  
Mayor

William J. Schnick  
Mayor Pro Tem

Marion C. Lowder  
City Administrator

John H. Whittleton, Sr., Esq.  
Assistant City Administrator

Cherline L. Wolf, CMC  
Clerk to Council



Members of Council

Billy H. Brown, Jr.

Sandra Fleming-Crosby

A. Russ Martin

Jason M. Springs

Gloria Tisdale

January 8, 2009

The Honorable K. G. "Rusty" Smith, Jr.  
Florence County Council  
P O Box 369  
Florence SC 29501

Dear Chairman Smith:

The City of Lake City is requesting assistance in the amount of \$10,000.00 for HVAC at the City of Lake City's Recreational Facility located on Calhoun Street.

Any assistance that can be provided would be greatly appreciated.

Sincerely

*Marion C. Lowder*  
Marion C. Lowder  
City Administrator

ew



# FLORENCE COUNTY COUNCIL MEETING

January 15, 2009

**AGENDA ITEM:** Other Business  
Road System Maintenance Fee (RSMF) Fund  
Council District 3

**DEPARTMENT:** County Council

**ISSUE UNDER CONSIDERATION:**

Approve The Expenditure Of Funds From Council District 3 RSMF Funding Allocation In An Amount Up To \$25,000.00 For 1½" Hot Laid Asphalt To Resurface Briarcliff Drive.

**ATTACHMENTS:**

1. A copy of the Memorandum indicating the approval of Councilman Bradley.



FLORENCE COUNTY  
Public Works Department

Arthur C. Gregg, Jr.  
Public Works Director

**To:** Al Bradley, Florence County Councilman  
**From:** Arthur C. Gregg, Jr., Public Works Director *ACG*  
**Date:** 1/7/2009  
**Re:** Estimate to Resurface Briarcliff Drive

---

Office estimate to resurface Briarcliff Drive with 1 ½" hot laid asphalt is \$25,000.00.

If you accept this project as stated above, please give your approval by signing below.

*Alphonse Bradley* Approval for resurfacing Briarcliff Drive

Payment to be made from the Funding source indicated below:

\_\_\_\_\_ Date

\$ 30 Resurfacing Fee

\_\_\_\_\_ Infrastructure Fund

\_\_\_\_\_ Utility Fund

Ltrs District 3

6746 Friendfield Road • Post Office Box 38 • Effingham, South Carolina 29541  
Phone: (843) 665-3022 • Fax: (843) 676-8625

# FLORENCE COUNTY COUNCIL MEETING

January 15, 2009

**AGENDA ITEM:** Other Business  
Road System Maintenance Fee (RSMF) Fund  
Council District 4

**DEPARTMENT:** County Council

**ISSUE UNDER CONSIDERATION:**

Approve The Additional Expenditure Of Funds From Council District 4 RSMF Funding Allocation In An Amount Up To \$11,027.56 For MBC Stone And Crushed Asphalt For Cubie Road *And* Correct The Scope Of The Project To Be From Stage Coach Road To The Top Of The Hill (Total Project Cost \$28,313.99).

**ATTACHMENTS:**

A copy of the Memorandum indicating the approval of Councilman Kirby.



FLORENCE COUNTY  
Public Works Department

Arthur C. Gregg, Jr.  
Public Works Director

**To:** Mitchell Kirby, Council Member, District #4  
**From:** Arthur C. Gregg, Jr., Public Works Director *ALG*  
**Date:** December 4, 2008  
**Re:** MBC Stone and Crushed Asphalt for a Portion of Cubie Road

The estimated cost for MBC stone and crushed asphalt for the portion of Cubie Road from Stage Coach Road to the top of the hill is \$28,313.99.

If you accept this project as stated above, please give your approval by signing below.

*[Signature]*  
MBC stone and crushed asphalt – Portion of Cubie Road (From Stage Coach Rd to top of hill)

Council Member

Payment to be made from the Funding source indicated below:

12-19-08 Date

\$ 30 Resurfacing Fee

Infrastructure Fund

ACG, JR./ig

# FLORENCE COUNTY COUNCIL MEETING

January 15, 2009

**AGENDA ITEM:** Other Business  
Road System Maintenance Fee (RSMF) Fund  
Council District 5

**DEPARTMENT:** County Council

**ISSUE UNDER CONSIDERATION:**

Approve The Expenditure Of Funds From Council District 5 RSMF Funding Allocation In An Amount Up To \$23,472.75 For MBC Stone And Crushed Asphalt For A Portion Of Delosh Road.

**ATTACHMENTS:**

1. A copy of the Memorandum indicating the approval of Councilman Rodgers.

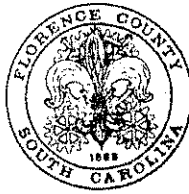

FLORENCE COUNTY  
Public Works Department

Arthur C. Gregg, Jr.  
Public Works Director

**To:** Johnnie Rodgers, Member, Florence County Council  
**From:** Arthur C. Gregg, Jr., Public Works Director  
**Date:** 1/7/2009  
**Re:** Estimated Cost for MBC Stone- Crushed Asphalt for Portion of Delosh Road

---

Estimated cost for MBC stone and crushed asphalt for a portion of Delosh Road is \$23,472.75.

If you accept this project as stated above, please give your approval by signing below.

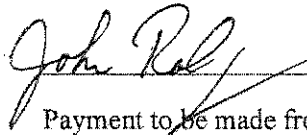
 Approval for the above listed project  
Payment to be made from the Funding source indicated below:

1-7-09 Date \_\_\_\_\_ \$30 RSMF Fee

Infrastructure Fund

# FLORENCE COUNTY COUNCIL MEETING

January 15, 2009

**AGENDA ITEM:** Other Business  
Utility System Fund  
Council District 7

**DEPARTMENT:** County Council

**ISSUE UNDER CONSIDERATION:**

Approve The Expenditure Of Funds From Council District 7 Utility System Funding Allocation In An Amount Up To \$54,108.00 For Additional Pipe To Extend The Contract For Wilson Road Sidewalk Project (TV Road To Oakland Avenue).

**ATTACHMENTS:**

1. A copy of the Memorandum indicating the approval of Councilman Mumford.



FLORENCE COUNTY  
Public Works Department

Arthur C. Gregg, Jr.  
Public Works Director

**To:** Waymon Mumford, Councilman, District #7  
**From:** Arthur C. Gregg, Jr., Public Works Director  
**Date:** January 6, 2009  
**Re:** Estimate for Additional Pipe for Wilson Road Sidewalk Project

---

The estimated cost for additional pipe to extend the contract for Wilson Road Sidewalk Project (T. V. Road to Oakland Avenue) is \$54,108.00.

If you accept this project as stated above, please give your approval by signing below.

**VERBALLY APPROVED SIGNATURE** Approval for additional pipe for Wilson Road  
**PENDING** Sidewalk Project

Payment to be made from the Funding source indicated below:

\_\_\_\_\_ Date

\_\_\_\_\_ \$30 Resurfacing Fee

\_\_\_\_\_ Infrastructure Fund

\_\_\_\_\_ **Utility System Fund**

ACG,Jr./ig